

HIGHWAY COMMITTEE MINUTES

April 9, 2013

The Manitowoc County Highway Committee convened into an *open* session at the UW-Manitowoc Founder's Hall Room F232, 705 Viebahn Street, Manitowoc, WI being the 9th day of April 2013.

Chair Rick Gerroll called the meeting to order at 5:30 p.m.

Roll Call: Present Chair Gerroll, Supervisors Behnke, Bauknecht, Vogt, and Dufek.

Excused: None

Also Present Commissioner Gary Kennedy, County Executive, Bob Ziegelbauer, Comptroller, Tod Reckelberg, Corporation Counsel, Steve Rollins, County Clerk, Jamie Aulik, Supervisor Chuck Hoffmann, Supervisor Jim Brey, John Kropp, Charlie Matthews, HTR News, and Administrative Assistant, Mary Koch.

Approval of Minutes Supervisor Bauknecht made a motion, seconded by Supervisor Behnke to approve the minutes from the March 19, 2013 meeting. Motion carried.

Public Input None

Reconstruction of Airport Advisory Committee

Commissioner Kennedy informed the committee that Airport Advisory Committee met on Monday, April 1st. Reconstruction of the committee and attendance at monthly meetings was discussed. It was decided that Airport Advisory Committee will meet every other month commencing in June. It was also decided that any committee member missing more than 2 meetings per year, will no longer be a committee member. Highway Committee discussed these changes. It was agreed that one member will be contacted regarding attendance and further agrees with the change in meeting schedule and the attendance revision.

Bridge Replacement on CTH "R" in Rapids

Commissioner Kennedy introduced Mark Schuster, P.E. from Robert E. Lee & Associates, Inc. Mark is the project manager for this feasibility study completed for the bridge replacement on CTH "R". Mark Schuster presented a power point presentation to the committee indicating that the existing bridge sufficiency rating is 17. A rating of 100 is a brand new bridge and a rating below 50 is eligible for replacement. The bridge sufficiency rating deteriorated from 68 to 38 to 17 over the past few years. Mark presented the following: Existing Geometry of CTH R, Traffic Volumes Growing, WisDOT's Urban Road Criteria, Independent Traffic Study, Crash (Accident) History, which is twice the state-wide average, Crash Concern Area South of Broadway Street, Six Alternatives Considered for Two-Lane and Four-Lane Bridge Construction, Construction Cost Estimates for Each of the Four Alternatives using Asphalt Paved Street and Concrete. Commissioner Kennedy informed the committee that in order to extend the life of the bridge another 2-3 years, weight limit restrictions will be posted for the bridge. In order to meet the deadline for filing for funding, the Highway Committee needs to make a decision by the end of May. If funding is granted it would be 60% federal funding, 20% state funding and 20% county funded for the bridge. County Executive, Bob Ziegelbauer, wants to see the cost for a two-lane option with shared use path before the May 14th meeting. Discussion held by the committee.

Summer Road School – June 3, 4th, and 5th

Attendance by committee members was discussed. Supervisors Behnke and Vogt will be attending the Summer Road School.

Air Show Permit

The Air Show Permit was amended from the March meeting by Corporation Counsel Rollins to change the amount of liability insurance Manitowoc Aviation Resources, Inc. (MARI) is required to carry. Motion made by Supervisor Behnke, seconded by Supervisor Vogt to approve the Air Show Permit as amended. Motion carried.

NE Region Commissioner & Committee Members Meeting

The committee was given the agenda for the NE Region Commissioner & Committee Member meeting held in Green Bay on May 2nd. Anyone wishing to attend should notify Commissioner Kennedy.

2013 Budget & Overtime Reports

The commissioner reviewed the budgets with the committee. As mentioned last month the winter budget for snow removal is gone. Overtime is in check. Final numbers will be presented at the May meeting.

Vouchers

The committee approved the vouchers from 3-18-13 to 4-5-13. Motion made by Supervisor Bauknecht, seconded by Supervisor Dufek, to approve the vouchers. Motion carried.

Next Meeting Date

The next meeting will be held on May 14, 2013, at Manitowoc County Highway Department, 3500 STH 310, Manitowoc, WI at 4:30 p.m.

Adjournment

Motion made by Supervisor Bauknecht, seconded by Supervisor Dufek to adjourn at 6:40 pm. Motion carried.

Submitted by:
Mary L. Koch,
Administrative Assistant

HIGHWAY COMMITTEE MINUTES

May 14, 2013

The Manitowoc County Highway Committee convened into an *open* session at the Manitowoc County Highway Department, 3500 State Highway 310, Manitowoc, WI being the 14th day of May, 2013.

Chair Rick Gerroll called the meeting to order at 4:30 p.m.

Roll Call: Present Chair Gerroll, Supervisors Behnke, Bauknecht, Vogt, and Dufek.

Excused: None

Also Present Commissioner Gary Kennedy, Road Superintendent Brian Glaeser, Shop Superintendent Wayne Sleger, John Kropp, SMI, Mark Schuster, Robert E. Lee, Bob Ziegelbauer, County Executive, WisDOT Representatives, Will Dorsey, Brian Brock, Colleen Harris, Kurt Wranovsky, Becky Rooyakkers, County Board Chair Paul "Biff" Hansen, Supervisors, Susie Maresh, Don Weiss, David Korinek, Jim Brey, Todd Holschbach, and Mary Koch, Administrative Asst.

Approval of Minutes Supervisor Vogt made a motion, seconded by Supervisor Bauknecht to accept the minutes from the April 9, 2013 meeting. Motion carried.

Public Input None

WisDOT 6-Year Plan Update

Representatives from the WisDOT addressed the committee and presented the Wisconsin Six Year Highway Improvement Plan. Becky Rooyakkers from the WisDOT handed out a listing showing a snapshot of the projected improvements from 2013 to 2019. Projects for 2013 will be (Village of Reedsville - CTH "W" - East Village Limits) Resurfacing USH 10 in Reedsville, overlay the deck & paint the steel girders; (Branch River Bridge & Approaches) Replace existing structure with new bridge built to current design standards & reconstruct approaches, and (Manitowoc to Green Bay, STH 147 Interchange Ramp) Reconstruct to widen the radii of the I-43 ramps intersections with STH 147. She reported that the 17th Street Bridge project in Two Rivers was going well and should open on time. Commissioner Kennedy thanked the WisDOT for their continued support and the presentation.

Bridge Replacement on CTH "R" in Rapids

Commissioner Kennedy introduced Mark Schuster, P.E. from Robert E. Lee & Associates, Inc. Mark is the project manager for the feasibility study for the bridge replacement on CTH "R". Mark Schuster gave a presentation indicating that the existing bridge sufficiency rating is 17. A rating of 100 is a brand new bridge and a rating below 50 is eligible for replacement. The bridge sufficiency rating deteriorated from 68 to 38 to 17 over the past few years. Commissioner Kennedy informed the committee that in order to extend the life of the bridge another 2-3 years, weight limit restrictions will be posted for the bridge. Mark presented 4 scenarios to reconstruct the bridge and roadway on CTH "R". The scenarios indicated the estimated construction costs, minus 80% federal bridge funding and the total cost to Manitowoc County. Commissioner Kennedy met with the WisDOT last week in regard to possible funding of 80% for a 4-lane road. He will submit the application for this funding as well. Applications for the bridge funding must be submitted by May 24, 2013. Discussion held by the committee and attending members of the County Board. Each committee member voiced their views and recommendations. Supervisor Behnke suggested an immediate Jurisdictional Transfer of this bridge and roadway to the City of Manitowoc as soon as reconstruction is completed and to enter into the agreement as soon as possible. Commissioner Kennedy will schedule a meeting with the Infrastructure Committee for the city and propose the Jurisdictional Transfer Agreement. Motion made by Supervisor Bauknecht, seconded by Supervisor Dufek recommending the reconstruction of the bridge and roadway on CTH "R" (Rapids Road) as a 4-Lane Facility with Shared Use Path and to enter into a Jurisdictional Transfer Agreement with the City of Manitowoc for this bridge and roadway as soon as possible. Motion carried unanimously.

Quit Claim Deed for Parcel on STH "42"

John Kropp from SMI informed the committee that this parcel is Highway Right-of-Way which has been held in trust by Manitowoc County for the State of Wisconsin since 1938. The WisDOT has been contacted by an adjacent land owner to purchase this parcel for driveway purposes. In order to transfer this parcel to the State of Wisconsin, a Quit Claim Deed is necessary to complete the transfer to the State so the state can move forward. Motion made by Supervisor Dufek, seconded by Supervisor Bauknecht to Quit Claim this parcel of land to the State of Wisconsin. Motion carried.

Quit Claim Deed for Parcel on STH 32/57 (Millhome)

John Kropp from SMI, informed the committee that these two parcels, deemed excess right of way by WisDOT, has been held in trust by Manitowoc County for the State of Wisconsin since 1956. The WisDOT has been contacted by an adjacent land owner interested in purchasing these parcels. In order to transfer these parcels to the State of Wisconsin, a Quit Claim Deed is necessary to complete the transfer to the State so the state can move forward. Motion made by Supervisor Behnke, seconded by Supervisor Vogt to Quit Claim these parcels of land to the State of Wisconsin. Motion carried.

FAA Agreement

Commissioner Kennedy advised the committee that this agenda item needs to be postponed. Motion made by Supervisor Vogt, seconded by Supervisor Behnke to postpone this matter at this time. Motion carried.

Rubber Tire Excavator Bids

Shop Superintendent, Wayne Sleger, explained the necessity to replace the Rubber Tire Excavator. It is a piece of equipment used daily at the Highway Department. Bids went out with Aring Equipment and FABCO Cat submitting bids according to the specifications. Demos of both machines were presented to Wayne. Wayne also took a poll by other counties and VOLVO is the machine most used. It is Wayne's recommendation to accept the low bid from Aring Equipment for the VOLVO in the amount of \$161,920.00. Motion made by Supervisor Dufek, seconded by Supervisor Behnke to accept the low bid from Aring Equipment Company for the purchase of a VOLVO Rubber Tire Excavator. Motion carried.

Tri Axle Truck Cab & Chassis Bids

Shop Superintendent, Wayne Sleger, advised that bids went out to replace one of our vintage trucks in the fleet. Bids were taken for a Tri Axle Truck Cab and Chassis. Bids came in from 6 companies according to the specs presented. Quality Truck was low bidder in the amount of \$102,947.00 and Wayne recommends the low bid from Quality Truck. Motion made by Supervisor Behnke, seconded by Supervisor Dufek to accept the low bid from Quality Truck in the amount of \$102,947.00. Motion carried.

2013 Budget & Overtime Reports

The Commissioner advised that there is no overtime at this time of the year and no changes to the budget.

Vouchers

The committee approved the vouchers from 4-8-13 to 5-10-13. Motion made by Supervisor Bauknecht, seconded by Supervisor Vogt, to approve the vouchers. Motion carried.

Next Meeting Date

The next meeting will be held on July 9, 2013, at Manitowoc County Highway Department, 3500 STH 310, Manitowoc, WI at 4:30 p.m.

Adjournment

Motion made by Supervisor Bauknecht, seconded by Supervisor Vogt, to adjourn at 5:50 p.m. Motion carried.

Submitted by:

Mary Koch, Administrative Asst.



**MANITOWOC COUNTY
HIGHWAY COMMITTEE
MEETING NOTICE**

DATE: July 9, 2013
TIME: 4:30 p.m.
PLACE: Manitowoc County Highway Department
3500 STH 310
Manitowoc, WI 54220

The meeting is open to the public, but portions of the meeting may be closed if this notice indicates that the Committee may convene in closed session. The following matters may be considered at the meeting:

1. Regular Business. (Call to order, previous minutes, vouchers, etc.)

(Public Input)

Specific subject matters upon which discussion or action is anticipated

2. Storage of Windmill Towers on County (Kunz) Property
3. Mining Lease Proposal for the County (Kunz) Property
4. Jurisdictional Transfer for CTH "R" in Rapids
5. Airport Advisory Committee Member
6. Tri-Axle Truck Body & Hydraulic Bids
7. Jurisdictional Transfer for CTH "LS"
8. 2013 – 2015 State Budget
9. 2013 Budget & Overtime Reports
10. Vouchers
11. Next Meeting Date

Dated: June 27, 2013

Rick Gerroll, Committee Chairman
By: Gary L. Kennedy, Highway Commissioner

Any person wishing to attend the meeting who requires special accommodation because of a disability should contact the County Clerk's office at 920-683-4003 at least 24 hours before the meeting begins so that appropriate accommodations can be made.

Persons who are members of another governmental body, but who are not members of this committee, may attend this meeting. Their attendance could result in a quorum of another governmental body being present. Such a quorum is unintended and they are not meeting to exercise the authority, duties, or responsibilities of any other governmental body.

R E S O L U T I O N

WHEREAS, the Manitowoc County Highway Committee held a meeting on April 9, 2013 to discuss the C.T.H. "R" (Rapids Road) Corridor Study and;

WHEREAS, the County's Consultant, Robert E. Lee, presented the results of their C.T.H. "R" (Rapids Road) Corridor Study to the Highway Committee;

WHEREAS, the City of Manitowoc's Common Council would like to recommend to the Manitowoc County Highway Committee and the Manitowoc County Board that the reconstruction of C.T.H. "R" (Rapids Road) from Custer Street to Broadway Street shall include a 4-lane roadway, a 4-Lane Bridge and a shared use path for bikes and pedestrians on the east side of Rapids Road;

NOW THEREFORE BE IT RESOLVED BY THE MAYOR AND COMMON COUNCIL OF THE CITY OF MANITOWOC that the City is officially endorsing and recommending the Manitowoc County Board and Highway Committee to reconstruct the C.T.H. "R" (Rapids Road) roadway and bridge with a 4-Lane facility and a shared use path for bikes and pedestrians on the east side of Rapids Road.

BE IT FURTHER RESOLVED, that the City Clerk sends a copy of this signed document to the Manitowoc County Board of Supervisors Chairperson, Paul "Biff" Hansen.

Introduced _____

Adopted _____

Approved _____

Justin M. Nickels, Mayor

Public Hearing
7-15-13

1	2	3	4	5	6	7	8	9	10

368

RESOLUTION

WHEREAS, Rapids Road (CTH "92"), from Broadway Street to Custer Street, partially located within the City Limits, has major infrastructure improvements planned over the next several years, and;

WHEREAS, per the Wisconsin Department of Transportation, the said street for a length of 1.00 miles shall remain under the jurisdiction of Manitowoc County, since portions of the project are not within the City Limits;

WHEREAS, upon acceptance of the completed project (projected to be 2016), the City of Manitowoc shall assume responsibility for all maintenance on Rapids Road from Broadway to Custer Street, to include but not limited to: street sweeping, snow plowing/salting, road repairs, etc., and;

WHEREAS, Manitowoc County shall agree to pay the City of Manitowoc on a yearly basis for these maintenance duties based on the State of Wisconsin's General Transportation Aids (GTA) commensurate to that year, and;

WHEREAS, Manitowoc County shall continue to pay the City of Manitowoc until such time that all properties are located in city limits or the Wisconsin Department of Transportation grants the City of Manitowoc the jurisdictional transfer of the roadway.

THEREFORE BE IT RESOLVED BY THE MAYOR AND COMMON COUNCIL OF THE CITY OF MANTOWOC to instruct the Director of Public Infrastructure to calculate the yearly GTA payment and bill the County accordingly until such time that the City of Manitowoc takes over jurisdiction for this segment of Rapids Road.

Introduced JUL 15 2013 [Signature]

Adopted JUL 15 2013 _____

Approved 7/16/13
[Signature]
Justin M. Niekels, Mayor

This resolution was drafted by
Gregory J. Mitchell, P.E., Engineering Team Leader
As requested by the Public Infrastructure Committee
DMM/ghm
7/16/13
7300 Lakeshore Blvd - Broadway to Custer St. Regional Jurisdictional Transfer Aids

**RESOLUTION AUTHORIZING JURISDICTIONAL TRANSFER
(County Trunk Highway R in the City of Manitowoc)**

TO THE MANITOWOC COUNTY BOARD OF SUPERVISORS:

1 WHEREAS, Manitowoc County has jurisdictional control over the entire 1-mile portion of
2 County Trunk Highway R in the City of Manitowoc that is located between Broadway Street and
3 Custer Street; and
4

5 WHEREAS, the County is planning major infrastructure improvements over the next several
6 years to that portion of CTH R and is planning to transfer jurisdictional control over that portion of
7 CTH R from the county to the city when the project is completed in 2018; and
8

9 WHEREAS, the Wisconsin Department of Transportation requires that portion of CTH R
10 remain under the county's jurisdiction because the roadway is not entirely within the city limits; and
11

12 WHEREAS, the city will assume responsibility for all maintenance on CTH R from Broadway
13 Street to Custer Street, including, but not limited to, road repairs, salting, snow plowing, and street
14 sweeping, upon acceptance of the completed project; and
15

16 WHEREAS, the county agrees to pay the city on a yearly basis for maintenance duties based
17 on the State's General Transportation Aids (GTA) for the then current year and will continue to pay
18 the city for those duties until such time as that portion of the CTH R is entirely located in city limits
19 or the Wisconsin Department of Transportation transfers jurisdiction of that portion of CTH R to the
20 City;
21

22 NOW, THEREFORE, BE IT RESOLVED that the Manitowoc County Board of Supervisors
23 authorizes the County Board Chair and the County Clerk to enter into a Jurisdictional Transfer
24 Agreement with the City of Manitowoc.

Dated this 23rd day of September 2014.

Respectfully submitted by the
Highway Committee

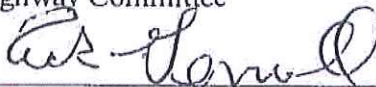
Rick Gerroll, Chair

FISCAL IMPACT: No tax levy impact, but transfers a portion of State General Transportation Aids to the city.

FISCAL NOTE: Reviewed and approved by Comptroller. 

LEGAL NOTE: Reviewed and approved as to form by Corporation Counsel SR

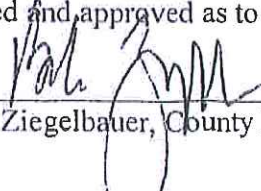
APPROVED: 
Bob Ziegelbauer, County Executive

9/24/14
Date

No. 2014/2015 - 38
 Manitowoc Voting System
 Vote Summary Report
 09-23-2014

All Reports
 Report , 2 , 1/2 Majority Based on Attendance

2. Resolution Authorizing Jurisdictional Transfer for County Trunk "R" in the City of Manitowoc.

Seat	Dist	Attnd	Name	Aye	Nay	Abs
1	20		Hoffman, Chuck	[]	[]	[]
2	11	*	Vogel, Randy S.	[X]	[]	[]
3	15	*	Wagner, Catherine	[X]	[]	[]
4	24	*	Weiss, Don	[X]	[]	[]
5	6	*	Hansen, Paul Biff	[X]	[]	[]
6	10		Zimmer, Don	[]	[]	[]
7	14	*	Baumann, James	[X]	[]	[]
8	8	*	Williams, Mike	[X]	[]	[]
9	3	*	Metzger, Rita	[X]	[]	[]
10	1	*	Holschbach, Todd	[X]	[]	[]
11	16	*	Cavanaugh, Robert	[X]	[]	[]
12	7	*	Vogt, Norbert	[X]	[]	[]
13	5	*	Dufek, Gregory	[X]	[]	[]
14	13		Waack, Melvin	[]	[]	[]
15	22	*	Dyzak, David	[X]	[]	[]
16	18	*	Kohlman, Pat	[X]	[]	[]
17	17	*	Maresh, Susie	[X]	[]	[]
18	12	*	Behnke, Kevin	[X]	[]	[]
19	21	*	Gerroll, Rick	[X]	[]	[]
20	9	*	Kopecky, Mark	[X]	[]	[]
21	23	*	Henrickson, Rick	[X]	[]	[]
22	19	*	Falkowski, James J.	[X]	[]	[]
23	25	*	Burke, Laurie	[X]	[]	[]
24	2	*	Nickels, Dave	[X]	[]	[]
30	4	Chair	Brey, Jim	[X]	[]	[]

Pass

On this 23 day of September 2014 by a vote of:
 Aye = 22 Nay = 0 Abs = 0 Absent = 3

Attest:

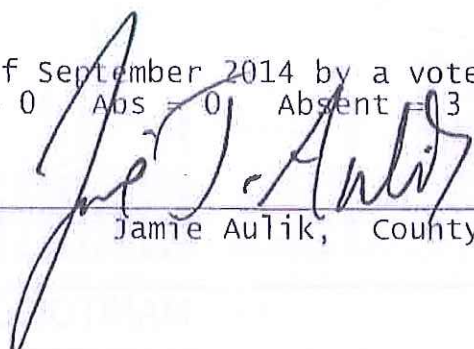

Jamie Aulik, County Clerk

MANITOWOC COUNTY HIGHWAY DEPARTMENT

PLAN OF PROPOSED IMPROVEMENT

CTH R (S. RAPIDS ROAD) RECONSTRUCTION

CUSTER STREET TO MANITOWOC RIVER

MANITOWOC COUNTY

STATE PROJECT NUMBER
1489-18-01

ORDER OF SHEETS

- | Section No. | Title |
|-------------|------------------------------|
| 1 | Typical Sections and Details |
| 2 | Estimate of Quantities |
| 3 | Miscellaneous Quantities |
| 4 | Plan of Way Plat |
| 5 | Plan and Profile |
| 6 | Standard Detail Drawings |
| 7 | Sign Plans |
| 8 | Structure Plans |
| 9 | Computer Earthwork Data |
| 9 | Cross Sections |

TOTAL SHEETS *

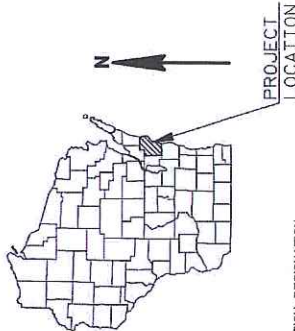

- DESIGN DESIGNATION**
- = A.A.D.T.
 - = A.A.D.T.
 - = D.A.V.
 - = T.O.
 - = DESIGN SPEED
 - = ESALS

CONVENTIONAL SYMBOLS

- | | |
|--|--|
| <p>PLAN</p> <ul style="list-style-type: none"> --- CORPORATE LIMITS --- PROPERTY LINE --- LOT LINE --- LIMITED HIGHWAY EASEMENT --- EXISTING RIGHT OF WAY --- PROPOSED OR NEW R/W LINE --- SLOPE INTERCEPT --- REFERENCE LINE --- EXISTING CULVERT --- PROPOSED CULVERT (Box or Pipe) --- COMBUSTIBLE FLUIDS --- MARSH AREA --- WOODED OR SHRUB AREA | <p>PROFILE</p> <ul style="list-style-type: none"> --- ORIGINAL GROUND --- MARSH OR ROCK PROFILE (To be noted as such) --- SPECIAL DITCH --- GRADE ELEVATION --- CULVERT (Profile View) --- UTILITIES --- ELECTRIC --- OVERHEAD UTILITY --- FIBER OPTIC --- GAS --- SANITARY SEWER --- STORM SEWER --- TELEPHONE --- WATER --- UTILITY PEDestal --- POWER POLE --- TELEPHONE POLE |
|--|--|

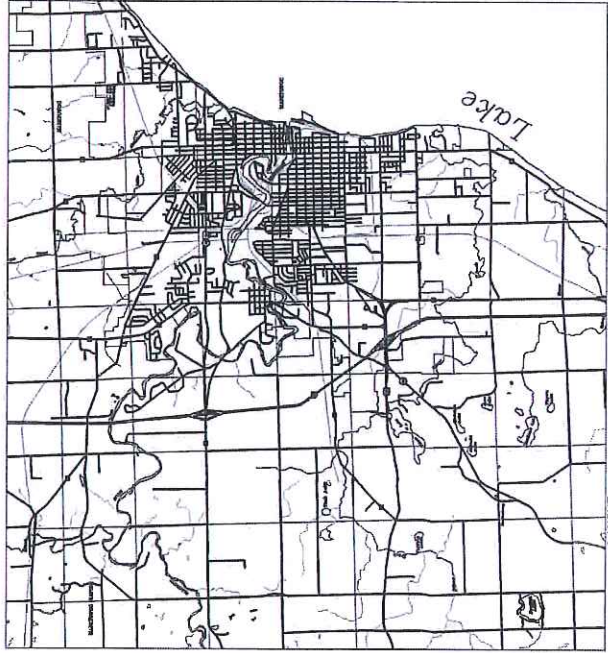

HORIZONTAL DATUMS SHOWN ON THIS PLAN ARE WISCONSIN COUNTY COORDINATES COUNTY CORNER NEAR CENTERLINE. HORIZONTAL DISTANCES, GRID BEARINGS, AND GRID DISTANCES, GRID DISTANCES MAY BE USED AS GROUND DISTANCES.

FILE NAME : R:\1400\1489\1489-18-01-11.DWG
LAYOUT NAME : ***

PLOT DATE : 1/7/2016 9:20 AM
PLOT BY : ROCHELLE L. BURSA
PLOT NAME :

ORIGINAL PLANS PREPARED BY:

Robert E. Lee & Associates, Inc.
ENGINEERING, SURVEYING, ENVIRONMENTAL SERVICES
1520 CHESTER AVENUE, SUITE 200
MANITOWOC, WISCONSIN 54220
OPERATING 40 Years of Excellence

(Signature) _____ (Date) _____

MANITOWOC COUNTY
HIGHWAY DEPARTMENT
3500 STATE HIGHWAY 300
MANITOWOC, WI 54220
920-683-4353



APPROVED FOR MANITOWOC COUNTY HIGHWAY DEPARTMENT
DATE: _____
MARC HOLSEN

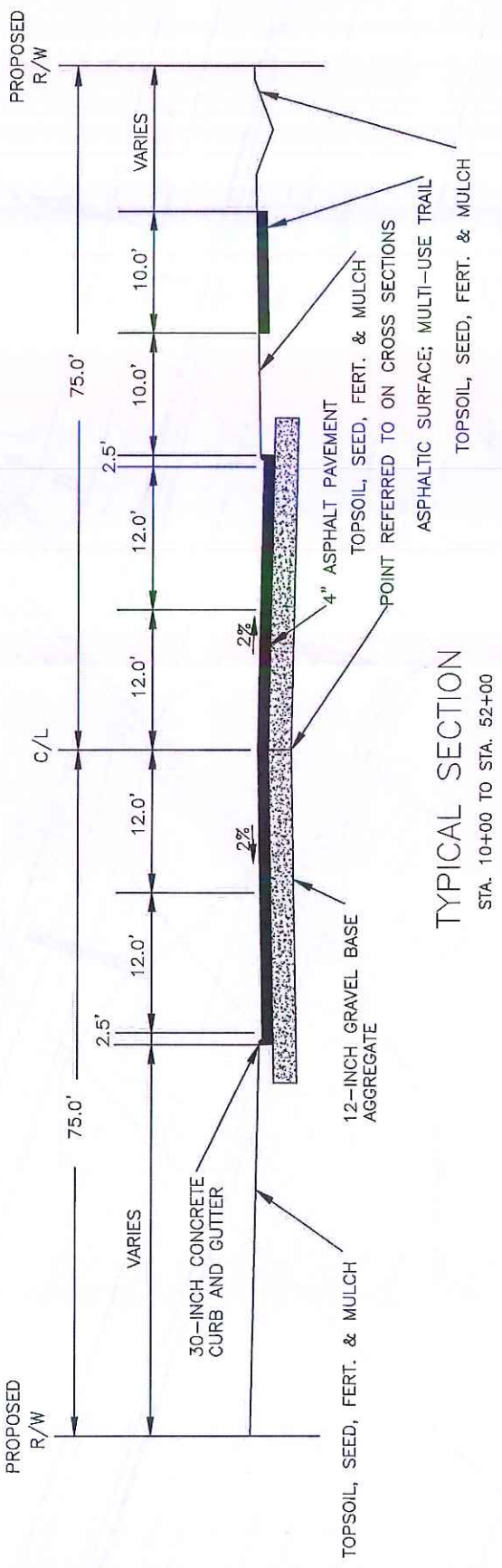

TYPICAL SECTION
STA. 10+00 TO STA. 52+00

PROJECT NO: 1489-1B-01	HWY: CTH 'R'	COUNTY: MANITOWOC	TYPICAL SECTION	SHEET
FILE NAME: R:\1400\1489\1489005\DWG\PTW_MAP.DWG			PLLOT BY: ROCHELLE L. BURSA	WISDOT/CADDIS SHEET 42
			PLLOT DATE: 7/8/2016 9:28 AM	
			PLLOT SCALE: *****	
			PLLOT NAME:	

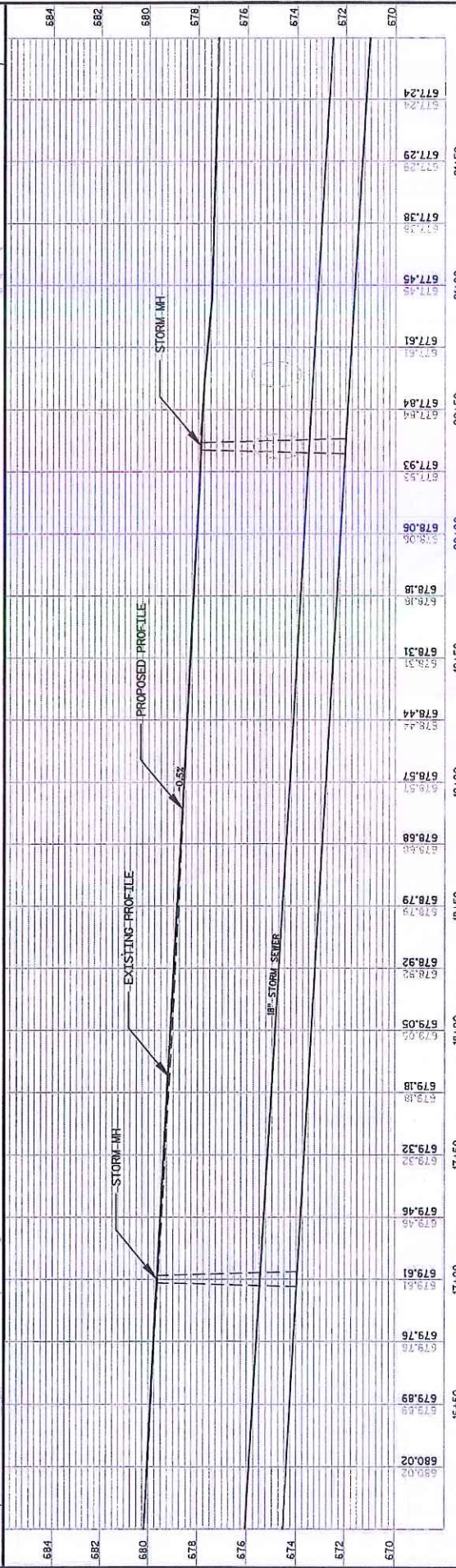
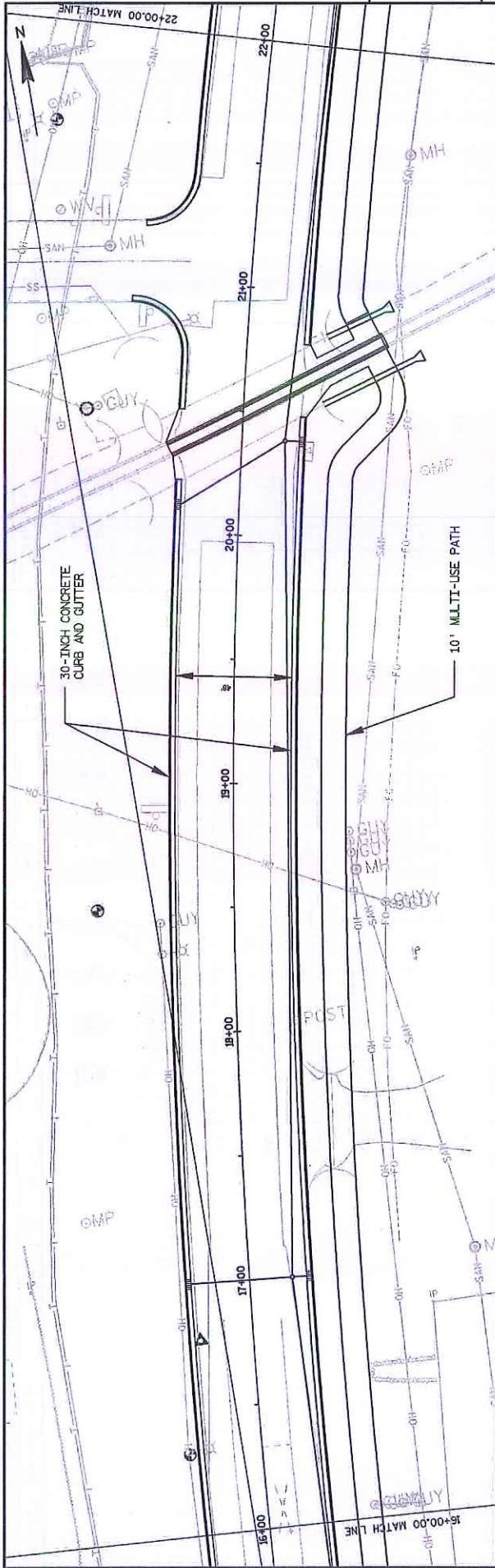

STATION	ELEVATION
15+00	680.02
15+50	679.89
16+00	679.76
16+50	679.61
17+00	679.46
17+50	679.32
18+00	679.18
18+50	678.92
19+00	678.57
19+50	678.31
20+00	678.06
20+50	677.84
21+00	677.61
21+50	677.45
22+00	677.38
22+50	677.29
23+00	677.24

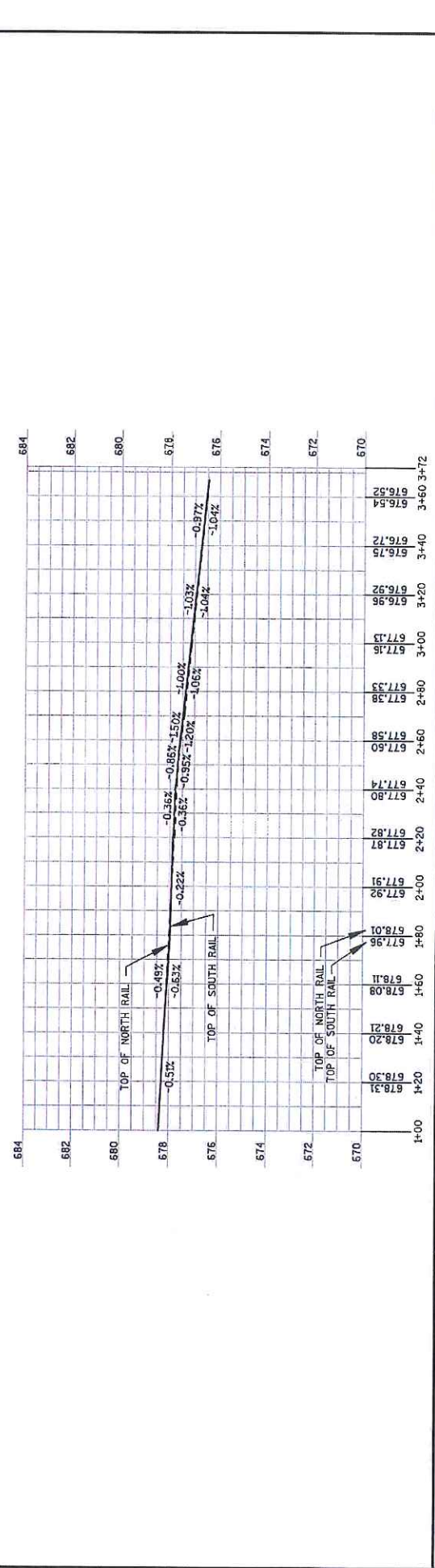
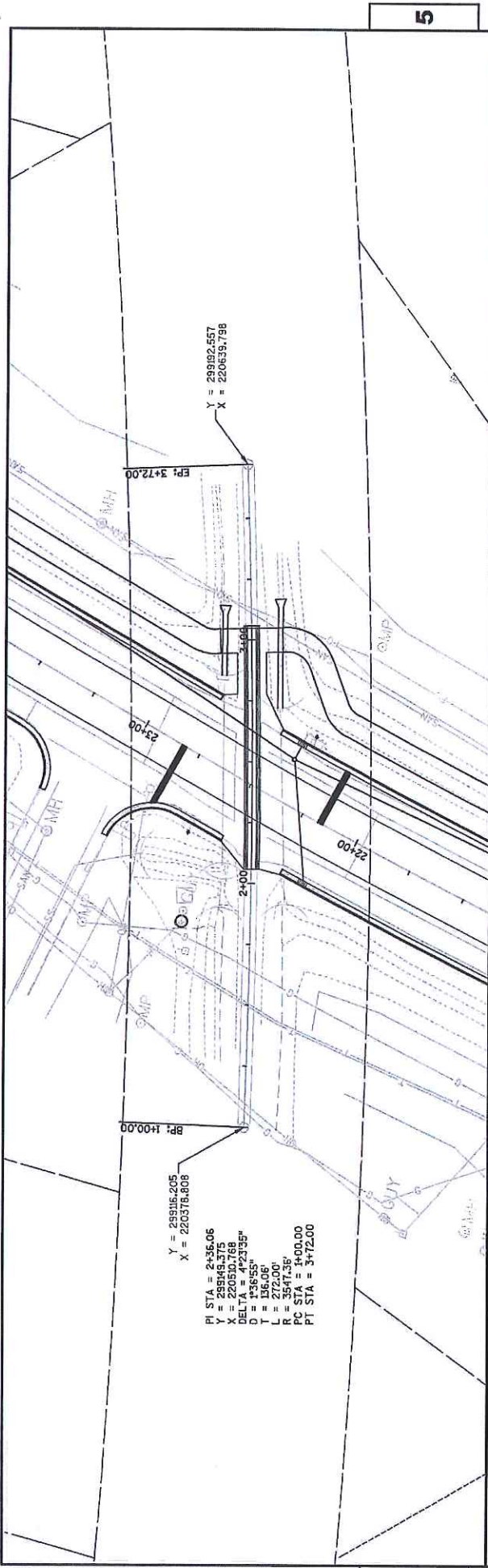

13B1: Pavement Details for Railroad Approach

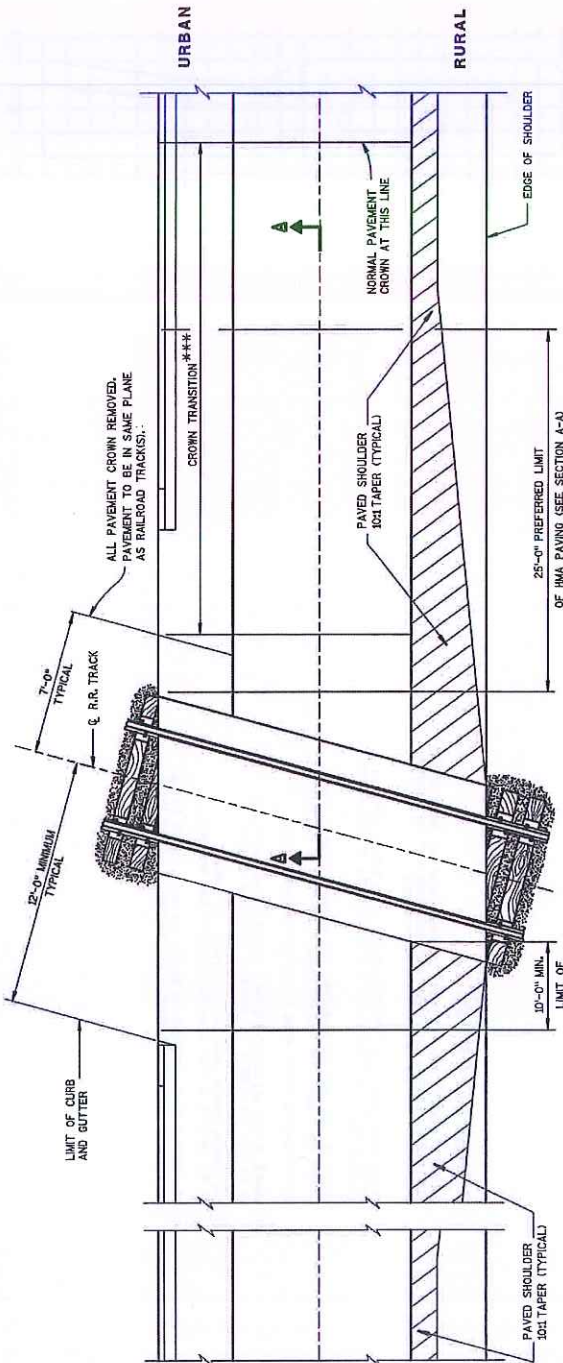

GENERAL NOTES

- DETAILS OF CONSTRUCTION MATERIALS AND WORKMANSHIP NOT SHOWN ON THIS DRAWING SHALL CONFORM TO THE PERTINENT REQUIREMENTS OF THE STANDARD SPECIFICATIONS AND THE APPLICABLE SPECIAL PROVISIONS.
- TIMBER, CONCRETE OR RUBBER CROSSING SURFACE MATERIAL, RAILS, TIES, BALLAST, GEOTEXTILE FABRIC AND CROSSING DRAINAGE SYSTEM BY OTHERS UNLESS OTHERWISE PROVIDED.
- HMA PAVEMENT APPROACHES AND HMA PAVEMENT CROSSING SURFACES TO BE PLACED BY CONTRACTOR UNLESS OTHERWISE PROVIDED.
- HMA FLANGEWAY AND FIELD FILLERS TO BE PLACED AND COMPACTED BY OTHERS UNLESS OTHERWISE PROVIDED.
- HMA FILLERS NOT REQUIRED WHEN RUBBER FILLERS ARE PROVIDED.
- HMA PAVEMENT SHALL BE ROLLED PARALLEL TO THE TRACK.
- ** CROSSING SURFACE MAY BE TIMBER, RUBBER, CONCRETE, HMA PAVEMENT OR A COMBINATION OF SUCH MATERIALS.
- *** CROWN TRANSITION LENGTH SHOWN ELSEWHERE IN THE PLAN.

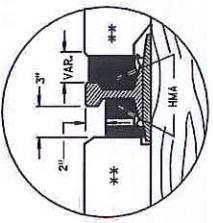

DETAIL B
HMA FLANGEWAY
AND FIELD FILLERS

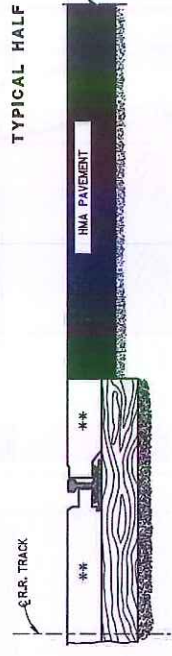
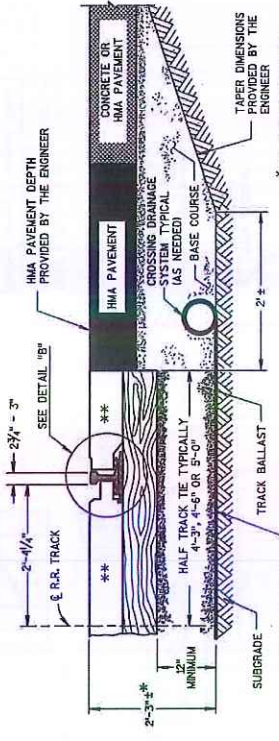

SECTION A-A
CONCRETE PAVEMENT APPROACH

SECTION A-A
HMA PAVEMENT APPROACH

EXAMPLES OF PAVEMENT APPROACHES

PAVEMENT DETAILS FOR RAILROAD APPROACH	
STATE OF WISCONSIN	DEPARTMENT OF TRANSPORTATION
APPROVED	DATE
/S/ Ronald E. Adams	8-28-09
CHIEF, RAILROADS & HARBORS SECTION	
FHWA	

15C9 sheet a: Signing and Pavement Marking Details for Railroad - Highway Grade Crossings

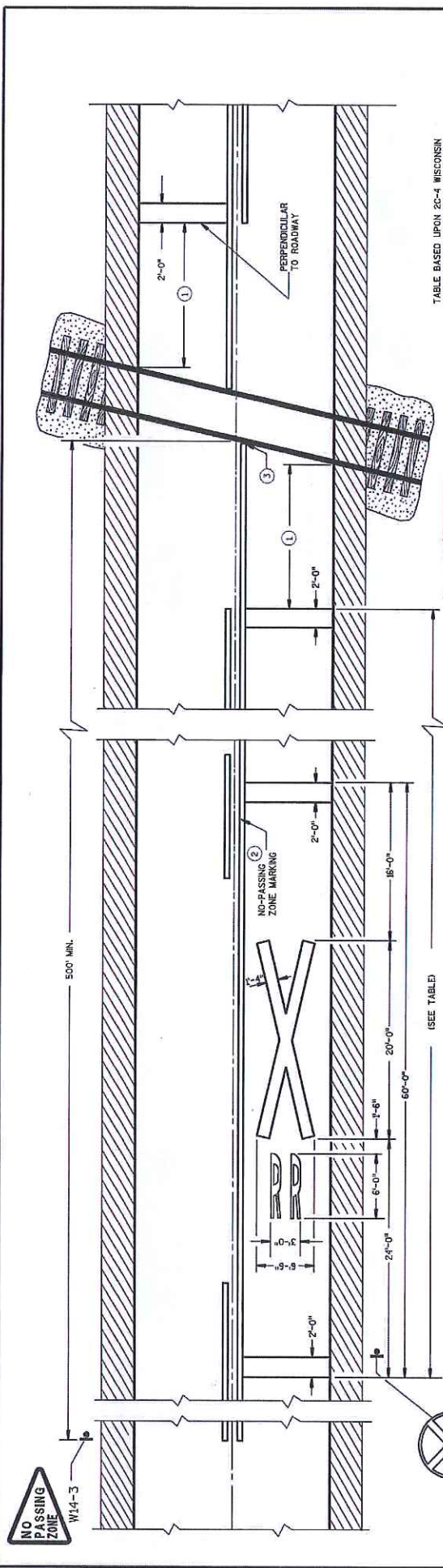
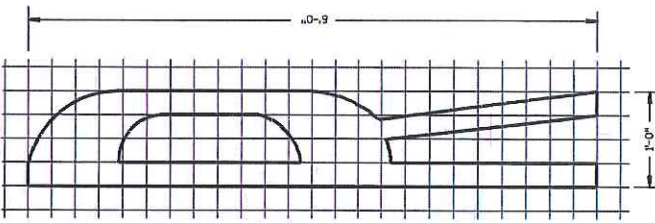

TABLE BASED UPON 20-4 WISCONSIN SUPPLEMENT OF MANUAL ON UNIFORM TRAFFIC CONTROL DEVICES.

Posted Speed (MPH)	Dimension Range (Feet)
25	150'- 250'
30	200'- 300'
35	250'- 450'
40	300'- 500'
45	400'- 650'
50	550'- 800'
55	750'- 1000'
60	1000'- 1250'
65	1000'- 1250'

* THE MINIMUM DISTANCES IN THE TABLE ARE DESIRABLE AND SHOULD BE USED. THE DISTANCES MAY BE INCREASED TO MEET SPECIAL FIELD CONDITIONS. SUCH AS THE CLOSE PROXIMITY OF OVERHEAD POWER LINES, SIDEROGS OR OTHER FEATURES THAT WOULD PROHIBIT THE MINIMUM DISTANCES FROM BEING USED.



PAVEMENT MARKING

GENERAL NOTES

1. MINIMUM 8' FROM ANY RAILROAD WARNING DEVICES (SIGNALS, GATES, ETC.) OR 25' FROM THE NEAREST RAIL, WHICHEVER DISTANCE IS GREATER.
2. 500' MINIMUM MARKING LIMITS MAY BE EXTENDED AS DIRECTED BY THE ENGINEER TO MEET ADJACENT NO-PASSING ZONE MARKINGS.
3. FOR MULTIPLE TRACK CROSSINGS, THE BARRIER LINE SHALL EXTEND TO THE NEAR RAIL OF THE FURTHEST TRACK IN THE DIRECTION OF HIGHWAY TRAVEL.

SIGNING AND PAVEMENT MARKING DETAILS FOR RAILROAD-HIGHWAY GRADE CROSSINGS

STATE OF WISCONSIN
DEPARTMENT OF TRANSPORTATION

APPROVED: _____
DATE: 4-18-2016

BY: Matthew R. Rugh
STATE SIGNING AND MARKING ENGINEER

FHWA



Developed by: Kory Dercks
 Phone: (608) 266-1379
 FAX #: (608) 267-0294
 E-Mail: kory.dercks@dot.wi.gov

Region/COUNTY(IES): NE / Manitowoc
 LOCATION: CTH CS - Broadway Street
 COMPLETED: 11/10/2014
 Traffic Forecasting Section; Bureau of Planning and Economic Development; Division of Transportation Investment Management

WisDOT TRAFFIC FORECAST REPORT
 PROJECT ID(S): 4310-06-00
 ROUTE(S): CTH R

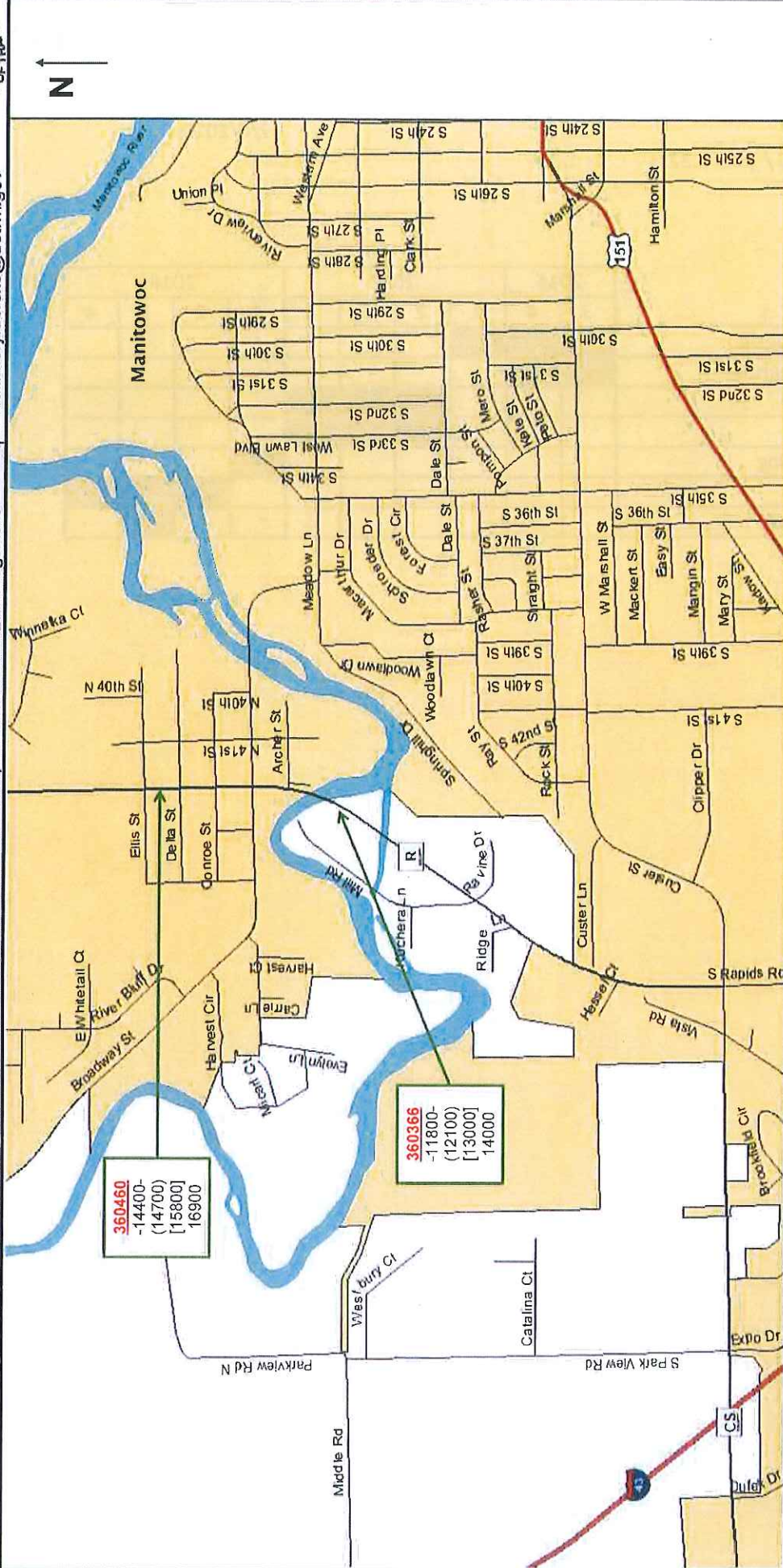

Region/COUNTY(IES): NE / Manitowoc
LOCATION: CTH CS - Broadway Street
COMPLETED: 11/10/2014
 Traffic Forecasting Section; Bureau of Planning and Economic Development; Division of Transportation Investment Management

PROJECT ID(S): 4310-06-00
 ROUTE(S): CTH R

Design Values (%)	(000) 2017 AADT	(000) 2027 AADT	(000) 2037 AADT
Site(s)	360460	[000]	[000]
Route(s)	CTHR	000	2037 AADT
Volume(s)	16900		
Site Growth %	0.75%		
K250	10.2		
K100	10.9		
K30	11.4		
P	12.6		
D(Dsgn. Hr.)	59/41		
T(DHV)	4.7		
T(PHV)	4.1		

	-000- 2014 Count
Trucks	360460
AADTT	790
2D	1.6
3AX	1.6
2S1+2S2	0.7
3-S2	1.3
DBL-BTM	0.3
Total %	5.5%

NOTES ON THE FORECAST:

- This projection assumes that no major new traffic generators will be added to the development already included in the 2010/2045 Northeast Regional Travel Demand Model.
- Truck classification percentages were taken from a table representative of similar facilities and locations throughout the state of Wisconsin.
- The historical traffic count trends will continue increasing at a decreasing rate. Box-Cox regression is used to project past count data.

NOTES ON THE FORECAST:

- CTHR is a Factor Group II (Urban-Other) roadway (indicating low to moderate fluctuation in traffic throughout the year). It is functionally classified as an Urban Principal Arterial (14) for count purposes.
- The 2010/2045 Northeast Regional Travel Demand Model was complete this forecast. The Traffic Analysis Forecasting Information System output was used as a comparison tool to check against the output. Adjustments were made as needed.
- Roadway improvements coded within the existing plus commit (E+C) network of the 2010/2045 Northeast Regional Travel Demand Model were assumed to be in place for the purpose of developing forecast.

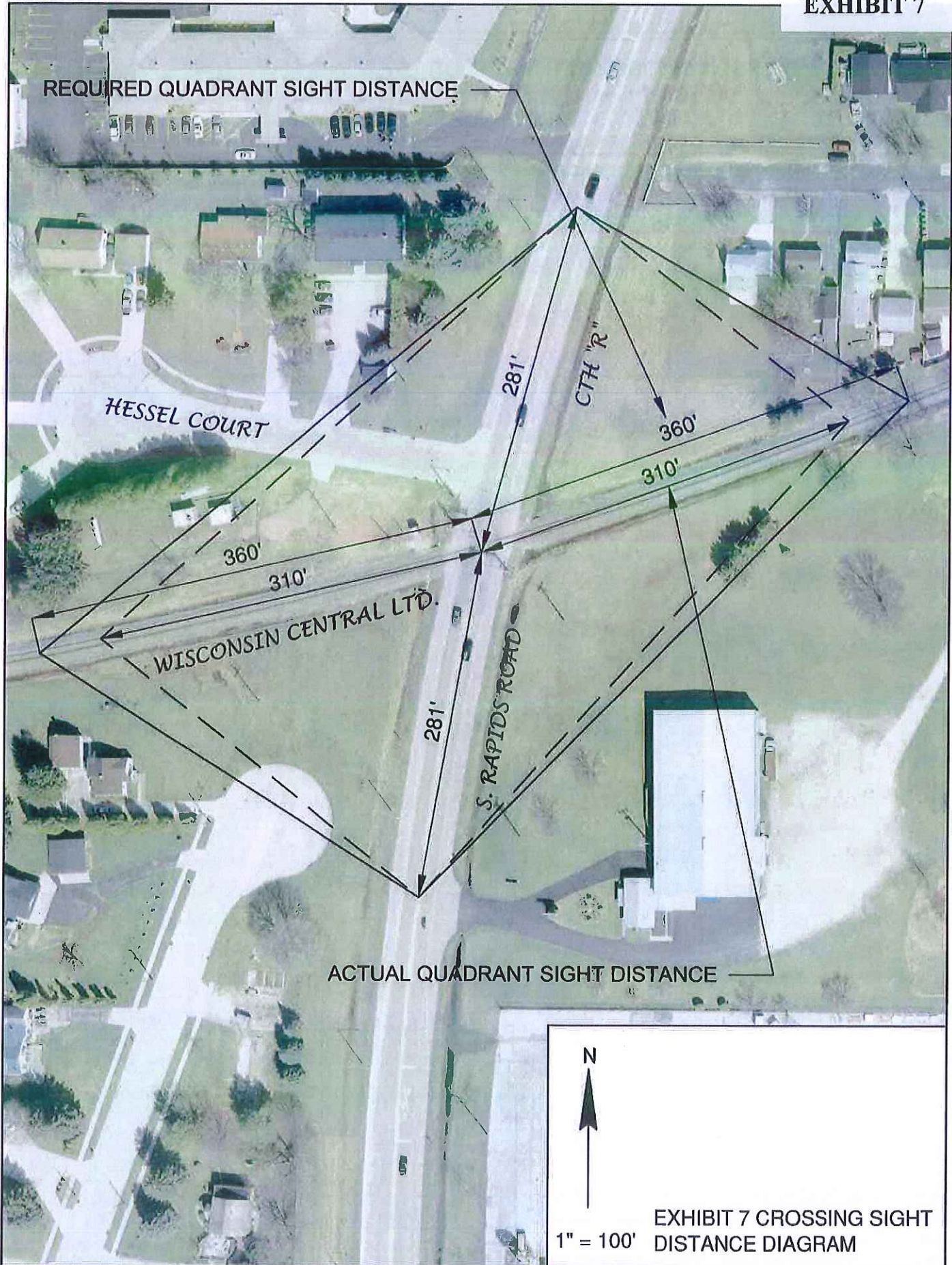



Federal Railroad Administration Office of Safety Analysis

You are Visitor# 12005185

[Home](#) [What's New](#) [Crossing](#) [Forms/Publications](#) [Downloads](#) [Data](#) [Documents](#) [Policies](#) [Support](#)

Highway-Rail Crossing Inventory & Accidents Query Result Page

Report Type: Accident Report
Crossing Number: 689792C
Records Found in Database: 0

No records found!

U. S. DOT CROSSING INVENTORY FORM

A. Revision Date (MM/DD/YYYY) 05/09/2013		PAGE 2		D. Crossing Inventory Number (7 char.) 689792C	
Part III: Highway or Pathway Traffic Control Device Information					
1. Are there Signs or Signals? <input checked="" type="checkbox"/> Yes <input type="checkbox"/> No	2. Types of Passive Traffic Control Devices associated with the Crossing				
	2.A. Crossbuck Assemblies (count) 2	2.B. STOP Signs (R1-1) (count) 0	2.C. YIELD Signs (R1-2) (count)	2.D. Advance Warning Signs (Check all that apply; include count) <input type="checkbox"/> None <input checked="" type="checkbox"/> W10-1 <input type="checkbox"/> W10-3 <input type="checkbox"/> W10-11 <input type="checkbox"/> W10-2 <input type="checkbox"/> W10-4 <input type="checkbox"/> W10-12	
2.E. Low Ground Clearance Sign (W10-5) <input type="checkbox"/> Yes (count _____) <input checked="" type="checkbox"/> No	2.F. Pavement Markings <input type="checkbox"/> Stop Lines <input type="checkbox"/> Dynamic Envelope <input type="checkbox"/> RR Xing Symbols <input checked="" type="checkbox"/> None		2.G. Channelization Devices/Medians <input type="checkbox"/> All Approaches <input type="checkbox"/> Median <input type="checkbox"/> One Approach <input type="checkbox"/> None	2.H. EXEMPT Sign (R15-3) <input type="checkbox"/> Yes <input type="checkbox"/> No	2.I. ENS Sign (I-13) Displayed <input checked="" type="checkbox"/> Yes <input type="checkbox"/> No
2.J. Other MUTCD Signs <input type="checkbox"/> Yes <input checked="" type="checkbox"/> No Specify Type _____ Count _____ Specify Type _____ Count _____ Specify Type _____ Count _____		2.K. Private Crossing Signs (If private) <input type="checkbox"/> Yes <input type="checkbox"/> No	2.L. LED Enhanced Signs (List types)		
3. Types of Train Activated Warning Devices at the Grade Crossing (specify count of each device for all that apply)					
3.A. Gate Arms (count) Roadway <u>0</u> Pedestrian _____	3.B. Gate Configuration <input type="checkbox"/> 2 Quad <input type="checkbox"/> Full (Barrier) Resistance <input type="checkbox"/> 3 Quad <input type="checkbox"/> Median Gates	3.C. Cantilevered (or Bridged) Flashing Light Structures (count) Over Traffic Lane <u>2</u> <input type="checkbox"/> Incandescent Not Over Traffic Lane <u>2</u> <input type="checkbox"/> LED		3.D. Mast Mounted Flashing Lights (count of masts) <u>2</u> <input type="checkbox"/> Incandescent <input type="checkbox"/> LED <input type="checkbox"/> Back Lights Included <input type="checkbox"/> Side Lights Included	3.E. Total Count of Flashing Light Pairs 8
3.F. Installation Date of Current Active Warning Devices: (MM/YYYY) ____/____/____ <input type="checkbox"/> Not Required		3.G. Wayside Horn <input type="checkbox"/> Yes Installed on (MM/YYYY) ____/____/____ <input type="checkbox"/> No		3.H. Highway Traffic Signals Controlling Crossing <input type="checkbox"/> Yes <input checked="" type="checkbox"/> No	3.I. Bells (count) 1
3.J. Non-Train Active Warning <input type="checkbox"/> Flagging/Flagman <input type="checkbox"/> Manually Operated Signals <input type="checkbox"/> Watchman <input type="checkbox"/> Floodlighting <input type="checkbox"/> None				3.K. Other Flashing Lights or Warning Devices Count <u>0</u> Specify type _____	
4.A. Does nearby Hwy Intersection have Traffic Signals? <input type="checkbox"/> Yes <input checked="" type="checkbox"/> No	4.B. Hwy Traffic Signal Interconnection <input checked="" type="checkbox"/> Not Interconnected <input type="checkbox"/> For Traffic Signals <input type="checkbox"/> For Warning Signs	4.C. Hwy Traffic Signal Preemption <input type="checkbox"/> Simultaneous <input type="checkbox"/> Advance	5. Highway Traffic Pre-Signals <input type="checkbox"/> Yes <input type="checkbox"/> No Storage Distance * _____ Stop Line Distance * _____	6. Highway Monitoring Devices (Check all that apply) <input type="checkbox"/> Yes - Photo/Video Recording <input type="checkbox"/> Yes - Vehicle Presence Detection <input type="checkbox"/> None	
Part IV: Physical Characteristics					
1. Traffic Lanes Crossing Railroad Number of Lanes <u>2</u> <input type="checkbox"/> One-way Traffic <input type="checkbox"/> Two-way Traffic <input type="checkbox"/> Divided Traffic		2. Is Roadway/Pathway Paved? <input checked="" type="checkbox"/> Yes <input type="checkbox"/> No	3. Does Track Run Down a Street? <input type="checkbox"/> Yes <input checked="" type="checkbox"/> No	4. Is Crossing Illuminated? (Street lights within approx. 50 feet from nearest rail) <input type="checkbox"/> Yes <input checked="" type="checkbox"/> No	
5. Crossing Surface (on Main Track, multiple types allowed) Installation Date * (MM/YYYY) ____/____/____ Width * _____ Length * _____ <input type="checkbox"/> 1 Timber <input checked="" type="checkbox"/> 2 Asphalt <input type="checkbox"/> 3 Asphalt and Timber <input type="checkbox"/> 4 Concrete <input type="checkbox"/> 5 Concrete and Rubber <input type="checkbox"/> 6 Rubber <input type="checkbox"/> 7 Metal <input type="checkbox"/> 8 Unconsolidated <input type="checkbox"/> 9 Composite <input type="checkbox"/> 10 Other (specify) _____					
6. Intersecting Roadway within 500 feet? <input checked="" type="checkbox"/> Yes <input type="checkbox"/> No If Yes, Approximate Distance (feet) <u>-75</u>		7. Smallest Crossing Angle <input type="checkbox"/> 0° - 29° <input type="checkbox"/> 30° - 59° <input checked="" type="checkbox"/> 60° - 90°		8. Is Commercial Power Available? * <input checked="" type="checkbox"/> Yes <input type="checkbox"/> No	
Part V: Public Highway Information					
1. Highway System <input type="checkbox"/> (01) Interstate Highway System <input type="checkbox"/> (02) Other Nat Hwy System (NHS) <input checked="" type="checkbox"/> (03) Federal AID, Not NHS <input type="checkbox"/> (08) Non-Federal Aid		2. Functional Classification of Road at Crossing <input type="checkbox"/> (0) Rural <input checked="" type="checkbox"/> (1) Urban <input type="checkbox"/> (1) Interstate <input type="checkbox"/> (5) Major Collector <input type="checkbox"/> (2) Other Freeways and Expressways <input checked="" type="checkbox"/> (3) Other Principal Arterial <input type="checkbox"/> (6) Minor Collector <input type="checkbox"/> (4) Minor Arterial <input type="checkbox"/> (7) Local		3. Is Crossing on State Highway System? <input type="checkbox"/> Yes <input checked="" type="checkbox"/> No	4. Highway Speed Limit _____ MPH <input type="checkbox"/> Posted <input type="checkbox"/> Statutory
7. Annual Average Daily Traffic (AADT) Year <u>2005</u> AADT <u>011200</u>		8. Estimated Percent Trucks <u>06</u> %	9. Regularly Used by School Buses? <input type="checkbox"/> Yes <input checked="" type="checkbox"/> No Average Number per Day <u>0</u>		10. Emergency Services Route <input type="checkbox"/> Yes <input type="checkbox"/> No
Submission Information - This information is used for administrative purposes and is not available on the public website.					
Submitted by _____ Organization _____ Phone _____ Date _____					
Public reporting burden for this information collection is estimated to average 30 minutes per response, including the time for reviewing instructions, searching existing data sources, gathering and maintaining the data needed and completing and reviewing the collection of information. According to the Paperwork Reduction Act of 1995, a federal agency may not conduct or sponsor, and a person is not required to, nor shall a person be subject to a penalty for failure to comply with, a collection of information unless it displays a currently valid OMB control number. The valid OMB control number for information collection is 2130-0017. Send comments regarding this burden estimate or any other aspect of this collection, including for reducing this burden to: Information Collection Officer, Federal Railroad Administration, 1200 New Jersey Ave. SE, MS-25 Washington, DC 20590.					

U. S. DOT CROSSING INVENTORY FORM

DEPARTMENT OF TRANSPORTATION
FEDERAL RAILROAD ADMINISTRATION

OMB No. 2130-0017

Instructions for the initial reporting of the following types of new or previously unreported crossings: For public highway-rail grade crossings, complete the entire Inventory Form. For private highway-rail grade crossings, complete the Header, Parts I and II, and the Submission Information section. For public pathway grade crossings (including pedestrian station grade crossings), complete the Header, Parts I and II, and the Submission Information section. For Private pathway grade crossings, complete the Header, Part I, and the Submission Information section. For changes to existing data, complete the Header, Part I Items 1-3, and the Submission Information section, in addition to the updated data fields. Note: For private crossings only, Part I Item 20 and Part III Item 2.K. are required unless otherwise noted. An asterisk * denotes an optional field.

A. Revision Date (MM/DD/YYYY) 05 / 09 / 2013	B. Reporting Agency <input checked="" type="checkbox"/> Railroad <input type="checkbox"/> Transit <input type="checkbox"/> State <input type="checkbox"/> Other	C. Reason for Update (Select only one) <input checked="" type="checkbox"/> Change in Data <input type="checkbox"/> Re-Open <input type="checkbox"/> New <input type="checkbox"/> Date Change Only <input type="checkbox"/> Closed <input type="checkbox"/> Change in Primary Operating RR <input type="checkbox"/> No Train Traffic <input type="checkbox"/> Admin. Correction <input type="checkbox"/> Quiet Zone Update	D. DOT Crossing Inventory Number 689792C
---	--	---	--

Part I: Location and Classification Information

1. Primary Operating Railroad Wisconsin Central Ltd. (also Railway) [WC]		2. State WISCONSIN	3. County MANITOWOC
4. City / Municipality <input checked="" type="checkbox"/> In <input type="checkbox"/> Near MANITOWOC		5. Street/Road Name & Block Number RAPIDS RD (Street/Road Name) * (Block Number)	
6. Highway Type & No. R-CTH		7. Do Other Railroads Operate a Separate Track at Crossing? <input type="checkbox"/> Yes <input checked="" type="checkbox"/> No If Yes, Specify RR	
8. Do Other Railroads Operate Over Your Track at Crossing? <input type="checkbox"/> Yes <input checked="" type="checkbox"/> No If Yes, Specify RR		9. Railroad Division or Region <input type="checkbox"/> None SOUTH	
10. Railroad Subdivision or District <input type="checkbox"/> None MANITOWOC		11. Branch or Line Name <input type="checkbox"/> None	
12. RR Milepost 0041.32 (prefix) (nnnn.nnn) (suffix)		13. Line Segment * WX227.68H	
14. Nearest RR Timetable Station * MANITOWOC		15. Parent RR (if applicable) <input type="checkbox"/> N/A CN	
16. Crossing Owner (if applicable) <input type="checkbox"/> N/A WC		17. Crossing Type <input checked="" type="checkbox"/> Public <input type="checkbox"/> Private	
18. Crossing Purpose <input checked="" type="checkbox"/> Highway <input type="checkbox"/> Pathway, Ped. <input type="checkbox"/> Station, Ped.		19. Crossing Position <input checked="" type="checkbox"/> At Grade <input type="checkbox"/> RR Under <input type="checkbox"/> RR Over	
20. Public Access (if Private Crossing) <input type="checkbox"/> Yes <input checked="" type="checkbox"/> No		21. Type of Train <input type="checkbox"/> Freight <input type="checkbox"/> Intercity Passenger <input type="checkbox"/> Commuter <input type="checkbox"/> Transit <input type="checkbox"/> Shared Use Transit <input type="checkbox"/> Tourist/Other	
22. Average Passenger Train Count Per Day <input type="checkbox"/> Less Than One Per Day <input type="checkbox"/> Number Per Day 0		23. Type of Land Use <input type="checkbox"/> Open Space <input type="checkbox"/> Farm <input type="checkbox"/> Residential <input checked="" type="checkbox"/> Commercial <input type="checkbox"/> Industrial <input type="checkbox"/> Institutional <input type="checkbox"/> Recreational <input type="checkbox"/> RR Yard	
24. Is there an Adjacent Crossing with a Separate Number? <input type="checkbox"/> Yes <input checked="" type="checkbox"/> No If Yes, Provide Crossing Number		25. Quiet Zone (FRA provided) <input checked="" type="checkbox"/> No <input type="checkbox"/> 24 Hr <input type="checkbox"/> Partial <input type="checkbox"/> Chicago Excused Date Established	
26. HSR Corridor ID <input type="checkbox"/> N/A		27. Latitude in decimal degrees (WGS84 std: nn.nnnnnn) 44.0871000	
28. Longitude in decimal degrees (WGS84 std: -nnn.nnnnnn) -87.7076000		29. Lat/Long Source <input type="checkbox"/> Actual <input checked="" type="checkbox"/> Estimated	
30.A. Railroad Use *		31.A. State Use *	
30.B. Railroad Use *		31.B. State Use *	
30.C. Railroad Use *		31.C. State Use *	
30.D. Railroad Use *		31.D. State Use *	
32.A. Narrative (Railroad Use) *		32.B. Narrative (State Use) *	
33. Emergency Notification Telephone No. (posted) 800-616-3432		34. Railroad Contact (Telephone No.)	
35. State Contact (Telephone No.) 608-266-1168			

Part II: Railroad Information

1. Estimated Number of Daily Train Movements				
1.A. Total Day Thru Trains (6 AM to 6 PM) 2	1.B. Total Night Thru Trains (6 PM to 6 AM) 2	1.C. Total Switching Trains 0	1.D. Total Transit Trains	1.E. Check if Less Than One Movement Per Day <input type="checkbox"/> How many trains per week?
2. Year of Train Count Data (YYYY)		3. Speed of Train at Crossing 3.A. Maximum Timetable Speed (mph) 35 3.B. Typical Speed Range Over Crossing (mph) From 15 to 25		
4. Type and Count of Tracks Main 1 Siding Yard Transit Industry				
5. Train Detection (Main Track only) <input type="checkbox"/> Constant Warning Time <input type="checkbox"/> Motion Detection <input type="checkbox"/> AFO <input type="checkbox"/> PTC <input checked="" type="checkbox"/> DC <input type="checkbox"/> Other <input type="checkbox"/> None				
6. Is Track Signaled? <input type="checkbox"/> Yes <input checked="" type="checkbox"/> No		7.A. Event Recorder <input type="checkbox"/> Yes <input type="checkbox"/> No		7.B. Remote Health Monitoring <input type="checkbox"/> Yes <input type="checkbox"/> No