

Parks Rec  
4-7-14

14-469

# UNION PARK COMMUNITY GARDEN

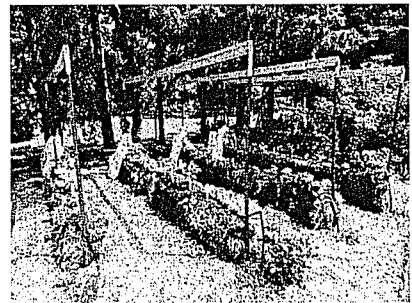
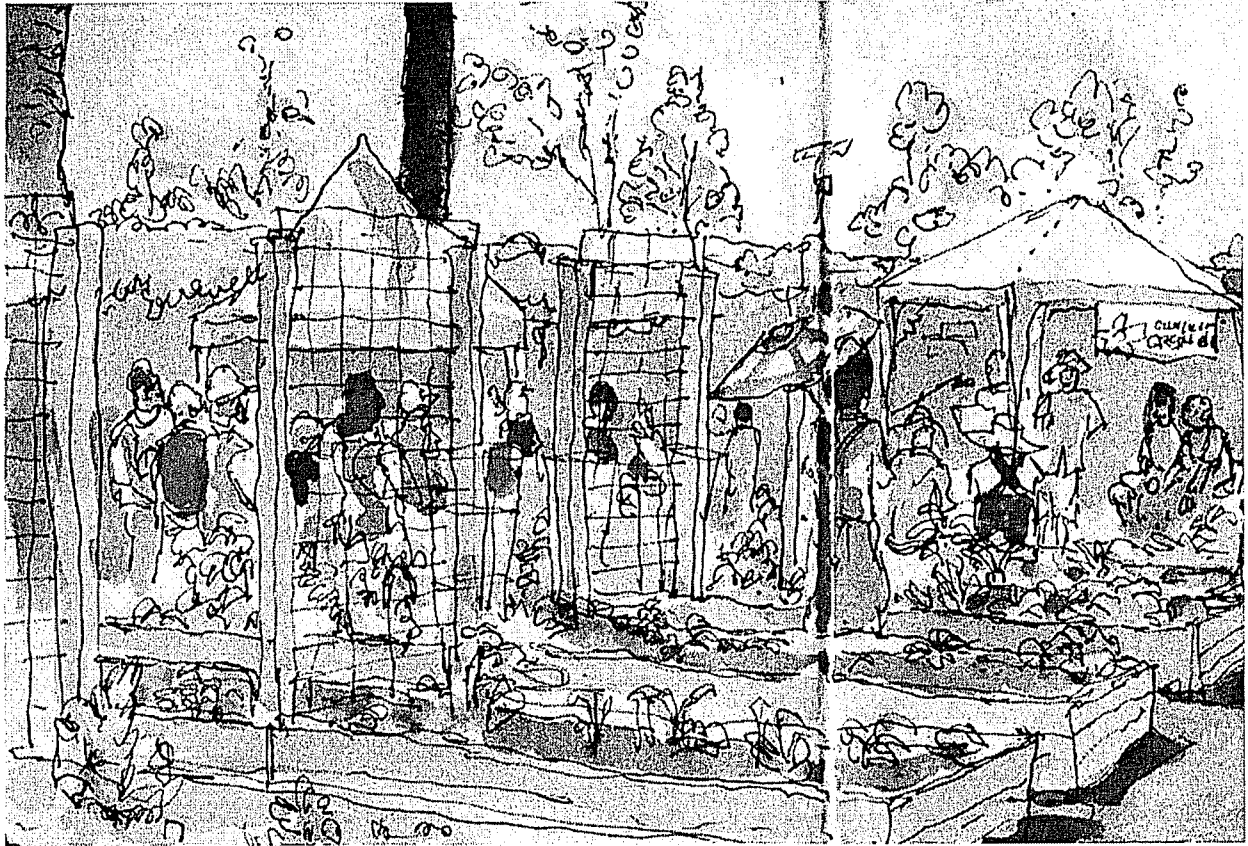

## Community Garden Proposal

Prepared for: Chad Scheinoha, Parks Department; Justin Nickels, Mayor  
Prepared by: Michael Pearson, Project Lead  
March 23, 2014

RECEIVED  
MAR 25 2014  
CITY CLERKS OFFICE

---

# UNION PARK COMMUNITY GARDEN

## EXECUTIVE SUMMARY

### **Objective**

We are a group in it's early stages of organizing to establish a Community Garden in downtown Manitowoc. Already 50 members strong after only 2 meetings, the group is growing fast and gaining momentum. We would like to adopt Union Park and convert the lower Southern field into our garden. We will implement many farming styles with no individual plots. We will grow for us, by us. A portion of the harvest (~25%) will be donated to local charities. Half of the harvest will be given as work-share for a limited number of volunteers, the rest eaten on-site.

### **Goals**

Our project is primarily focused on building community hand-in-hand with growing food. This project will incorporate new, unconventional farming methods and a rain-water collection system. But we would like to host events every week such as: garden tours, children's classes, acoustic music, art installations, afternoon tea, yoga and meditation classes, and artists/crafters workshops. I am sure this is just the beginning - Union Park Community Garden will sow the seeds of cooperation and collaboration in the minds and hearts of our community.

### **Solution**

Over the next month, our group will be meeting twice a week in preparation for our target ground breaking date: Earth Day Weekend (April 26-27). We will establish a non-profit and garner donations and support from every arena of the local community. We will amass a coalition of volunteers, make connections with local and regional partners in sustainable agriculture, and we will raise awareness that the benefits of growing your own food extend well beyond a tasty dinner.

### **Project Outline**

Over the next few weeks we would like to plot out the garden, begin setting up the rainwater collection system, and begin building the raised-bed garden-boxes that will be located on the top section of the park, along the pathways to allow those with limited mobility to join us with ease. We will host drop-off dates for donations of tools and seeds. We will have the UW extension perform a soil test. And finally we have contacted United Way - and their Day of Caring volunteer day falls on Earth Day weekend, so we have planned to work with them on our big ground-breaking weekend!

This summer, we propose to build a small shed on the lower garden level to store equipment. We would like to host events throughout the whole park (within park hours and respecting any groups who already use the park). One of the main focuses I would love to see is creating a recycled art fence or installation art in the park. In collaboration with local high schools, colleges, and the Rahr West, we would like to send an open invitation to all artists to come infuse our garden with their design and vision.

---

---

## UNION PARK COMMUNITY GARDEN

First and foremost, over the next few weeks, we will determine how many of our group are committed to seeing the idea through to fruition, and from this will determine the appropriate size of garden we shall grow this summer. My theory is that a smaller, more manageable, and continuously maintained garden is much more desirable than biting off more than you can chew. Our target is to establish 40 volunteers who will commit to 4 hours of work each week - spread out over 5 to 7 days a week. We plan to do this through our work-share program which is a seasonal commitment. If we do not have enough hands to help, and we'll gladly wait and plan on expanding our operation for the years to come.

The Union Park Community Garden is the pilot project for a much larger idea - to establish greenhouses in Manitowoc and work towards growing a large majority of all produce consumed in Manitowoc, locally. This is only the beginning of our local food revolution - and what better timing than right now as Manitowoc Healthiest County, the Farm to School Program, and the future Clipper City Co-op are all starting to gain attention and pick up traction. I hope you will join us as we paint a new vision for this town.

### Contact Lead

Michael Pearson

(920) · 242 · 8966

grateful-mjp@gmail.com

---

# CITY OF MANITOWOC - WISCONSIN

Prepared by City of Manitowoc  
 Planning Department  
 www.manitowoc.org  
 Aerial Photo: 4/11/2010  
 Map Printed: 3/21/2014  
 DISCLAIMER: Maps and associated data are  
 believed to be accurate, but are not  
 warranted. This information is not intended  
 for legal, survey, or other related uses.  
 Please obtain the original recorded  
 documents for legal or survey information.

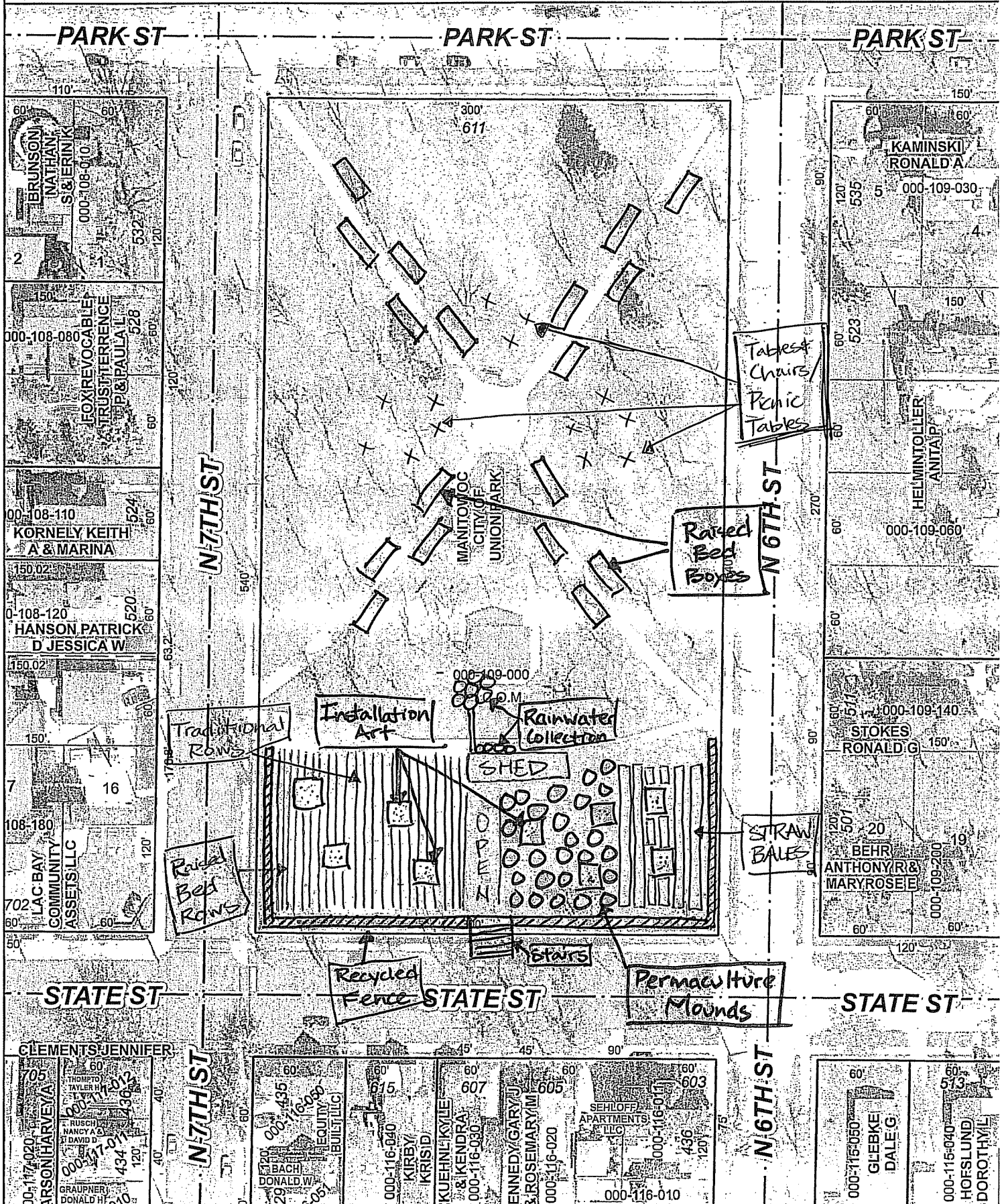
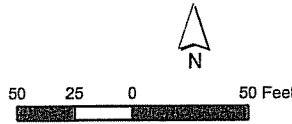

# CITY OF MANITOWOC - WISCONSIN

Prepared by City of Manitowoc  
 Planning Department  
 www.manitowoc.org  
 Aerial Photo: 4/11/2010  
 Map Printed: 3/21/2014  
 DISCLAIMER: Maps and associated data are  
 believed to be accurate, but are not  
 warranted. This information is not intended  
 for legal, survey, or other related uses.  
 Please obtain the original recorded  
 documents for legal or survey information.

