



CITY OF MANITOWOC  
WISCONSIN, USA  
[www.manitowoc.org](http://www.manitowoc.org)



July 30, 2020

To: Mayor and Common Council

From: Paul Braun, City Planner

**Subject: PC 25-2020: Lighthouse Recovery Community Center; Request for a Conditional Use Permit Under Section 15.230(3)k and 15.370(27) for Property at 1114 S. 11<sup>th</sup> Street for the establishment of a Transitional Housing Use**

At the July 29, 2020 meeting of the Manitowoc City Plan Commission, the Commission recommended to the Common Council the following action:

***Approve the proposed Ordinance pursuant to the attached conditions and map.***

Granicus #: 20-0753  
Attachments: Map and Conditions

REQUIREMENTS FOR  
CONDITIONAL USE PERMIT (CUP) APPROVAL FOR  
LIGHTHOUSE RECOVERY COMMUNITY CENTER  
LOCATED AT 1114 S. 11<sup>TH</sup> STREET  
TAX PARCEL # 000-288-080  
7/29/2020

- A. The CUP shall require compliance with all applicable local and state regulations including issuance and maintenance of any license to Lighthouse Recovery Community Center (Lighthouse) for the operation of a transitional housing facility. If Lighthouse is not successful in receiving any of their licensing by December 31, 2020 Lighthouse shall be required to re-apply for a CUP.
- B. Lighthouse shall be subject to a maximum of up to 10 residents plus staff at the location.
- C. Lighthouse shall not assign or transfer its interest in the CUP to any party without the written approval of the Manitowoc City Plan Commission and Manitowoc Common Council. The CUP shall automatically terminate effective the date any License or certification granted to Lighthouse by the State or licensing entity is closed, denied, revoked, or terminated.
- D. Non-compliance with the terms of the CUP may result in the modification of the terms and conditions of the CUP, issuance of citations and financial penalties, or immediate revocation of the CUP.
- E. Prior to issuance of the CUP by the Common Council, Lighthouse shall receive permission/approval from the Wisconsin Department of Safety & Professional Services (DSPS) regarding building, fire and life safety codes and requirements.

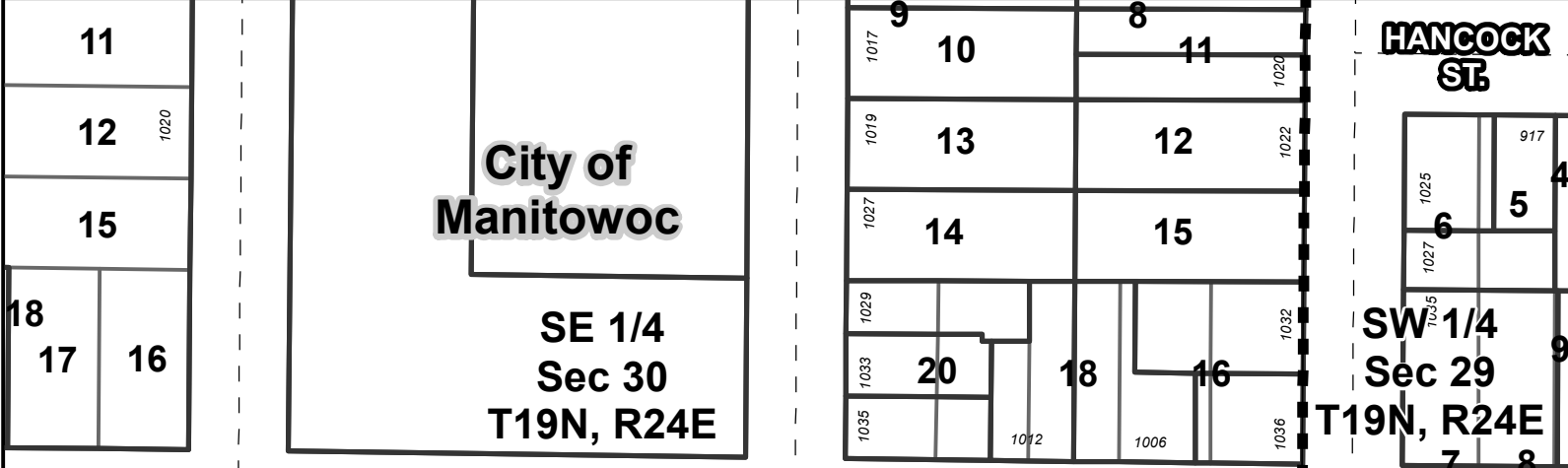

**MARSHALL ST.**

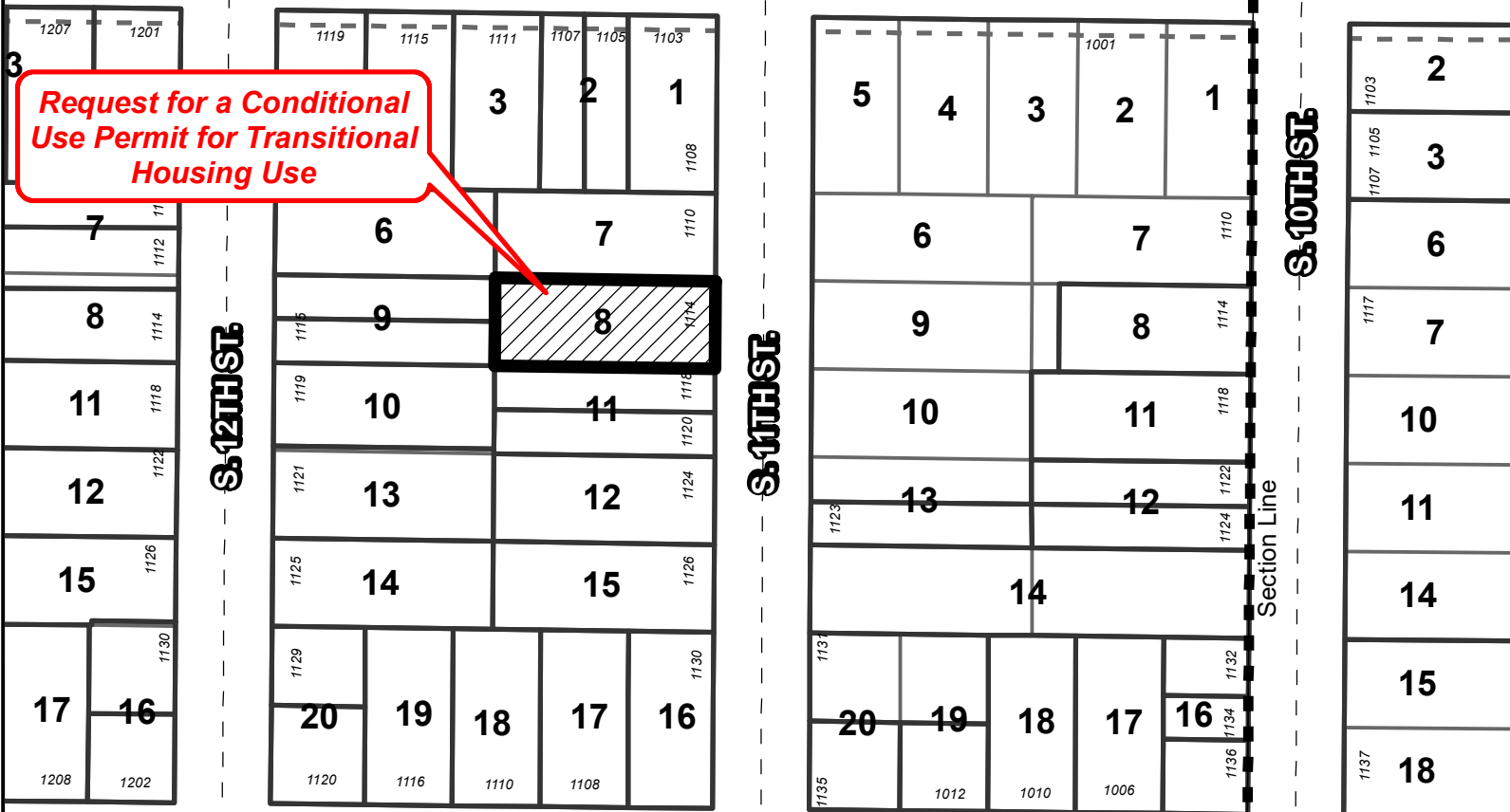

**HAMILTON ST.**

# CONDITIONAL USE PERMIT

City of Manitowoc, WI

 Area of Conditional Use Permit for Lighthouse Recovery Community Center

PC 25-2020  
1114 S. 11th St.

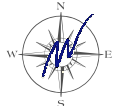

0 75 150 Feet

DISCLAIMER: Maps and associated data are believed to be accurate, but are not warranted. This information is not intended for legal, survey, or other related uses. Please obtain the original recorded documents for legal or survey information.

Prepared by City of Manitowoc  
Community Development Department  
www.manitowoc.org  
Map Plotted: 7/28/2020

O:\Planning\PC Plan Commission\PC\_CUP\2020\PC 25-2020 Lighthouse Recovery CUP\Maps\PC 25-2020 Lighthouse Recovery Center CUP B&W.mxd

Manitowoc City Plan Commission

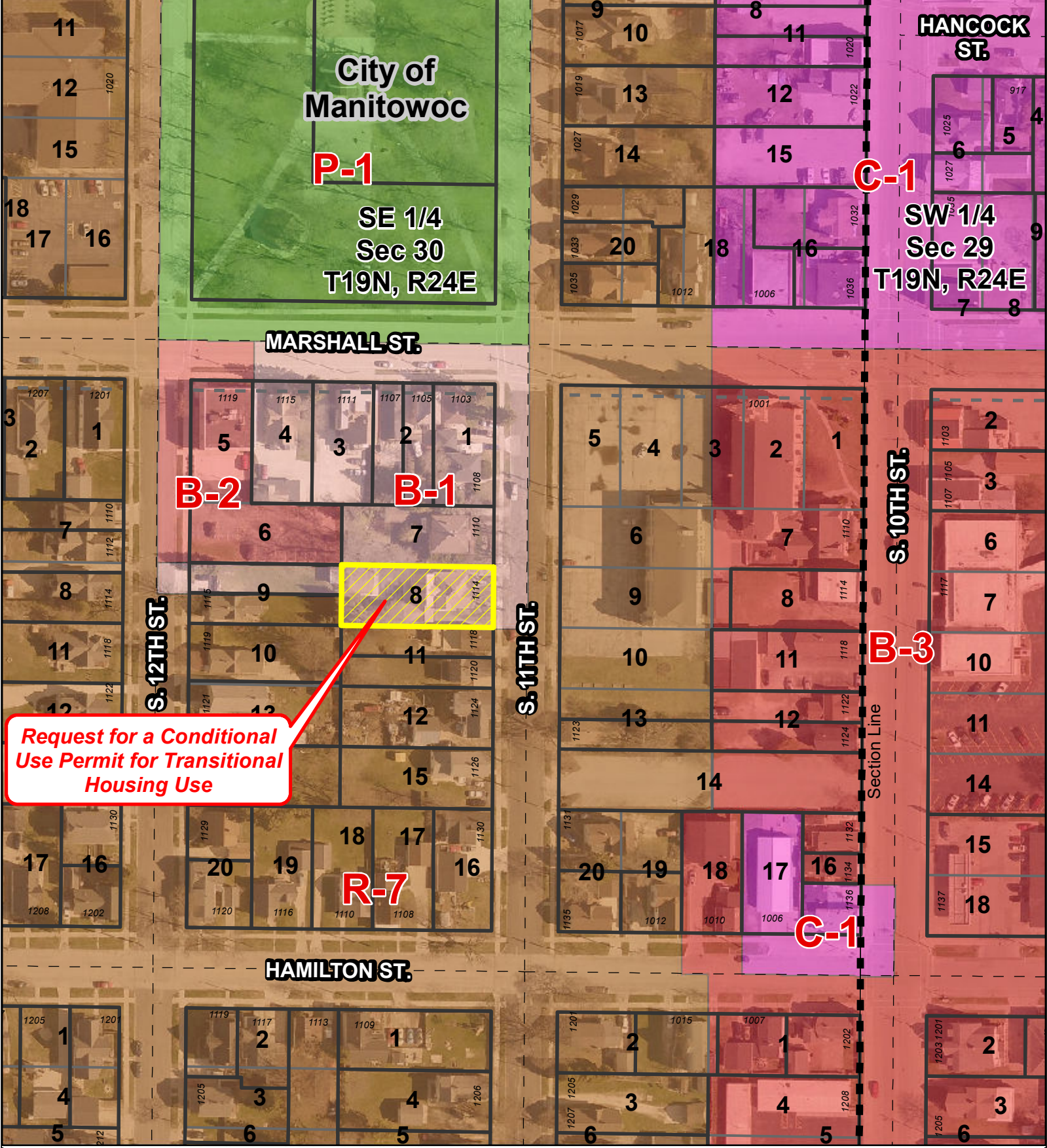

**Request for a Conditional Use Permit for Transitional Housing Use**

# CONDITIONAL USE PERMIT

City of Manitowoc, WI

Area of Conditional Use Permit for Lighthouse Recovery Community Center

PC 25-2020  
1114 S. 11th St.

DISCLAIMER: Maps and associated data are believed to be accurate, but are not warranted. This information is not intended for legal, survey, or other related uses. Please obtain the original recorded documents for legal or survey information.

Prepared by City of Manitowoc  
Community Development Department  
www.manitowoc.org  
Map Plotted: 7/22/2020

O:\Planning\PC Plan Commission\PC\_CUP\2020\PC 25-2020 Lighthouse Recovery CUP\Maps\PC 25-2020 Lighthouse Recovery Center CUP Zoning.mxd

Manitowoc City Plan Commission

