

COW
9-21-15

15-965

ORDINANCE

An Ordinance to annex certain territory from the Town of Manitowoc Rapids to the City of Manitowoc as part of the 9th Aldermanic District and the 17th, 18th, 21st, 23rd, 24th and 25th Wards of the City.

WHEREAS, the petition to annex the territory described below has been filed with the City of Manitowoc; and

WHEREAS, the petition meets the requirements of Wisconsin Statute Section 66.0217(2); and

WHEREAS, the Manitowoc Common Council has determined that the City has reasonable need for the property and it is in the best interest of the petitioners, the residents and owners of property in the area to be annexed and the City of Manitowoc to annex the property to the City; and

WHEREAS, the Common Council has reviewed the recommendations of the Wisconsin Department of Administration pursuant to Wisconsin Statute Section 66.0217(6)(a); and

NOW, THEREFORE, the Mayor and Common Council of the City of Manitowoc do ordain as follows:

SECTION 1. Territory Annexed. Pursuant to Wisconsin Statute Section 66.0217(8), the following described territory in the Town of Manitowoc Rapids, Manitowoc County, Wisconsin is hereby annexed to the City of Manitowoc:

DESCRIPTION

Tract 2 of a Certified Survey recorded in Volume 1, of Certified Survey Maps, Page 487, Document No. 410948, and being more particularly described as follows:

A tract of land in the Southeast Quarter of the Southwest Quarter (SE ¼ SW ¼) of Section Thirty-five (35), Township Nineteen (19) North, Range Twenty-three (23) East, described as follows: Commencing at the South ¼ corner of Section 35, T. 19N., R. 23E., thence N. 1° 31' 30" E. along the ¼ section line a distance of 1,140.1 feet to the point of real beginning; thence continuing N. 1° 31' 30" E. along the ¼ section line a distance of 100 feet, thence due West a distance of 250 feet; thence S. 1° 31' 30" W. a distance of 100 feet; thence due East a distance of 250 feet to the point of real beginning.

Said described area contains 24,829 square feet or 0.57 acres of land more or less.

SECTION 2. Aldermanic District and Ward. The territory herein described is made part of the 9th Aldermanic District and 26th Ward of the City of Manitowoc:

SECTION 3. Zone District Classification. The territory annexed is classified as "B-2" Neighborhood Business, all according to the attached map.

SECTION 4. Two Thirds Vote. Passage of this Ordinance requires a two thirds vote of the elected members of the Common Council.

SECTION 5. Effective Date. This Ordinance shall take effect on the day after its publication.

SEP 21 2015

INTRODUCED _____

ADOPTED _____

APPROVED _____

JUSTIN M. NICKELS, MAYOR

Fiscal Impact:	<u>\$1,359.25</u>
Funding Source:	<u>1100-19900-574200</u>
Finance Director Approval:	/sc
Approved as to form:	/kmm

WDOA File Ref: MBR # 13882

HECKER RD

TR
2

TR 7

TR 8

TR 1

TR 7

City Limits

TR "A"

100' +/-

TR 2

225' +/-

TR 3

1

SW 1/4
SEC 35,
T19N, R23E

TR 4

SE 1/4
SEC 35,
T19N, R23E

TR 5

TR 1.1

2

Town of
Manitowoc Rapids

City of
Manitowoc

TR 6

3

TR 1

TR 1.2

TR 2

TR 3

4

TR 1.3

South Corner
Section 35

W VIEBAHN ST

VIEBAHN ST

City Limits

NW 1/4
SEC 02,
T18N, R23E

TR "A"

North Corner
Section 2

NE 1/4
SEC 02,
T18N, R23E

Section Line

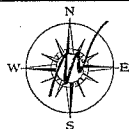

Hecker #2 Annexation Map

City of Manitowoc, WI

**Area of Proposed
Annexation - 0.57 Acres +/-**



PC28-2015 Annexation;
2410 Hecker Rd.

Prepared by City of Manitowoc
Planning Department
www.manitowoc.org
Map Plotted: 08/18/2015

Y:\Planning\PC Plan Commission\Actions 2015\PC28-2015 Annexation Lawrence 2410 Hecker Rd\Annexation Lawrence

DISCLAIMER: Maps and associated data are believed to be accurate, but are not warranted. This information is not intended for legal, survey, or other related uses. Please obtain the original recorded documents for legal or survey information.



-  Annexation Property
-  Corporate Limits
-  Official Map Street

Manitowoc City Plan Commission

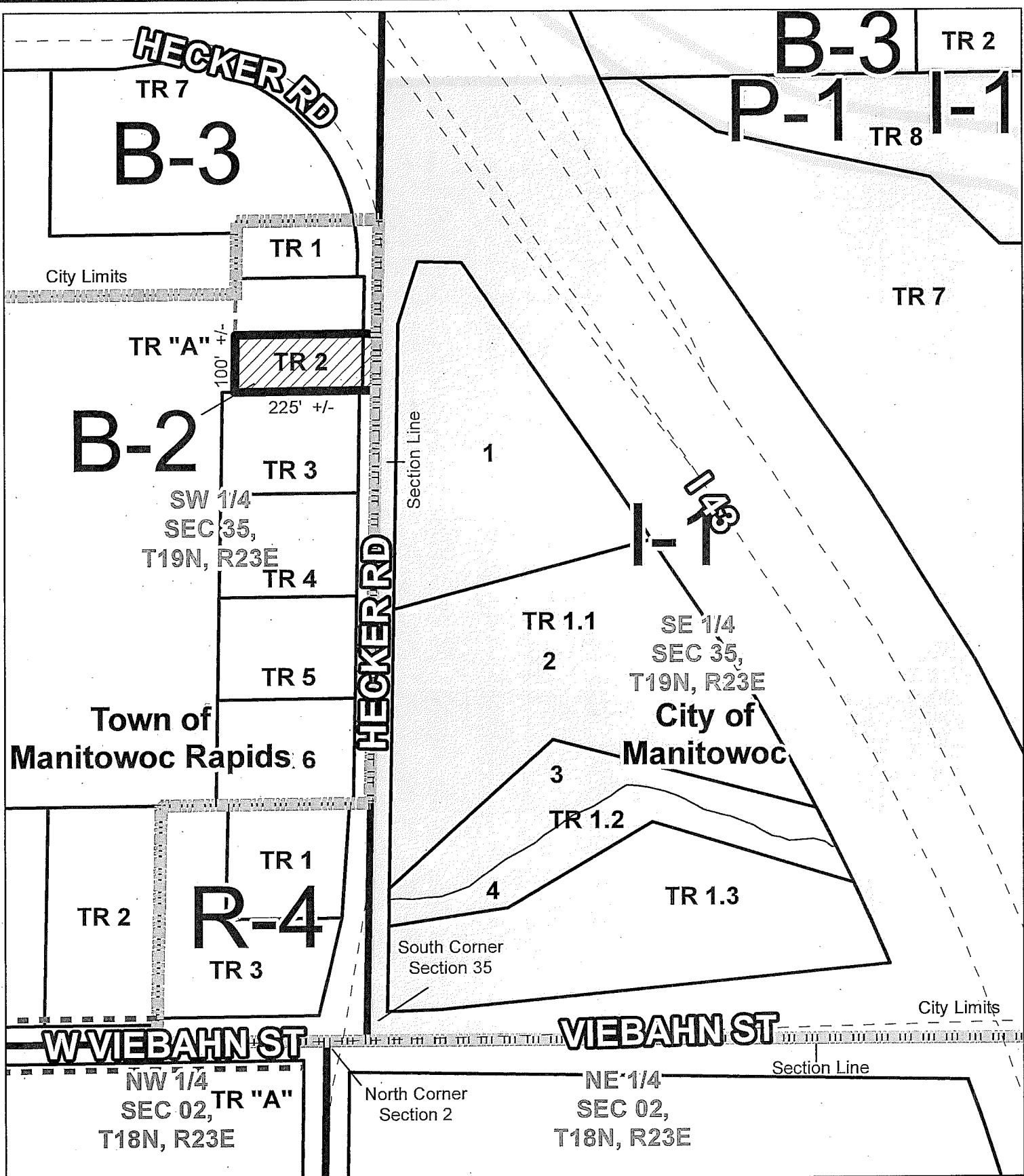

Hecker #2 Annexation Map
 City of Manitowoc, WI
Area To Be Zoned "B-2"
Neighborhood Business District

PC28-2015 Annexation;
 2410 Hecker Rd.

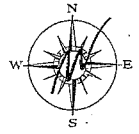

Prepared by City of Manitowoc
 Planning Department
 www.manitowoc.org
 Map Plotted: 08/18/2015
 Y:\Planning\PC Plan Commission\Actions 2015\PC28-2015 Annexation Lawrence 2410 Hecker Rd\Annexation Lawrence
 DISCLAIMER: Maps and associated data are believed to be accurate, but are not warranted. This information is not intended for legal, survey, or other related uses. Please obtain the original recorded documents for legal or survey information.



- Official Map Street
- Corporate Limits
- Annexation Property

Manitowoc City Plan Commission

HECKER RD

TR 2

TR 7

TR 8

Aldermanic District 9

TR 7

City Limits

Ward 26

TR "A"

100' +/-

TR 2

225' +/-

TR 3

SW 1/4
SEC 35,
T19N, R23E

TR 4

TR 5

**Town of
Manitowoc Rapids**

TR 6

TR 1

TR 2

TR 3

Section Line

HECKER RD

1

143

SE 1/4
SEC 35,
T19N, R23E

TR 1.1

2

**City of
Manitowoc**

3

TR 1.2

4

TR 1.3

South Corner
Section 35

W VIEBAHN ST

VIEBAHN ST

City Limits

NW 1/4
SEC 02,
T18N, R23E

TR "A"

North Corner
Section 2

NE 1/4
SEC 02,
T18N, R23E

Section Line

Hecker #2 Annexation Map

City of Manitowoc, WI

Ward = 26

Population = 0

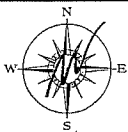

PC28-2015 Annexation;
2410 Hecker Rd.



Prepared by City of Manitowoc
Planning Department
www.manitowoc.org
Map Plotted: 08/18/2015

Y:\Planning\PC Plan Commission\Actions 2015\PC28-2015 Annexation Lawrence 2410 Hecker Rd\Annexation Lawrence
DISCLAIMER: Maps and associated data are believed to be accurate, but are not
warranted. This information is not intended for legal, survey, or other related uses.
Please obtain the original recorded documents for legal or survey information.



-  Annexation Property
-  Corporate Limits
-  Official Map Street

Manitowoc City Plan Commission