



CITY OF MANITOWOC

WISCONSIN, USA

www.manitowoc.org

April 28, 2022

To: Mayor and Common Council

From: Paul Braun, City Planner

Subject: PC 14-2022: BRIESE PROPERTIES LLC, PETITION TO REZONE FROM R-4 SINGLE AND TWO FAMILY RESIDENTIAL TO B-3 GENERAL BUSINESS. 2500 WASHINGTON STREET AND 900 BLOCK OF S. 25TH AND 26TH STREETS.

At the April 27, 2022 meeting of the Manitowoc City Plan Commission, the Commission recommended to the Common Council the following action:

Approve the change in zoning from R-4 Single and Two Family Residential to B-3 General Business.

Address of applicant
Briese Properties LLC
2500 Washington Street
Manitowoc, WI 54220

Granicus #: 22-0378

Attachments: Ordinance & Map

*Community Development Department • Phone (920) 686-6930
CITY HALL • 900 Quay Street • Manitowoc, WI 54220-4543 • Fax (920) 686-6939 • www.manitowoc.org*

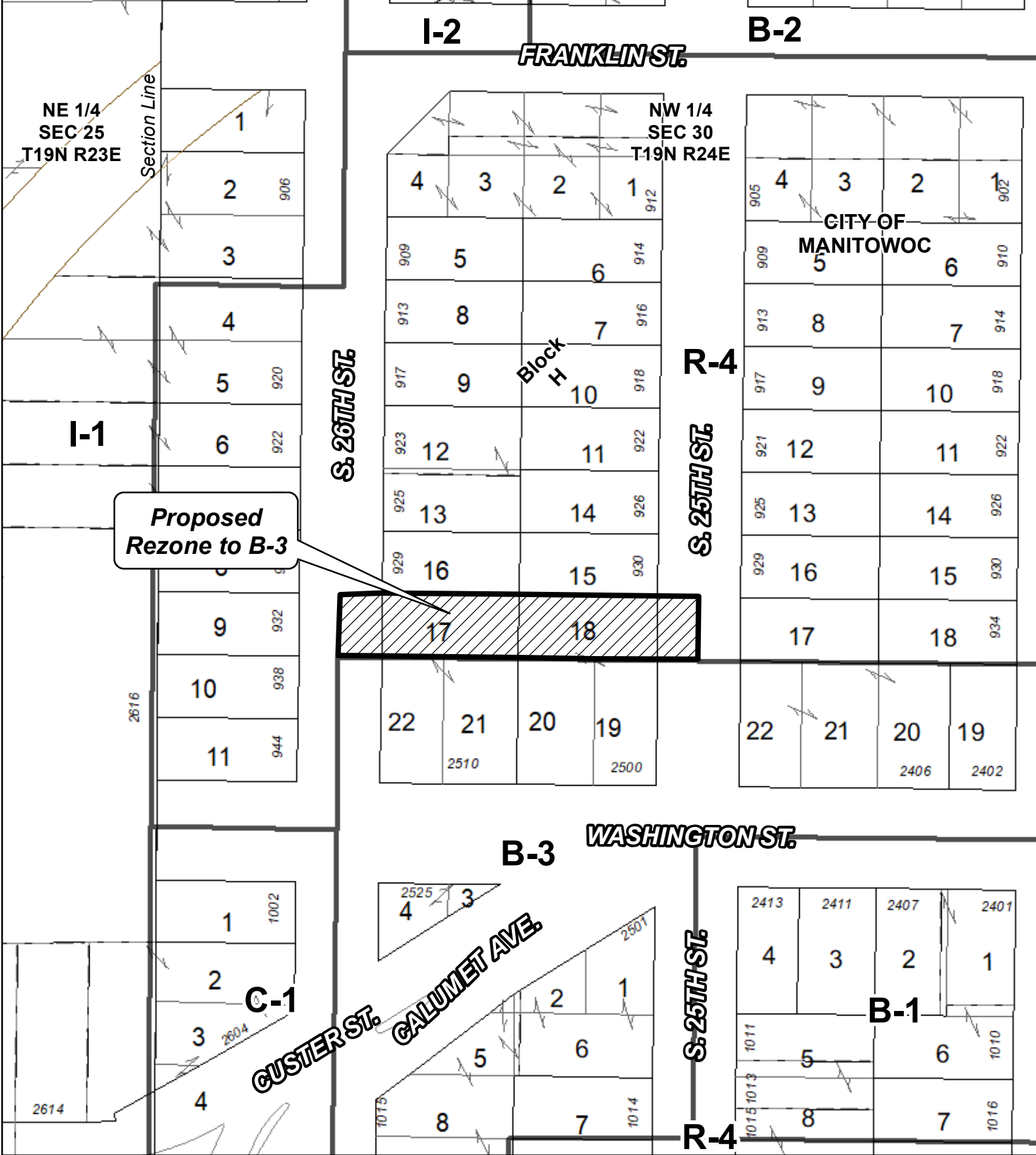

**Proposed
Rezone to B-3**

**Proposed Rezone Property from R-4 Single- and Two-Family District
to B-3 General Business District**

PC 14-2022
2500 Washington St.

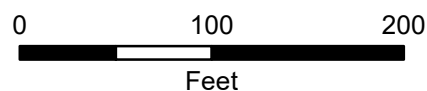

Legend

 **Proposed Rezone**

DISCLAIMER: Maps and associated data are believed to be accurate, but are not warranted. This information is not intended for legal, survey, or other related uses. Please obtain the original recorded documents for legal or survey information.

Prepared by City of Manitowoc
Community Development Department
www.manitowoc.org
Map Plotted: 5/2/2022
O:\Planning\PC Plan Commission\PC_Rezone\2022\PC 14-2022 Briese Properties 2500 Washington Street\Maps\PC 14-2022 Rezone B&W.mxd

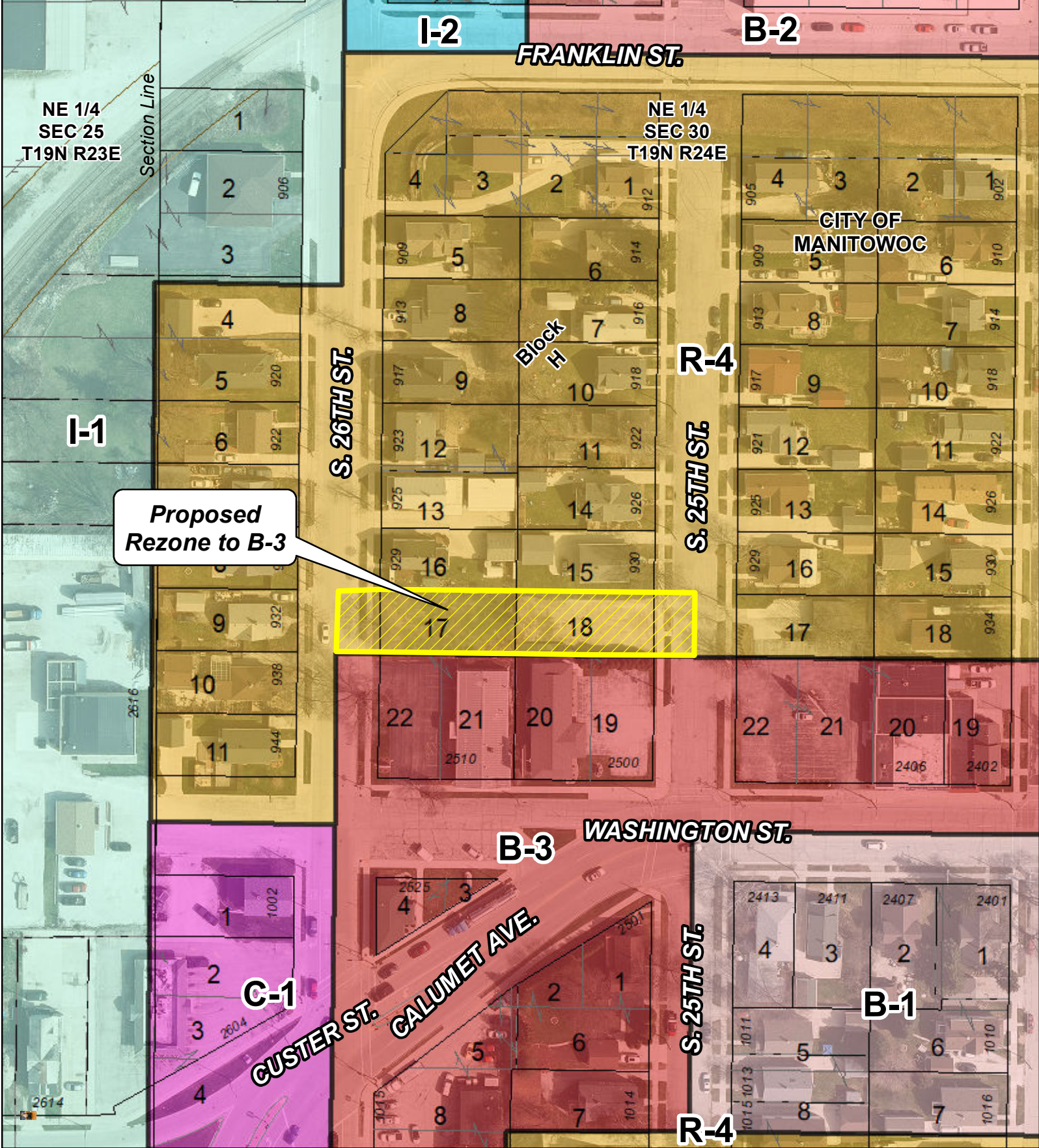

Proposed Rezone to B-3

Proposed Rezone Property from R-4 Single- and Two-Family District to B-3 General Business District

PC 14-2022
2500 Washington St.

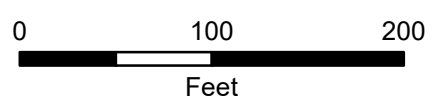

Legend

 Proposed Rezone

DISCLAIMER: Maps and associated data are believed to be accurate, but are not warranted. This information is not intended for legal, survey, or other related uses. Please obtain the original recorded documents for legal or survey information.

Prepared by City of Manitowoc
Community Development Department
www.manitowoc.org
Map Plotted: 5/2/2022
O:\Planning\PC Plan Commission\PC_Rezone\2022\PC 14-2022 Briese Properties 2500 Washington Street\Maps\PC 14-2022 Rezone.mxd