



# CITY OF MANITOWOC

WISCONSIN, USA

[www.manitowoc.org](http://www.manitowoc.org)

May 26, 2022

To: Mayor and Common Council

From: Paul Braun, City Planner

**Subject: PC 16-2022: Wisconsin Aluminum Foundry: Petition to Rezone from R-6 Multiple Family to I-2 Heavy Industrial. Southwest Corner of S. 16<sup>th</sup> and Clark Streets.**

At the May 25, 2022 meeting of the Manitowoc City Plan Commission, the Commission recommended to the Common Council the following action:

***Approve the petition to rezone the subject property from R-6 Multiple Family Residential to I-2 Heavy Industrial.***

Wisconsin Aluminum Foundry  
Attn: Joe Brown  
838 S. 16<sup>th</sup> Street  
Manitowoc, WI 54220

Granicus #: 22-0462  
Attachments: Map & Ordinance

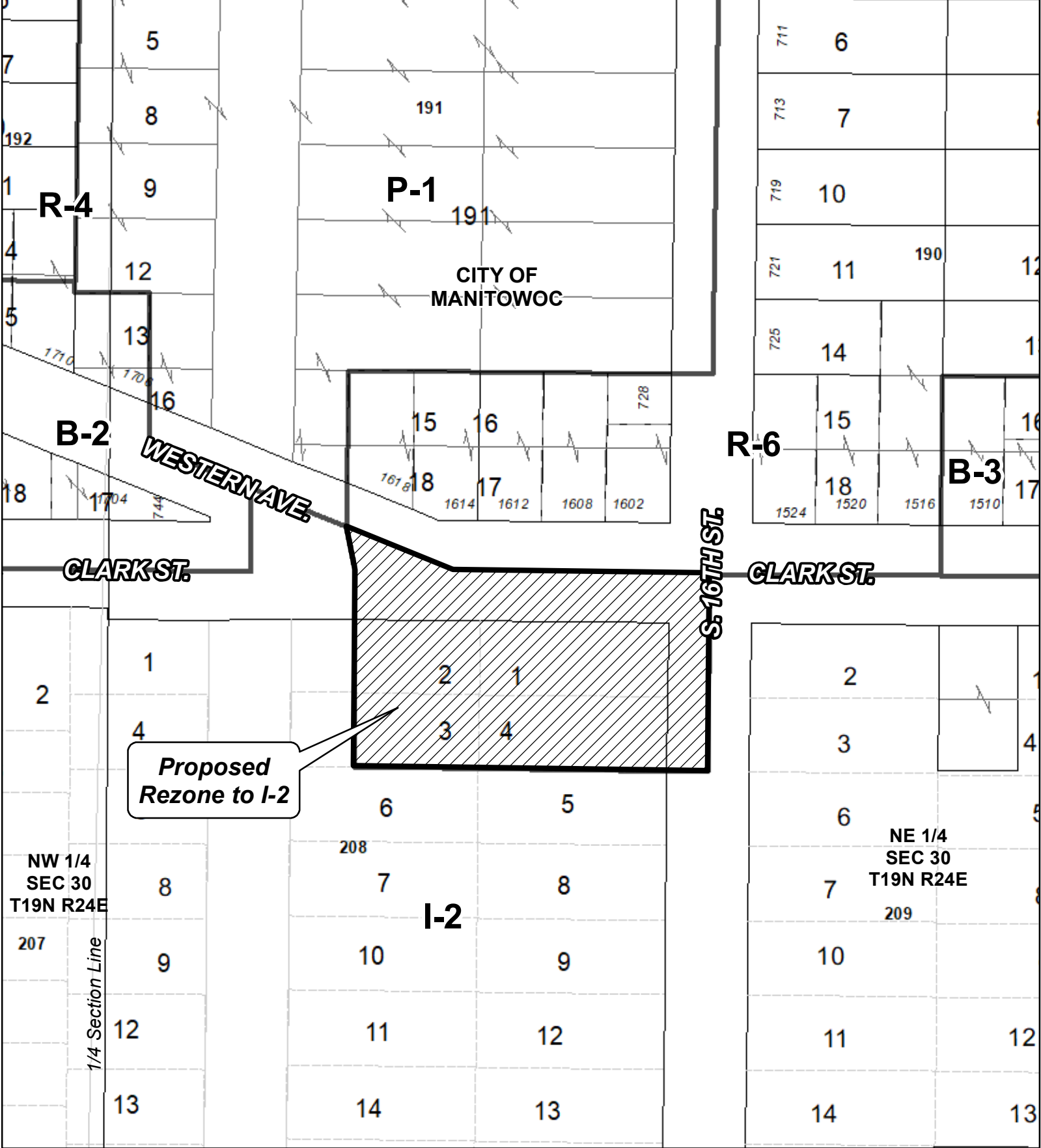

**Proposed Rezone to I-2**

**Proposed Rezone Property from R-6 Multiple-Family District to I-2 Heavy Industrial District**

PC 16-2022

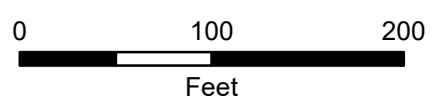

DISCLAIMER: Maps and associated data are believed to be accurate, but are not warranted. This information is not intended for legal, survey, or other related uses. Please obtain the original recorded documents for legal or survey information.

Prepared by City of Manitowoc  
Community Development Department  
www.manitowoc.org

**Legend**

 **Proposed Rezone**

Map Plotted: 5/17/2022  
O:\Planning\PC Plan Commission\PC\_Rezone\2022\PC 16-2022 WAF R-6 to I-2\Maps\PC 16-2022 Rezone B&W.mxd

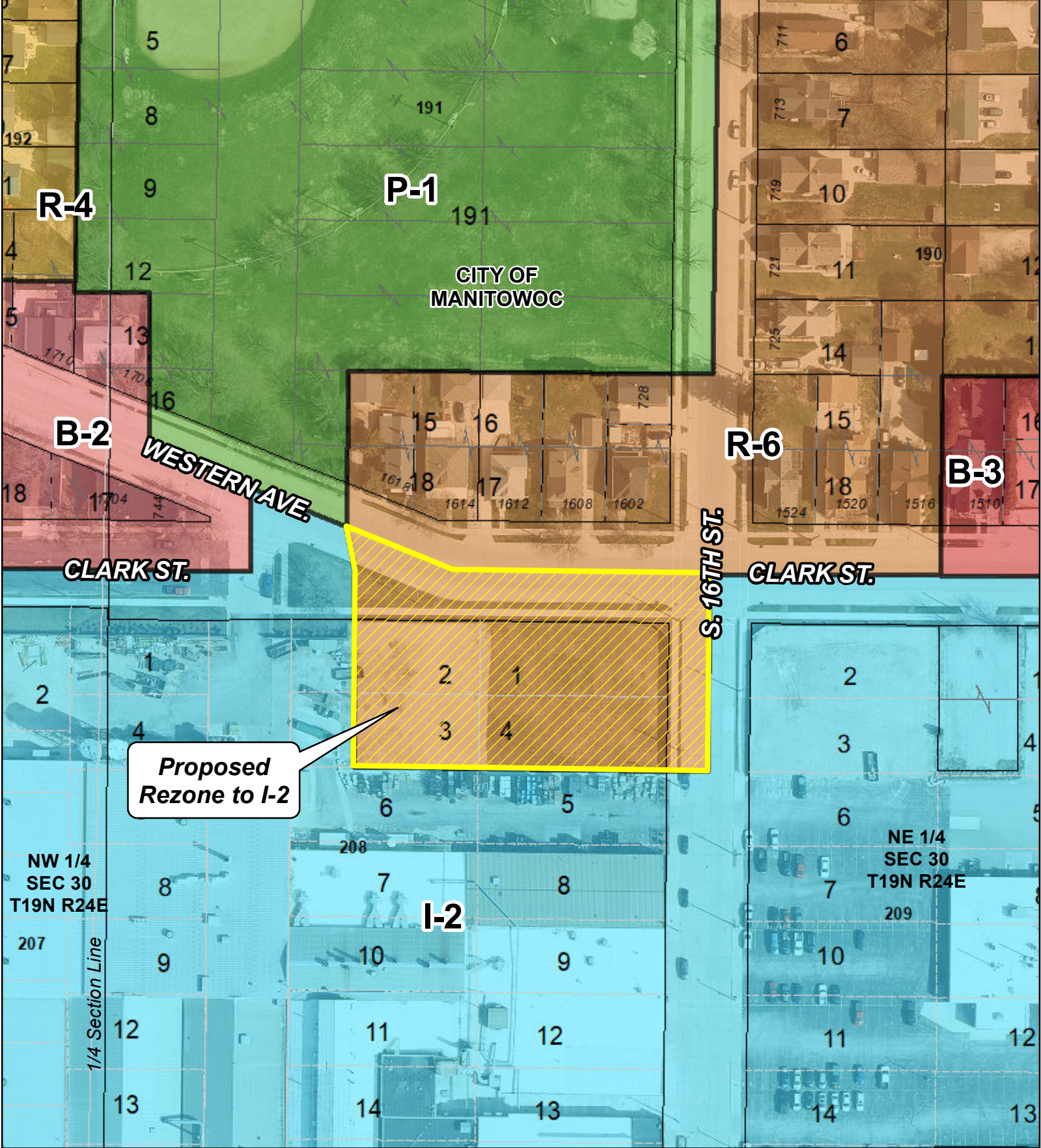

**Proposed Rezone to I-2**

**Proposed Rezone Property from R-6 Multiple-Family District to I-2 Heavy Industrial District**

PC 16-2022

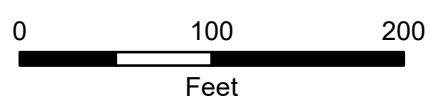

DISCLAIMER: Maps and associated data are believed to be accurate, but are not warranted. This information is not intended for legal, survey, or other related uses. Please obtain the original recorded documents for legal or survey information.

Prepared by City of Manitowoc  
Community Development Department  
www.manitowoc.org  
Map Plotted: 5/17/2022  
O:\Planning\PC Plan Commission\PC\_Rezone\2022\PC 16-2022 WAF R-6 to I-2\Maps\PC 16-2022 Rezone.mxd

**Legend**

 **Proposed Rezone**