

*for permits
& drop
5-19-14*

14-1056

May 12, 2014

City of Manitowoc

900 Quay Street

Manitowoc, WI 54220

RECEIVED
MAY 12 2014
CITY CLERK

RE: Liquor License – Extension to Premise – Manitowoc Yacht Club

Greetings,

The Manitowoc Yacht Club is seeking to extend our Liquor License privilege to the extents of our property located at 815 Maritime Drive. This extension is requested for July 4th 2014 from 8:00AM until 11:00PM for the sale of beer, alcohol, wine and soda from a 20 ft. x 40 ft. tented area located at the east side of the property (please refer to attachment). This extension is requested to provide an outdoor venue for the City of Manitowoc's "Fourth on the Shore" celebration. If you have any questions, please feel free to contact me.

Sincerely,

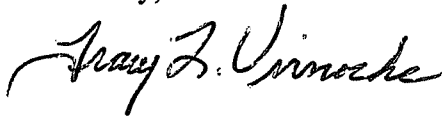

Tracy L. Virnoche

Board of Directors Member

Manitowoc Yacht Club

Home Phone: 686-1576

E-mail: virn5775@sbcglobal.net

LAND SURVEY
 16TH STREET
 WISCONSIN 5422
 920-682-0498B

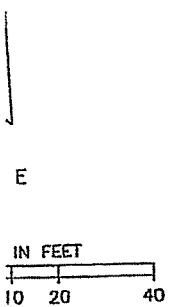

LINE OF MARITIME DRIVE ESTABLISHED
 AGE CENTERLINE OF EXISTING PAVEMENT
 CALLED FOR RADIUS OF CURVES

AVERAGE CENTERLINE
 OF EXISTING PAVEMENT
 I = 27°15'40"
 R = 694.49'
 A = 330.44'
 CH = 327.33'
 N11°28'02"E

I = 27°15'40"
 R = 734.49'
 A = 349.47'
 CH = 345.15'
 N11°28'02"E

MONUMENTED
 IE OF HURON
 PER C.S.M.
 G. 29

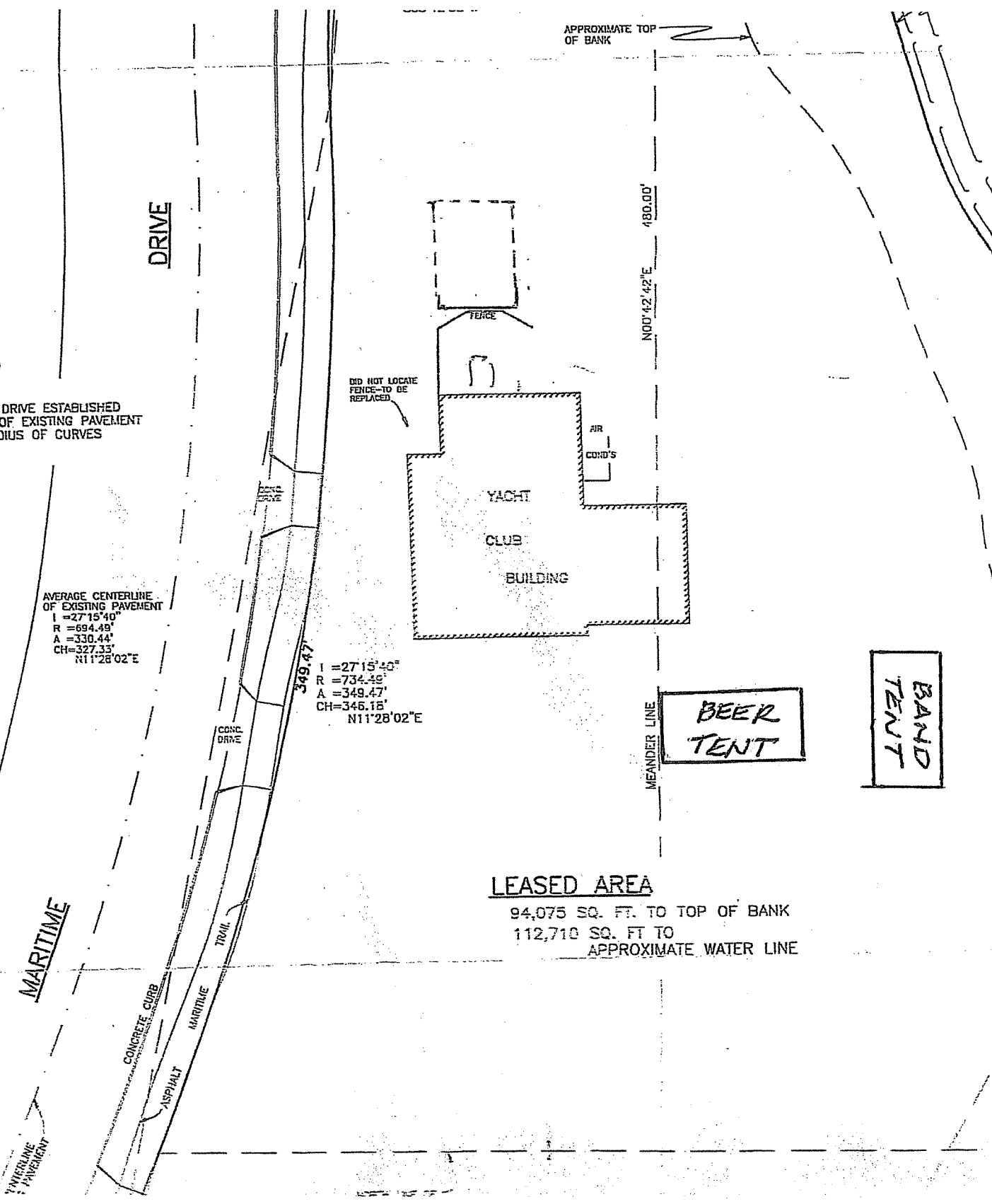

LEASED AREA

94,075 SQ. FT. TO TOP OF BANK
 112,710 SQ. FT. TO
 APPROXIMATE WATER LINE