



CITY OF MANITOWOC
WISCONSIN, USA
www.manitowoc.org



May 28, 2019

To: Mayor and Common Council

From: Paul Braun, City Planner

Subject: PC 21-2019: Strharsky, Discussion and Possible Action for a Change in Zoning from R-1 Residential - Agricultural to R-4 Single and Two Family Residential located south of Homestead Road and east of Knuell Street.

At the May 22, 2019 meeting of the Manitowoc City Plan Commission, the Commission recommended to the Common Council the following action:

Approve the Amendment to the Zoning Map from R-1 Residential – Agricultural to R-4 Single and Two Family Residential.

Granicus #: 19-0588

Attachments: Zoning Map
Ordinance

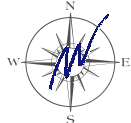
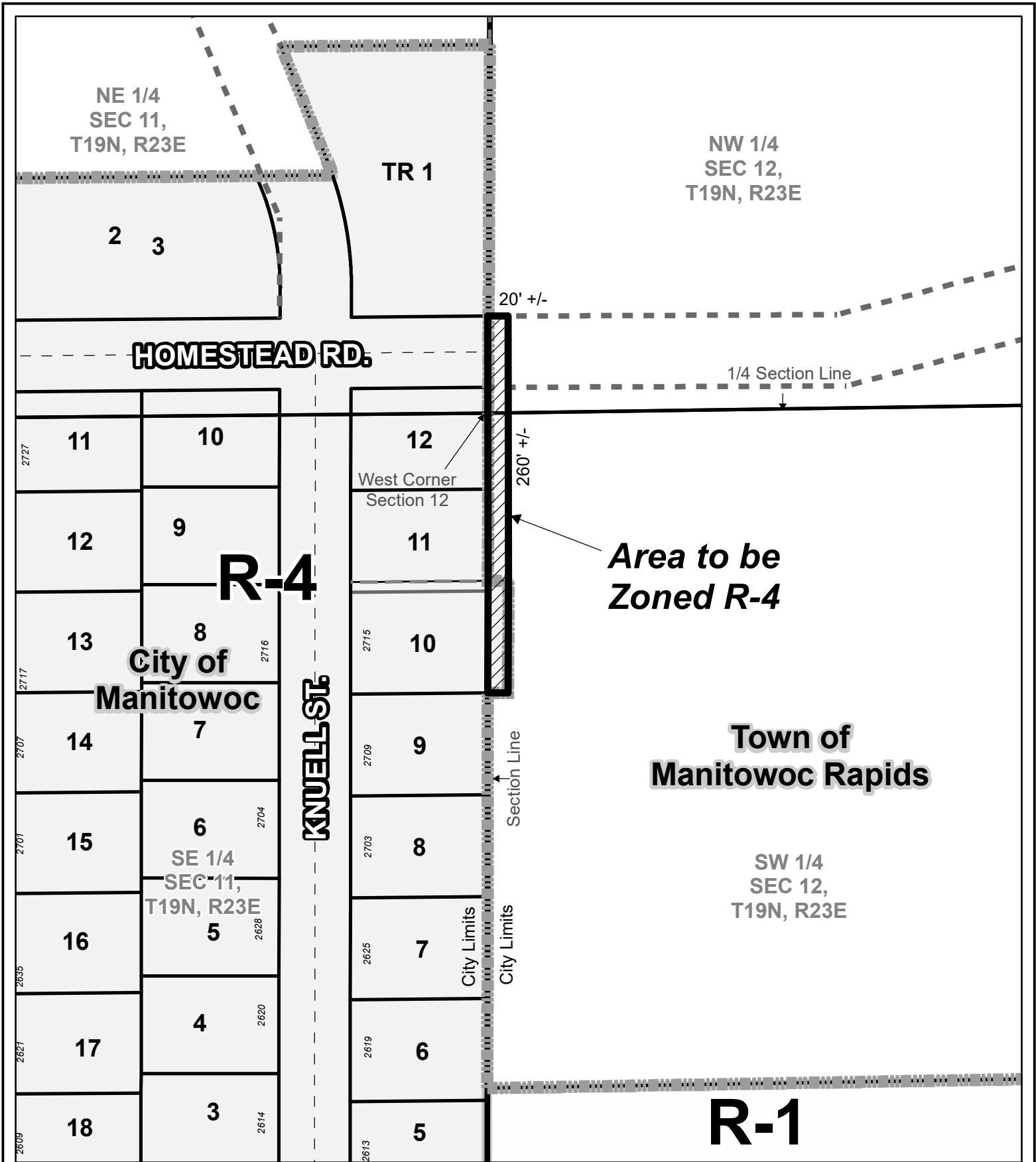

DISCLAIMER: Maps and associated data are believed to be accurate, but are not warranted. This information is not intended for legal, survey, or other related uses. Please obtain the original recorded documents for legal or survey information.

Prepared by City of Manitowoc
Community Development Department
www.manitowoc.org
Map Plotted: 5/29/2019

Document Path: Y:\Planning\PC Plan Commission\PC_Rezone\PC 21-2019 Strharsky Annexation Rezone R-1 to R-4\Maps\PC 21-2019 Rezone.mxd

Change in Zoning

City of Manitowoc, WI

Area To Be Zoned From R-1 Residential - Agriculture to R-4 Single & Two-Family

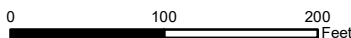

PC 21-2019 Annexation

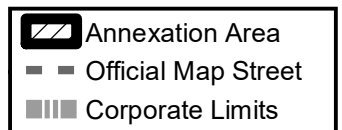

ORDINANCE

An Ordinance amending the amended zone map of the City of Manitowoc entitled:
"Zoning Ordinance of the Municipal Code of the City of Manitowoc".

The Mayor and Common Council of the City of Manitowoc do ordain as follows:

SECTION 1: Section 15.050 of the amended zone map of the City of Manitowoc is amended to provide that: a tract of land located in the SW 1/4 of the NW 1/4 and the NW 1/4 of the SW 1/4 all in Section 12, Township 19 North, Range 23 East, in the City of Manitowoc, Manitowoc County, Wisconsin being generally located south of Homestead Road and east of Knuell Street to be changed from "R-1" Residential – Agricultural District to "R-4" Single and Two Family Residential District, all according to attached Exhibit "A".

SECTION 2: This Ordinance shall be in full force and effect the day after its publication.

INTRODUCED _____

ADOPTED _____

APPROVED _____

JUSTIN M. NICKELS, MAYOR

Fiscal Impact: N.A.

Funding Source: N.A.

Finance Director Approval: /sc

Approved as to Form: /