



**CITY OF MANITOWOC**  
WISCONSIN, USA  
[www.manitowoc.org](http://www.manitowoc.org)



August 31, 2017

**To:** Mayor and Common Council

**From:** Manitowoc City Plan Commission

**Subject:** PC 23-2017: Wisconsin Aluminum Foundry; Petition to Rezone from “R-4” Single and Two Family Residential to “I-2” Heavy Industrial for properties along the east side of the 800 hundred block of S. 18th Street and the south side of the 1700 hundred block of Clark Street.

Dear Mayor and Common Council:

At the August 30, 2017 meeting of the Manitowoc City Plan Commission, the Commission considered all items on its agenda, including the item identified above, and wishes to report and recommend to the Common Council the following actions: to approve a change in zoning from “R-4” Single and Two Family Residential District to the “I-2” Heavy Industrial District for the area shown on the attached map and instruct the City Clerk to schedule a public hearing for the October 16, 2017 Common Council meeting.

Respectfully Submitted,

Paul Braun  
Plan Commission Secretary

Attachment: Map  
Granicus # 17-0879

Wisconsin Aluminum Foundry  
Attn: Kory Brockman  
838 S. 16<sup>th</sup> Street  
Manitowoc, WI 54220

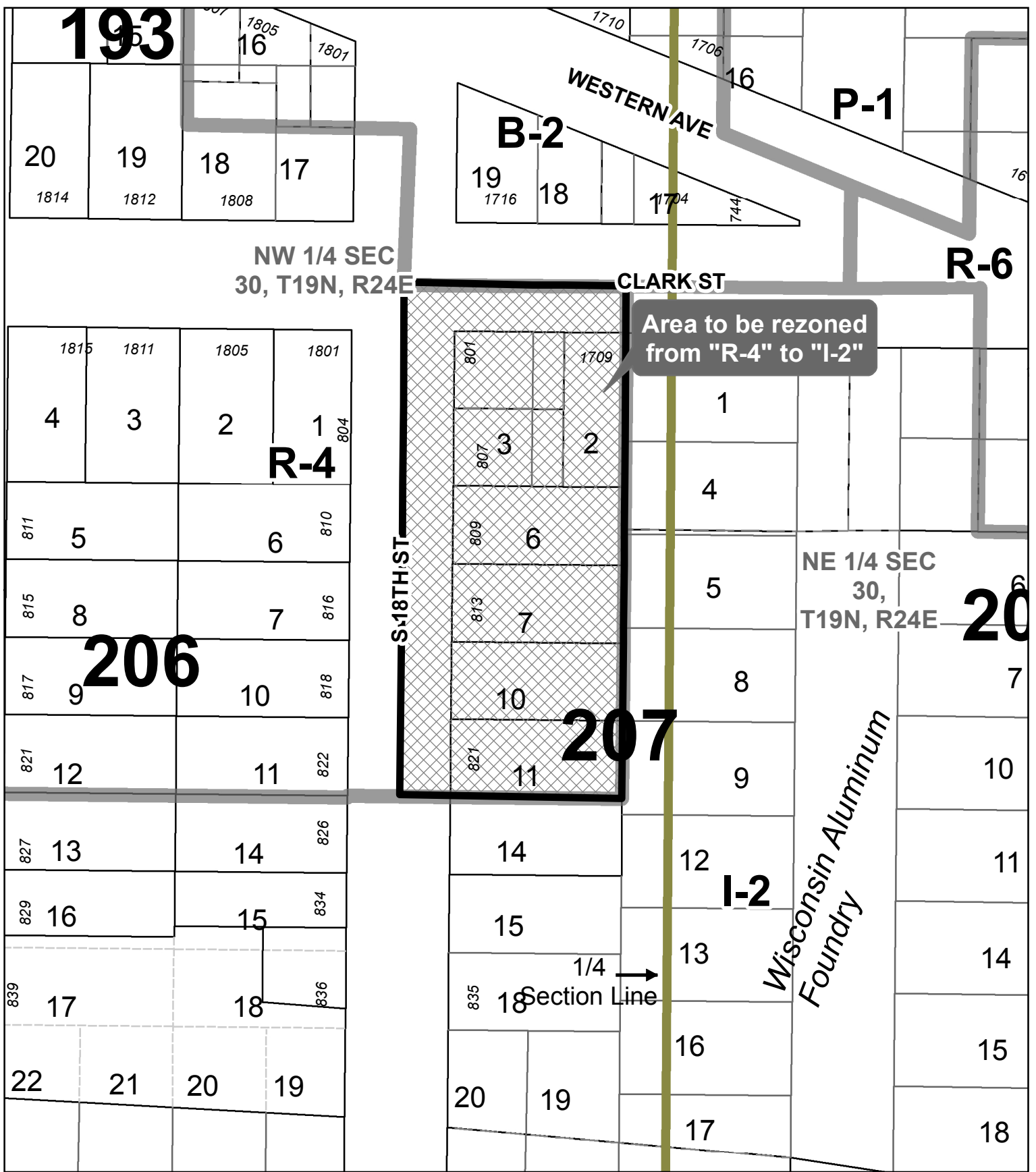

Request to Rezone Property from  
 "R-4" Single and Two Family Residential  
 to "I-2" Heavy Industrial

PC 23-2017

Prepared by City of Manitowoc  
 Planning Department  
 www.manitowoc.org  
 Map Plotted: 08/23/2017  
 Y:\Planning\PC Plan Commission\Actions 2017\PC 23-2017 WAF Rezone R-4 to I-2

0 20 40 80



Feet

Legend



Area of Request for  
 Rezone

DISCLAIMER: Maps and associated data are believed to be accurate, but are not warranted. This information is not intended for legal, survey, or other related uses. Please obtain the original recorded documents for legal or survey information.

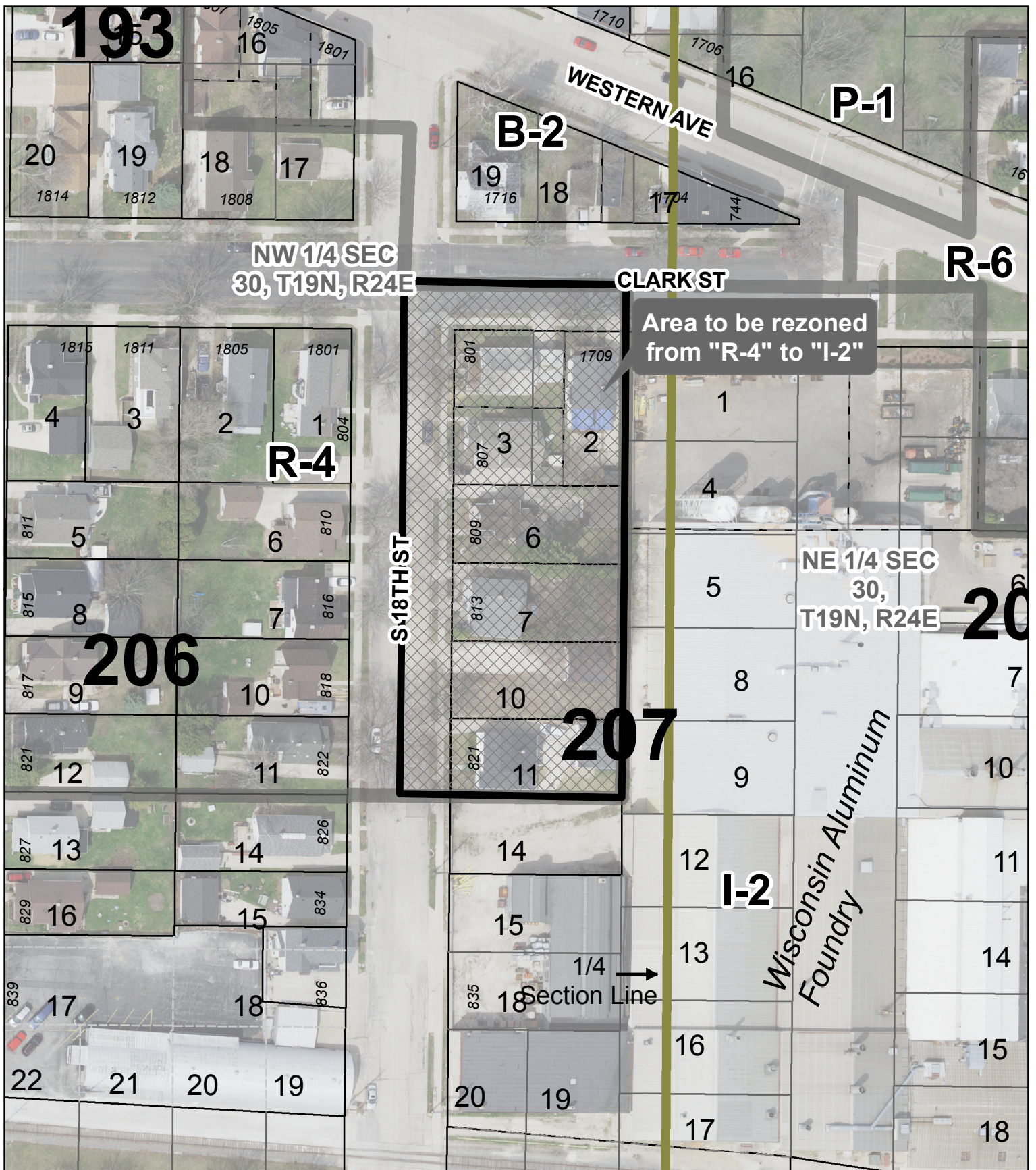

Request to Rezone Property from  
 "R-4" Single and Two Family Residential  
 to "I-2" Heavy Industrial

PC 23-2017



Prepared by City of Manitowoc  
 Planning Department  
 www.manitowoc.org  
 Map Plotted: 08/23/2017  
 Y:\Planning\PC Plan Commission\Actions 2017\PC 23-2017 WAF Rezone R-4 to I-2

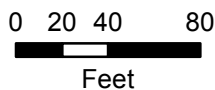

**Legend**

 Area of Request for Rezone

DISCLAIMER: Maps and associated data are believed to be accurate, but are not warranted. This information is not intended for legal, survey, or other related uses. Please obtain the original recorded documents for legal or survey information.