

COW
1-18-16

16-0018

AMENDED ORDINANCE

An Ordinance to annex certain territory from the Town of Manitowoc Rapids to the City of Manitowoc as part of the 10th Aldermanic District and the 19th and 20th Wards of the City.

WHEREAS, the petition to annex the territory described below has been filed with the City of Manitowoc; and

WHEREAS, the petition meets the requirements of Wisconsin Statute Section 66.0217(2); and

WHEREAS, the Manitowoc Common Council has determined that the City has reasonable need for the property and it is in the best interest of the petitioners, the residents and owners of property in the area to be annexed and the City of Manitowoc to annex the property to the City; and

WHEREAS, the Common Council has reviewed the recommendations of the Wisconsin Department of Administration pursuant to Wisconsin Statute Section 66.0217(6)(a); and

NOW, THEREFORE, the Mayor and Common Council of the City of Manitowoc do ordain as follows:

SECTION 1. Territory Annexed. Pursuant to Wisconsin Statute Section 66.0217(8), the following described territory in the Town of Manitowoc Rapids, Manitowoc County, Wisconsin is hereby annexed to the City of Manitowoc:

Due to a scrivener's error in the legal description provided to the City the legal description has been amended. Text *italicized and underlined* is added and text in ~~strikeout~~ is to be deleted in this Amended Ordinance.

This ordinance amends Ordinance #15-1196 which was recorded on December 7, 2015 in the Manitowoc County Register of Deeds Office and filed in Volume 2980 Page 191, Document #1163060.

DESCRIPTION

A tract of land located in the North One-half (N1/2) of the Northwest Quarter (NW1/4) of the Southwest Quarter (SW1/4) of Section Numbered Twelve (12), Township Numbered Nineteen (19) North, Range Numbered Twenty-three (23) East, Town of Manitowoc Rapids, Manitowoc County, Wisconsin and described as follows:

Commencing at the West ¼ corner of said Section 12; thence S. 00° 04' 02" W. along the section line 164.90 feet to the point of real beginning; thence continue S. 00° 04' 02" W. (recorded as South) 10 feet to the northwest ~~northwest~~ northeast corner of Lot 10, Block 8, Royal Oaks Subdivision No. 3, ~~the point of real beginning~~; thence continue S. 00° 04' 02" W. (recorded as South) along said section line and lot line 140.0 100.0 feet to the southeast corner of said Lot 10; thence N. 89° 29' 36" E. (recorded as East) 20.0 feet; thence N. 00° 04' 02" E. (recorded as North) 110.0 feet; thence S. 89° 29' 36" W. (recorded as West) 20.0 feet to the point of real beginning.

Said described area contains 2,200 square feet or 0.05 acres of land more or less.

SECTION 2. Aldermanic District and Ward. The territory herein described is made part of the 10th Aldermanic District and 27th Ward of the City of Manitowoc:

SECTION 3. Zone District Classification. The territory annexed is classified as "R-4" Single and Two Family Residential, all according to the attached map.

SECTION 4. Two Thirds Vote. Passage of this Ordinance requires a two thirds vote of the elected members of the Common Council.

SECTION 5. Effective Date. This Ordinance shall take effect on the day after its publication.

INTRODUCED **JAN 18 2016**

ADOPTED _____

APPROVED _____

JUSTIN M. NICKELS, MAYOR

Fiscal Impact: N.A.
Funding Source: N.A.
Finance Director Approval: sc 11/5/2015
Approved as to form:

Drafted by: Paul Braun, City Planner
Y:\Planning\PC Plan Commission\Actions 2015\PC33-2015 Northwest #19 Strharsky Annexation\Ordinance Resolution Northwest 19 _ AMENDED.doc

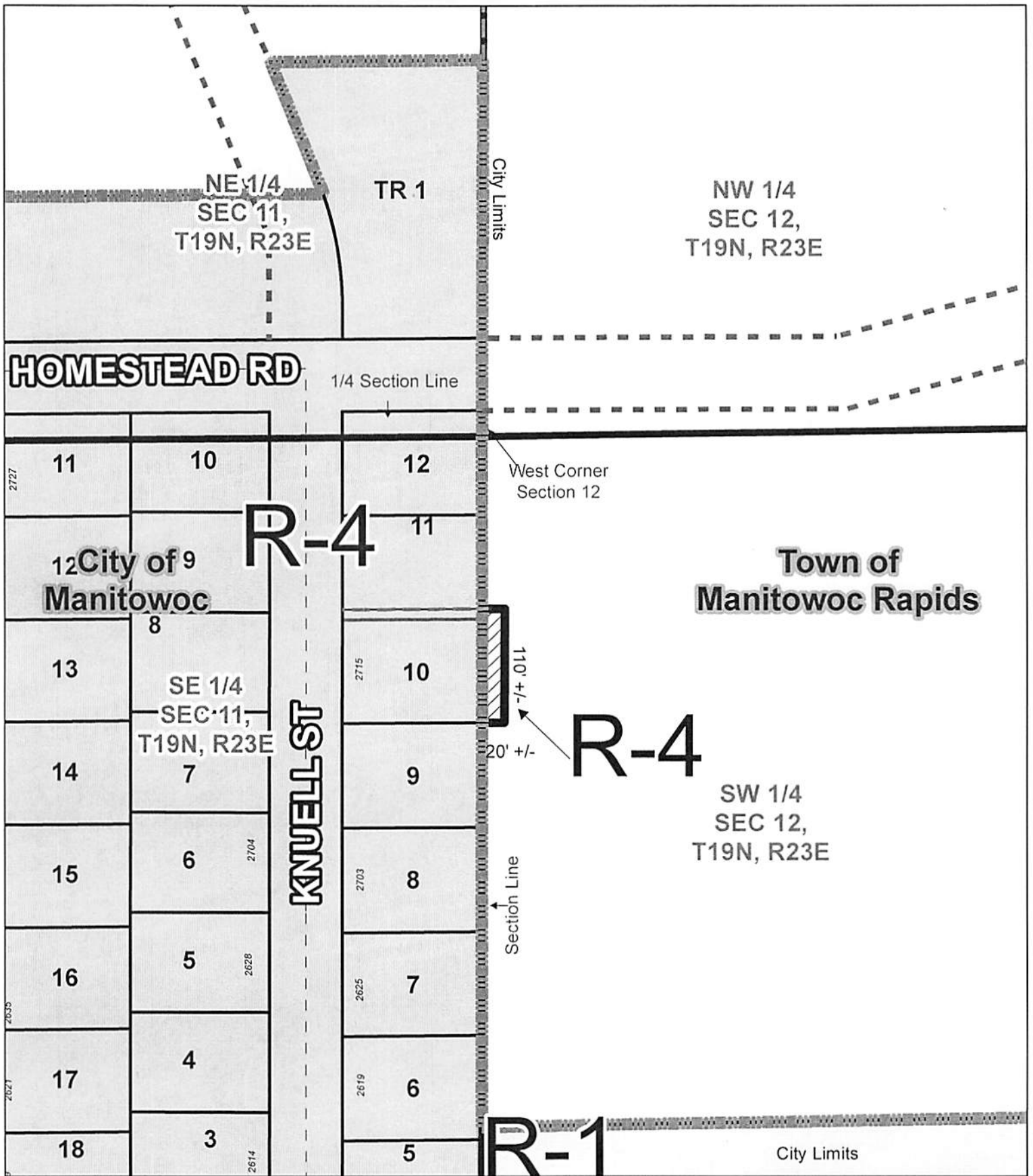

Prepared by City of Manitowoc
 Planning Department
 www.manitowoc.org
 Map Plotted: 10/21/2015

Y:\Planning\PC Plan Commission\Actions 2015\PC33-2015 Northwest #19 Sbarsky Annexation
 DISCLAIMER: Maps and associated data are believed to be accurate, but are not warranted. This information is not intended for legal, survey, or other related uses. Please obtain the original recorded documents for legal or survey information.

Northwest #19 Annexation Map
 City of Manitowoc, WI
Area To Be Zoned "R-4"
Single and Two Family District

PC33-2015 Annexation;
 2715 Knuell St.

- Official Map Street
- Corporate Limits
- Annexation Property

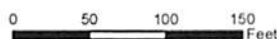

Aldermanic District 10

TR 1 **Ward 27**

NE 1/4
SEC 11,
T19N, R23E

NW 1/4
SEC 12,
T19N, R23E

**HOMESTEAD
RD**

KNUELL ST

West Corner
Section 12

1/4 Section Line

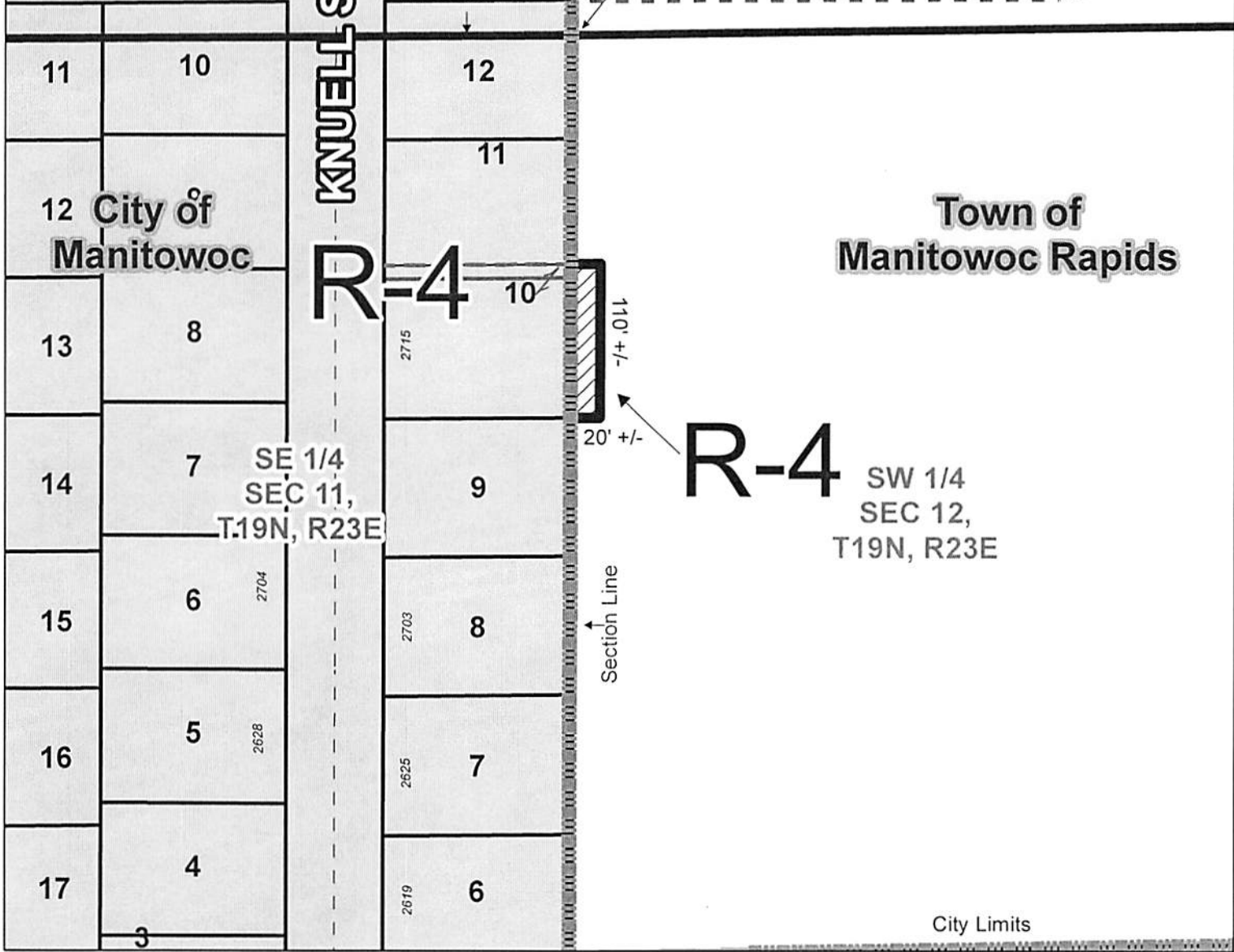

11 10

12

12 City of
Manitowoc

R-4

11

**Town of
Manitowoc Rapids**

13 8

10

110' +/-

14 7

SE 1/4
SEC 11,
T.19N, R23E

9

R-4 SW 1/4
SEC 12,
T19N, R23E

20' +/-

15 6

2704

2715

Section Line

16 5

2628

2703

8

17 4

2625

7

2619

6

City Limits

Northwest #19 Annexation Map

City of Manitowoc, WI

Ward = 27

Population = 0

PC33-2015 Annexation;
2715 Knuell St.

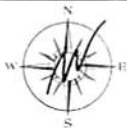

Prepared by City of Manitowoc
Planning Department
www.manitowoc.org
Map Plotted: 10/21/2015

Y:\Planning\PC Plan Commission\Actions 2015\PC33-2015 Northwest #19 Sbarsky Annexation
DISCLAIMER: Maps and associated data are believed to be accurate, but are not
warranted. This information is not intended for legal, survey, or other related uses.
Please obtain the original recorded documents for legal or survey information.



- Official Map Street
- Corporate Limits
- Annexation Property