

LPI
5-19-14

14-1106

ORDINANCE

An Ordinance amending the amended zone map of the City of Manitowoc entitled:
"Zoning Ordinance of the Municipal Code of the City of Manitowoc".

The Mayor and Common Council of the City of Manitowoc do ordain as follows:

SECTION 1: Section 15.05 of the amended zone map of the City of Manitowoc is amended to provide that: a tract of land located in the SW 1/4 of the SW 1/4, of Section 13, Township 19 North, Range 23 East, in the City of Manitowoc, Manitowoc County, Wisconsin being located North of Waldo Boulevard, east of N. Rapids Road and south of Lancer Circle to be changed from "R-2" Single-Family Residential District to "I-1" Light Industrial District, all according to attached Exhibit "A".

SECTION 2: This Ordinance shall be in full force and effect the day after its publication.

INTRODUCED MAY 19 2014

ADOPTED _____

APPROVED _____

JUSTIN M. NICKELS, MAYOR

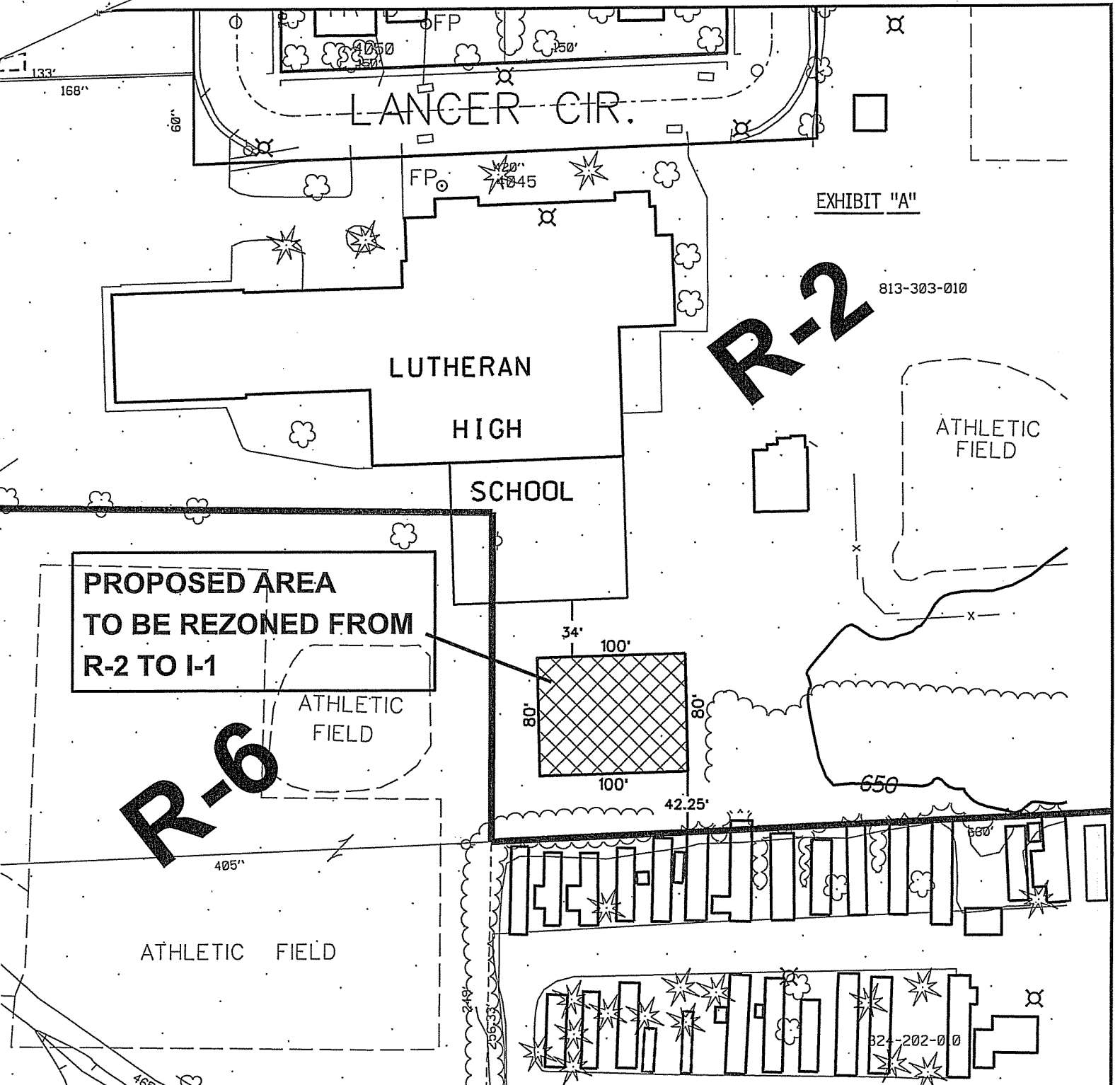

CHANGE IN ZONING

CITY OF MANITOWOC, WI



**TO BE REZONED FROM "R-2"
SINGLE FAMILY RESIDENTIAL
TO "I-1" LIGHT INDUSTRIAL**

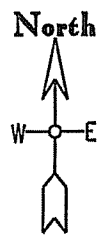

MANITOWOC CITY PLAN COMMISSION

P.C. 23-2013

MAY 2014