

Plan Comm.  
9-18-17

**ORDINANCE**

An Ordinance amending the amended zone map of the City of Manitowoc entitled:  
"Zoning Ordinance of the Municipal Code of the City of Manitowoc".

The Mayor and Common Council of the City of Manitowoc do ordain as follows:

**SECTION 1:** Section 15.050 of the amended zone map of the City of Manitowoc is amended to provide that: a tract of land located in the SE ¼ of the NW ¼, the NE ¼ of the NW ¼, the NW ¼ of the NE ¼ and SW ¼ of the NE ¼ all in Section 30, Township 19 North, Range 24 East, in the City of Manitowoc, Manitowoc County, Wisconsin being generally located East of S. 18<sup>th</sup> Street and South of Clark Street to be changed from "R-4" Single and Two Family District to "I-2" Heavy Industrial District, all according to attached Exhibit "A".

**SECTION 2:** This Ordinance shall be in full force and effect the day after its publication.

**SEP 18 2017**

**INTRODUCED** \_\_\_\_\_

**ADOPTED** \_\_\_\_\_

**APPROVED** \_\_\_\_\_

\_\_\_\_\_  
**JUSTIN M. NICKELS, MAYOR**

**Fiscal Impact:** 0  
**Funding Source:** N.A.  
**Finance Director Approval:** sc  
**Approved as to Form:** km

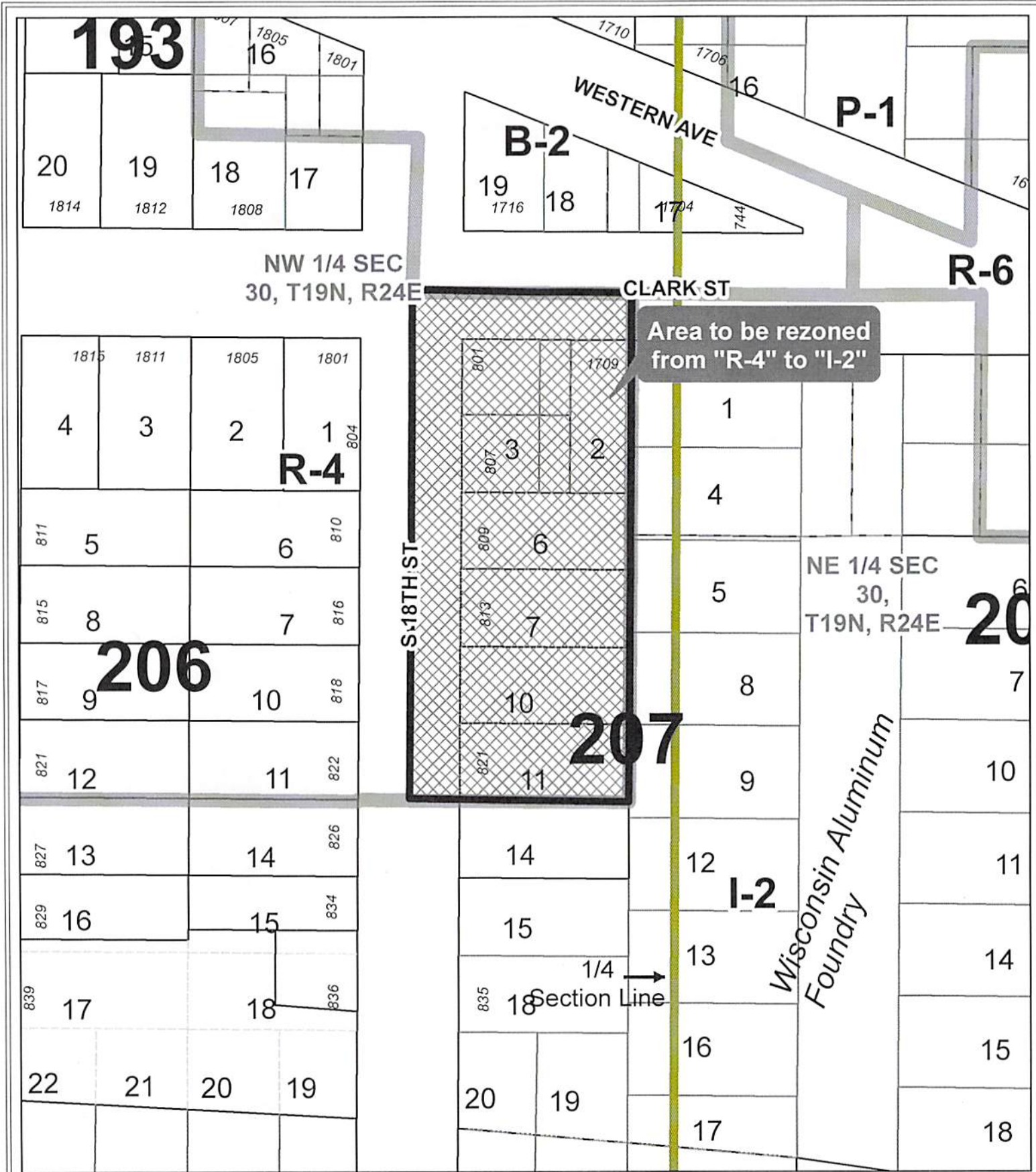

Request to Rezone Property from  
 "R-4" Single and Two Family Residential  
 to "I-2" Heavy Industrial

PC 23-2017



Prepared by City of Manitowoc  
 Planning Department  
 www.manitowoc.org  
 Map Plotted: 08/23/2017  
 Y:\Planning\PC Plan Commission\Actions 2017\PC 23-2017 WAF Rezone R-4 to I-2

0 20 40 80



Feet

Legend



Area of Request for  
 Rezone

DISCLAIMER: Maps and associated data are believed to be accurate, but are not  
 warranted. This information is not intended for legal, survey, or other related uses.  
 Please obtain the original recorded documents for legal or survey information.