



# Henry Schuette Park Playground

Public Infrastructure Meeting  
06/04/2025

Ingenuity, Integrity,  
and Intelligence.

[www.AyresAssociates.com](http://www.AyresAssociates.com)

# PROJECT INTRODUCTION

Henry Schuette Playground is a beloved, community-built icon. Due to material and safety concerns, as well as mounting maintenance costs, the City of Manitowoc is developing a master plan for Schuette Park. The following is a preview of the Core team-led process to envision the park's future while respecting its history.

# Schedule

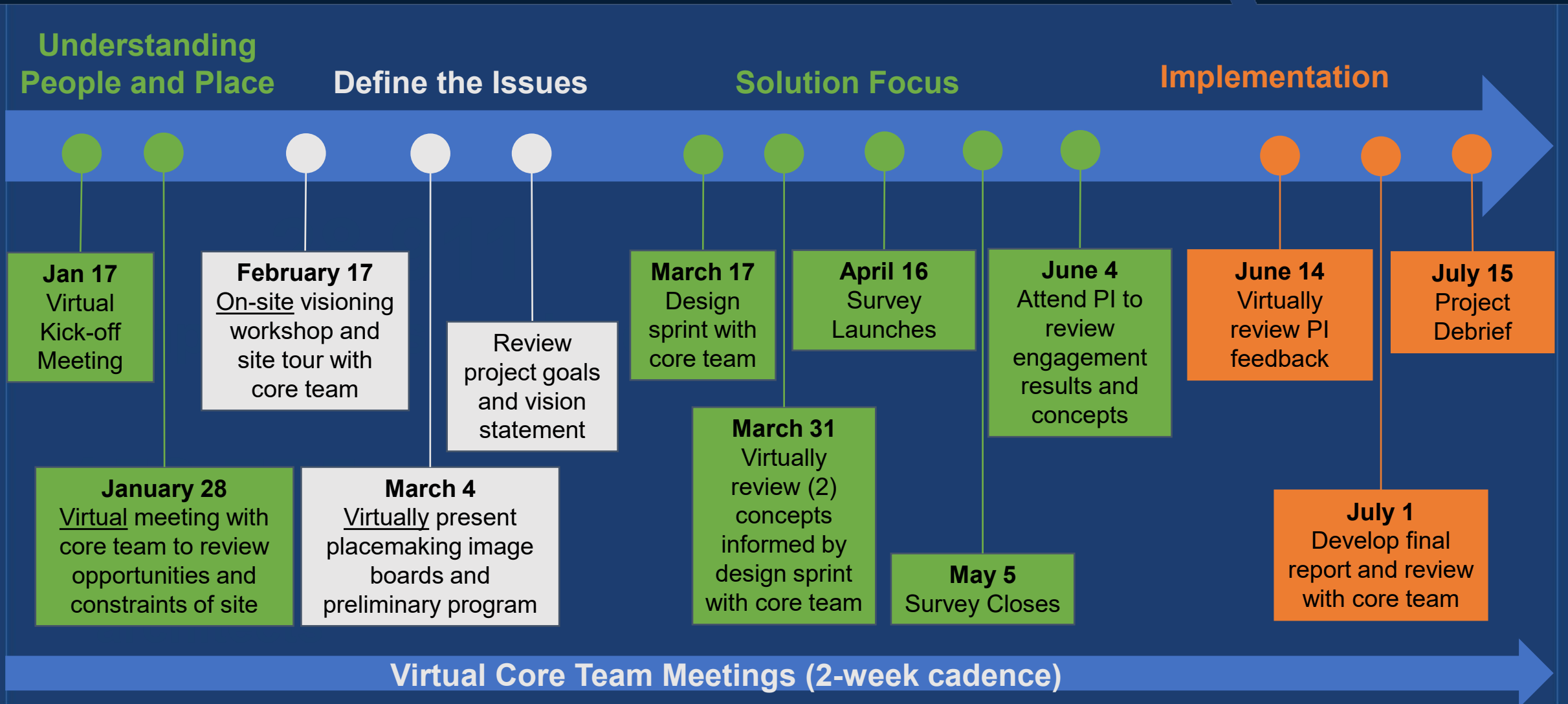

# Schedule

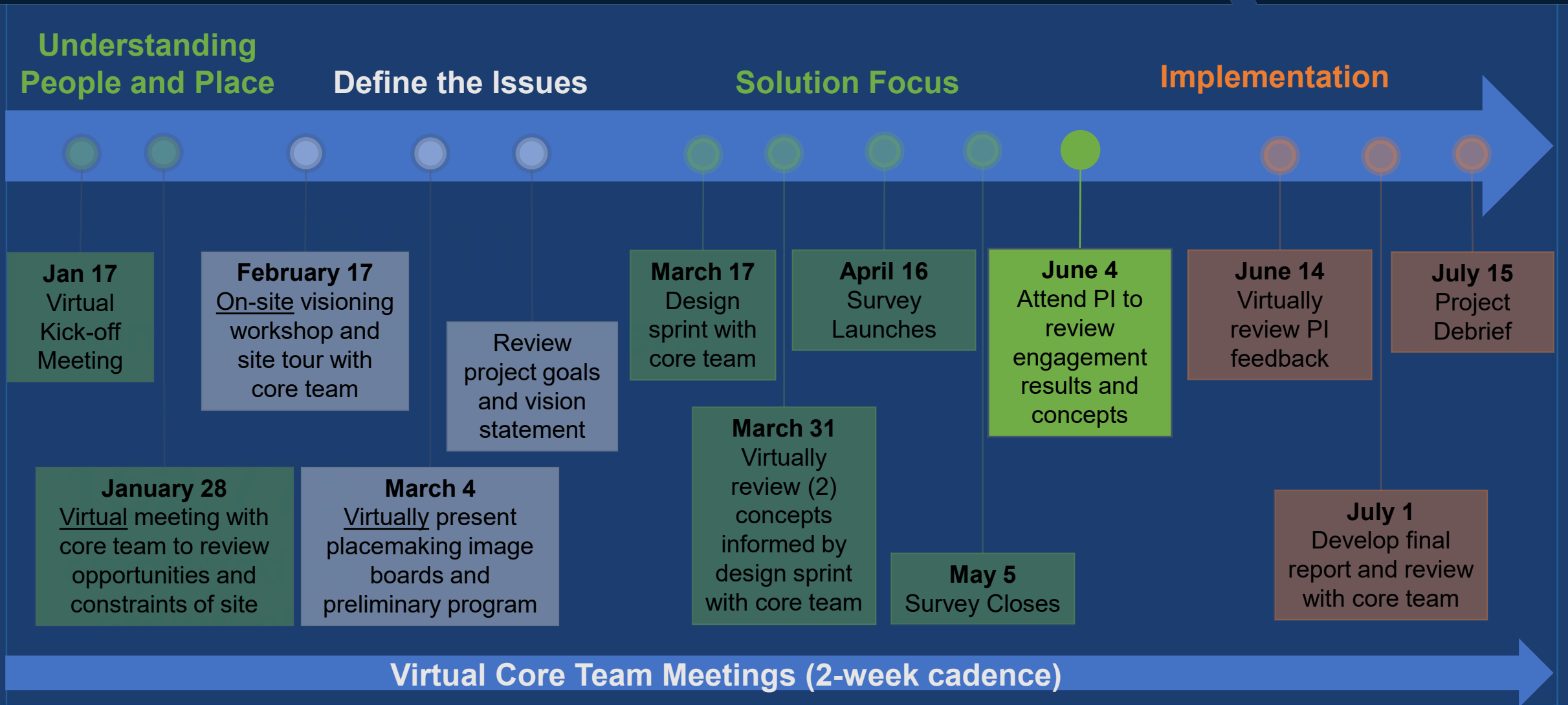



# Introductions – Our Team



**Chris Silewski**  
Project Lead



**Paige Bernhardt**  
Landscape Architect



**Alissa Santurri**  
Project Manager

# Introductions – Core Team



**Brock Wetenkamp**  
Parks Planner



**Curtis Hall**  
Park and Rec Manager

## Core Team

Katilin Piazza

Erin Nycz

Stacey Eck

Jeff Yax

Kevin Sonnenberg

Sandy Ronski

# PROJECT OVERVIEW

---



# Context

The Henry Schuette Park Playground sits in a unique location in Upper Henry Schuette Park:

- Connects two neighborhoods
- Located at an Ice Age Trail trailhead
- Along the railway corridor





# Site

➤ This community-built playground is approximately 20 years old:

- 19,000 sq.ft.
- Loose rubber chip surface
- Treated lumber structure
- Sits on sloping grades
- Includes restroom structure
- Rich, community involved history



# Inventory & Analysis Maps

---



# Contextual Inventory

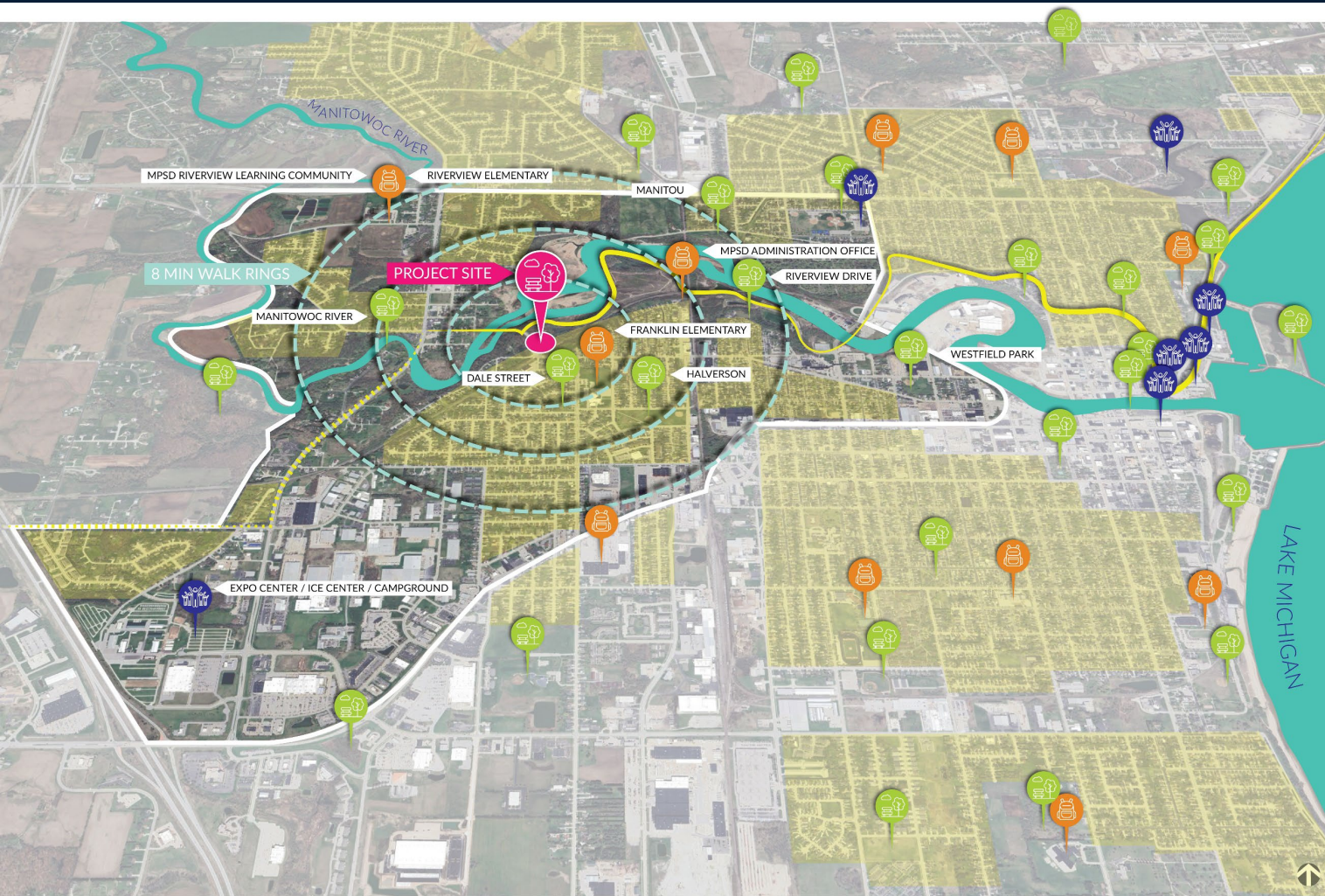

HENRY SCHUETTE PARK | CONTEXT INVENTORY

## Symbol type & Concentration in Project Boundary



Education - 3



Park - 5



Community - 1



Project site



# Site Inventory

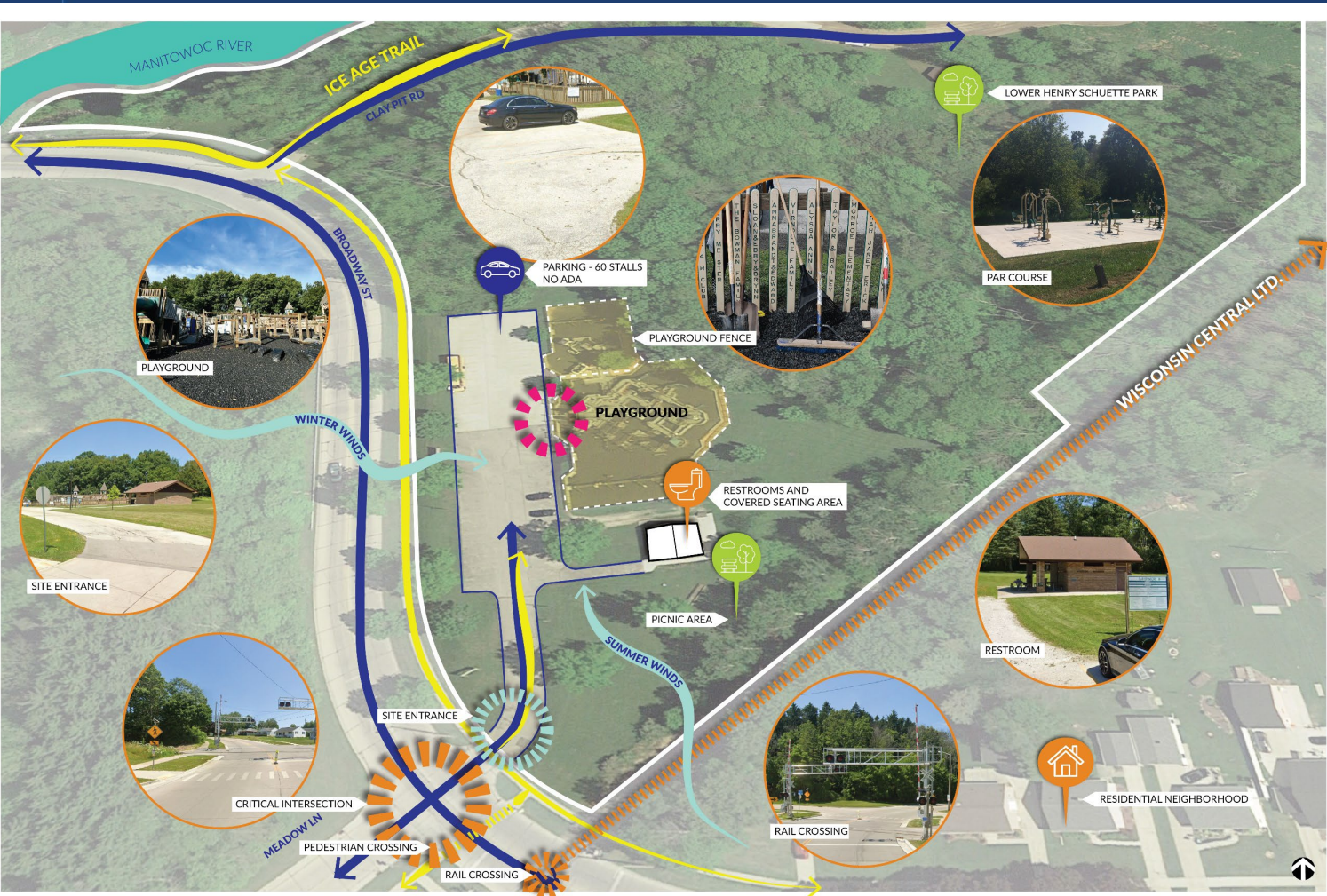

HENRY SCHUETTE PARK | SITE INVENTORY

Manitowoc, WI | 01.28.2025

## Legend

-  Wind Direction
-  Railroad
-  Ice Age Trail
-  Roadways
-  Playground Entry
-  Site Entry
-  Conflict Point



# Playground Inventory



**Equipment Types**

**Existing and Missing Connections**

**Entry points**



# Site Visit

- Traffic experience confirmed our findings in the inventory and analysis phase of the project. Traffic calming and wayfinding must be used in tandem to provide safe access to the park.
- Current amenities are 'park-like' and do not adhere the vision indicated by the Core Team.





# Site Visit

- The playground contains a unique story, themed by play structures that integrate the history of Manitowoc.



# Visioning

---



# VISION AND VALUES

Along with biweekly Core Team meetings, Ayres conducted an on-site visioning workshop. This workshop takes place prior to design to establish the community vision for the park and the values that the design will adhere to.

This process guides every decision that the design team makes moving forward, to make sure we stay in alignment with the project leadership and the priorities of the community.

# Visioning Session

- A visioning session took place on February 17 to gain identify themes and community wants to help inform the Vision Statement and Values that guide the project

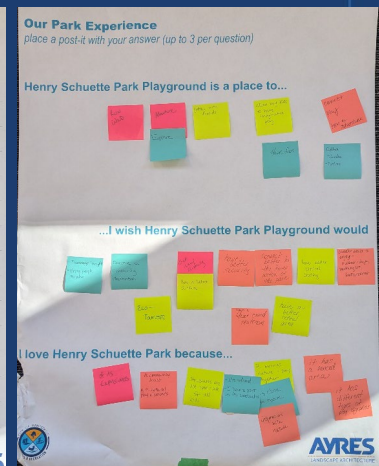
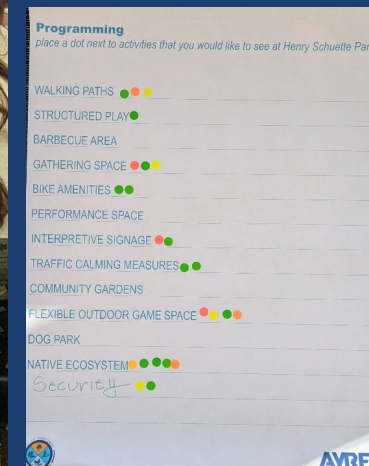
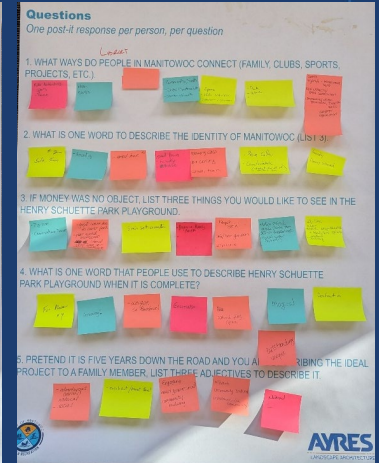

# Vision Session

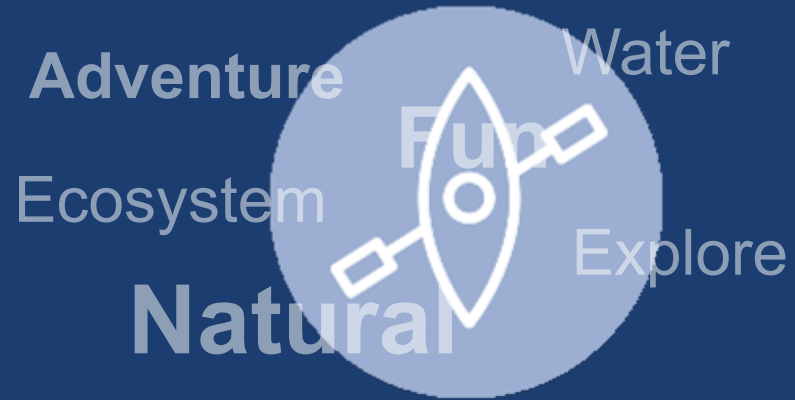

# Vision Statement



Henry Schuette Park Playground will...

leverage its unique location and local resources to create a fun, nature-focused adventure playground that serves all ages and abilities. The park will become a regional destination for community, and environmental education where you can play all day.

# Values



Natural: Provide environmental play and nature education for a multi-generational audience.



Connected: create physical, community, regional, and environmental connections.



Invested: Invest in the city while attracting people to the unique amenities of Manitowoc.



Ideals: Reflect the values of the community.



# Community Engagement

---



# Survey

## Q1 What best describes your connection to the City of Manitowoc?

Answered: 1,161 Skipped: 5

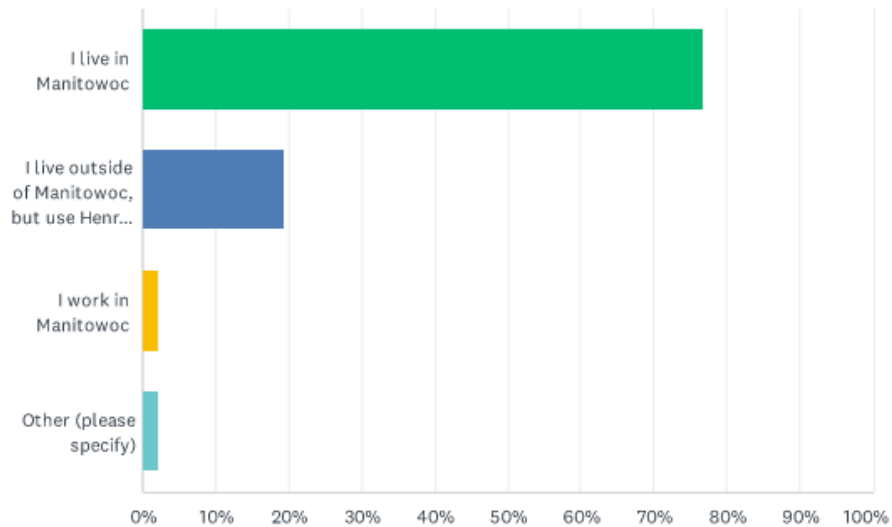

## Q2 What is your age?

Answered: 1,163 Skipped: 3

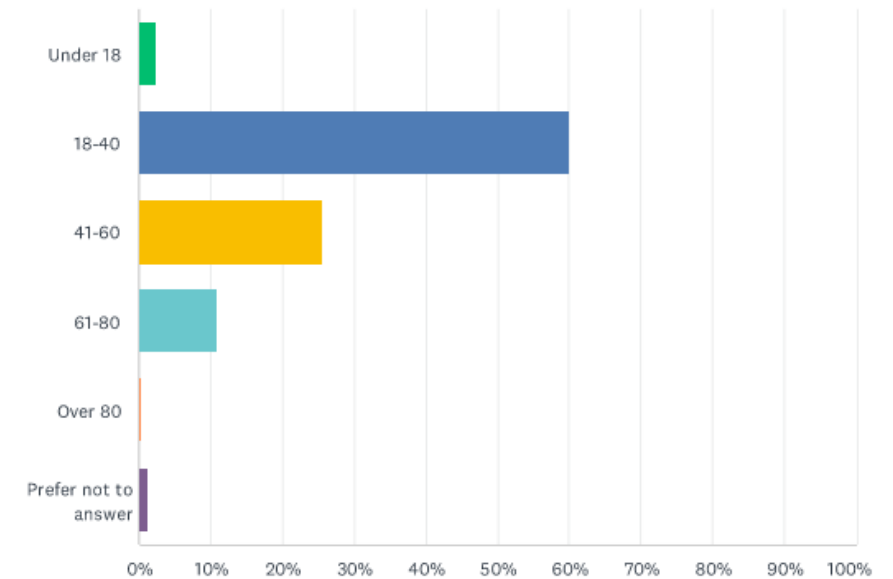

# Survey

## Q3 How often do you visit Henry Schuette Park?

Answered: 1,159 Skipped: 7

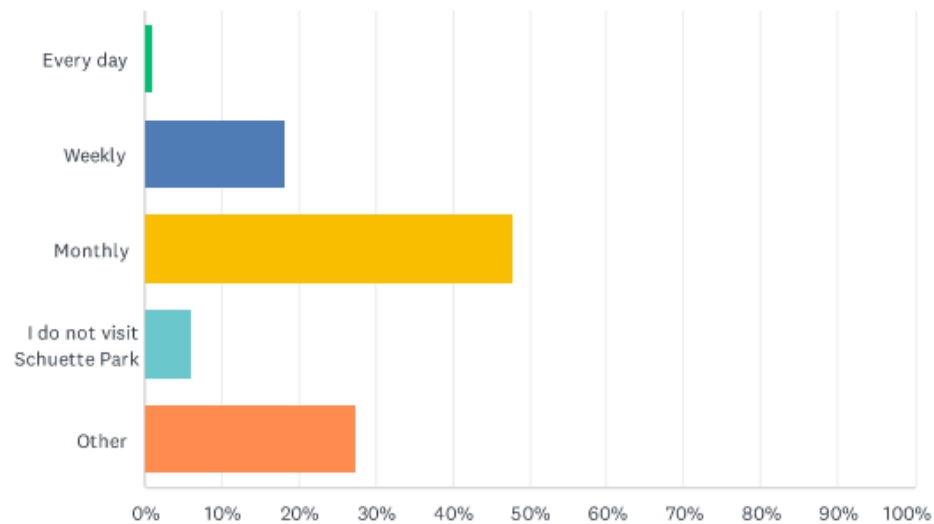

## Q4 Where do you live in relation to Henry Schuette Park?

Answered: 1,161 Skipped: 5

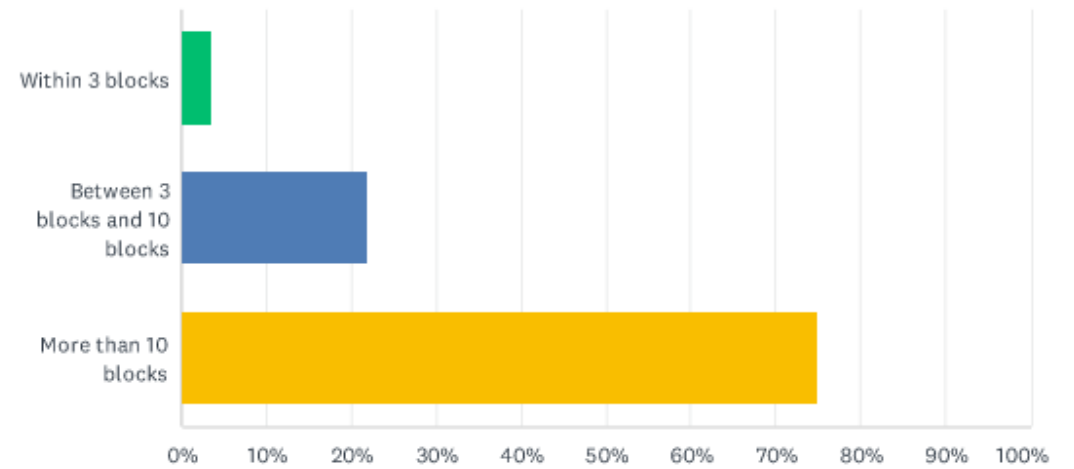

# Survey

## Q5 How do you typically get to Henry Schuette Park?

Answered: 1,162 Skipped: 4

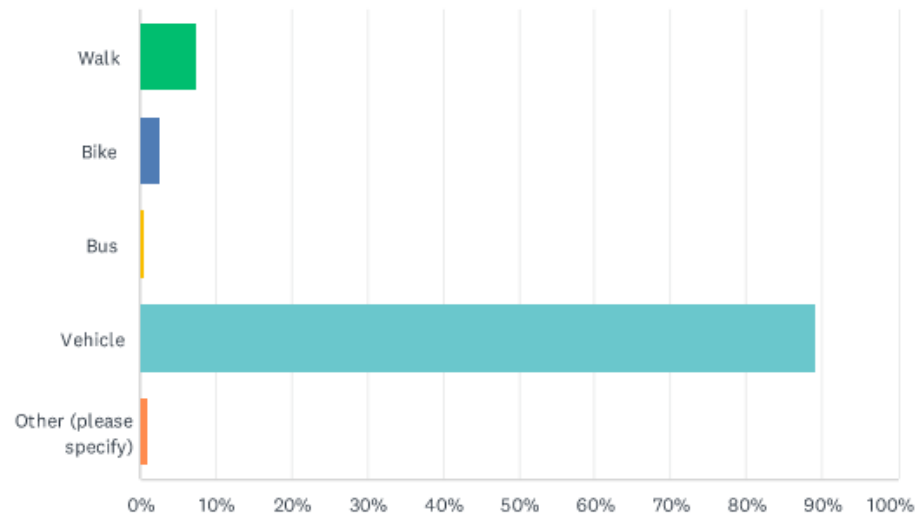

## Q6 Is there anything preventing you from visiting Henry Schuette Park? (select all that apply)

Answered: 1,133 Skipped: 33

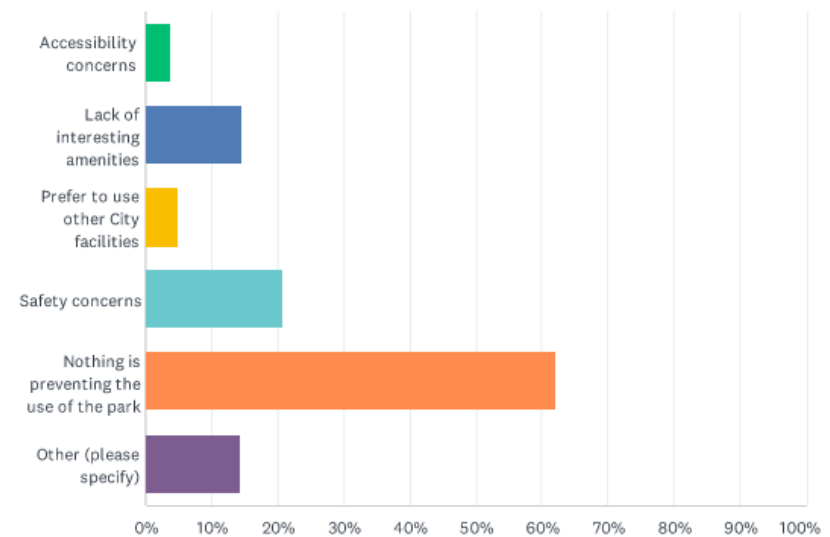

# Survey

## Q7 How safe do you feel when you are at Henry Schuette Park?

Answered: 1,157 Skipped: 9

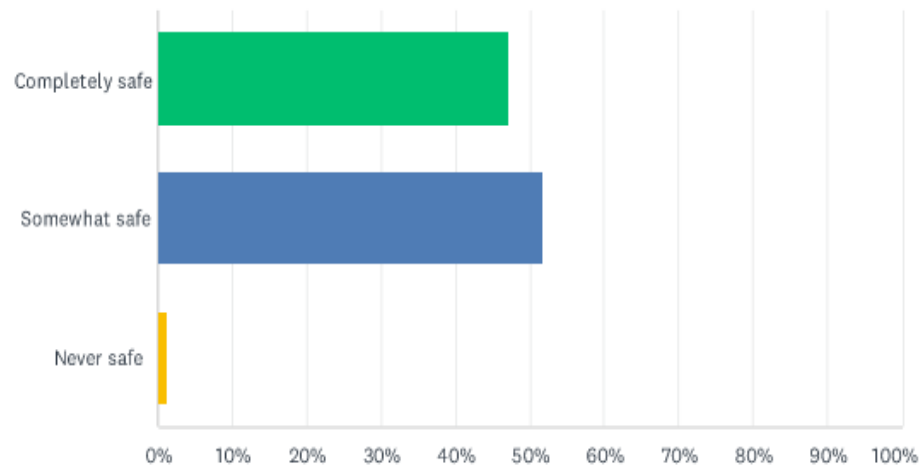

## Q8 What activities do you typically engage in when visiting Henry Schuette Park? (select all that apply)

Answered: 1,154 Skipped: 12

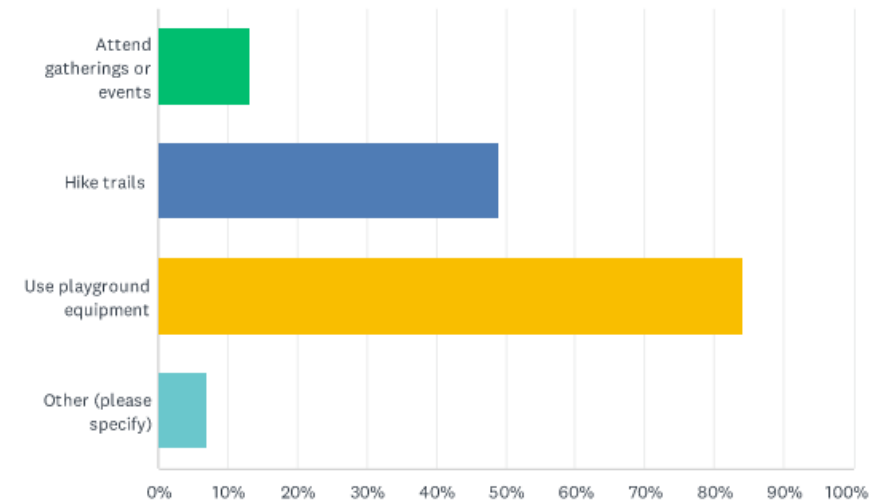

# Survey

What are the features that you like most about Henry Schuette Park

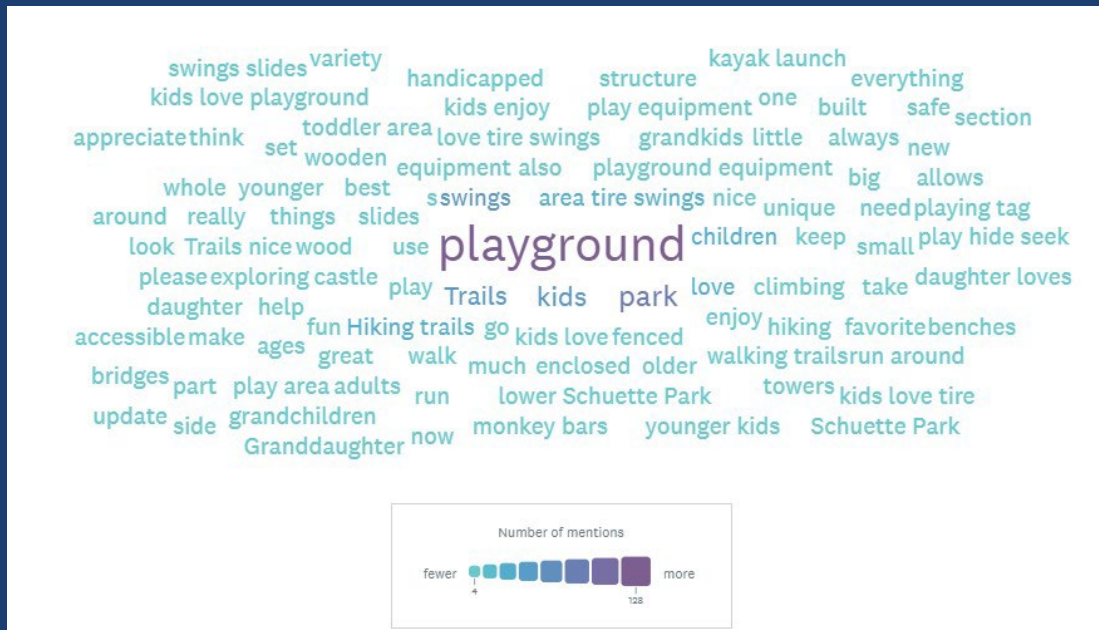

Park Amenities	<div></div>	34%	271
Playground Equipment	<div></div>	18%	139
Nature Trails	<div></div>	17%	133
Age-Appropriate Play Areas	<div></div>	11%	84
Park Maintenance	<div></div>	10%	81
Child Safety	<div></div>	5%	36
Accessibility	<div></div>	2%	15
Family Activities	<div></div>	2%	14
Playground Design	<div></div>	1%	11
Community Involvement	<div></div>	1%	6

# What can be improved in Henry Schuette Park to better serve our community in the future

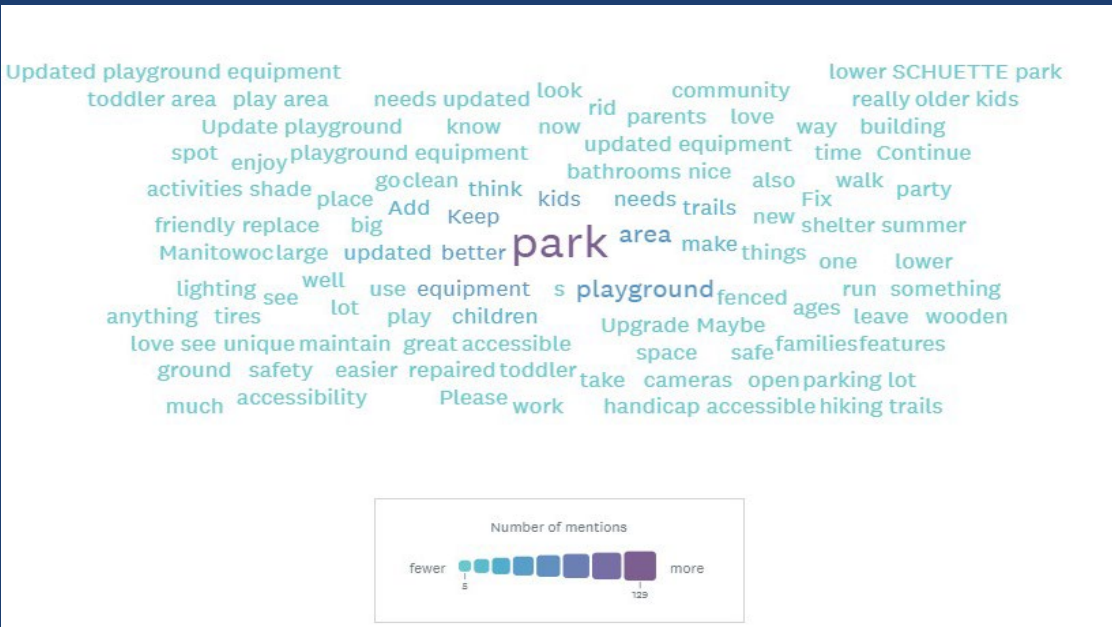

Family-friendly amenities	<div><div></div></div>	24%	174
Park cleanliness and upkeep	<div><div></div></div>	22%	155
Playground safety and maintenance	<div><div></div></div>	15%	109
Inclusive play spaces	<div><div></div></div>	11%	82
Playground equipment updates	<div><div></div></div>	9%	62
Nature trails and outdoor activities	<div><div></div></div>	6%	44
Modernization of park facilities	<div><div></div></div>	5%	33



# Survey

Q14 Which type of gathering space do you prefer?

Answered: 1,110 Skipped: 56

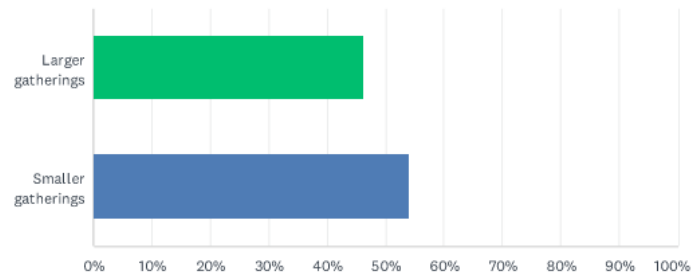

Q15 What shade structure style do you prefer?

Answered: 1,114 Skipped: 52

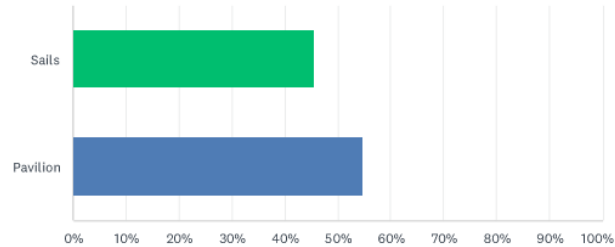

Q12 Which playground style do you prefer?

Answered: 1,099 Skipped: 67

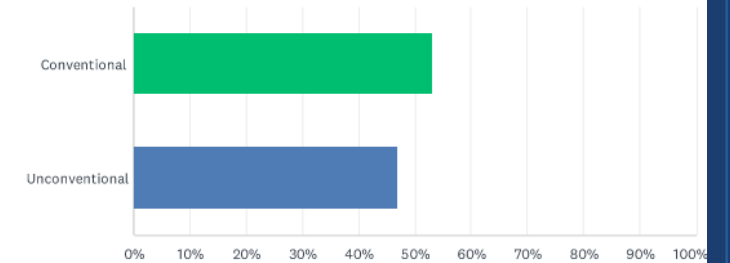

Q16 Which planting type do you prefer?

Answered: 1,141 Skipped: 25

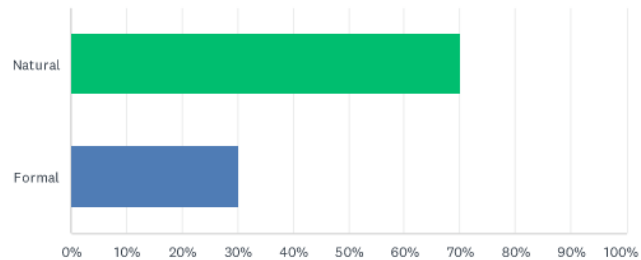

Q13 Which type of lawn activities do you prefer?

Answered: 1,099 Skipped: 67

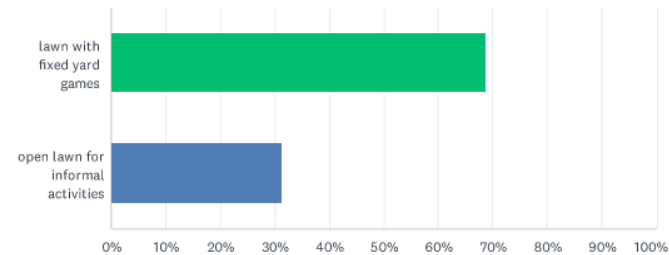

# Master Planning: Bike/Ped

Bicycle and Pedestrian Master Plan calls Schuette Park Playground as a destination, and it is connected though on-street paths in the short and medium-term projects

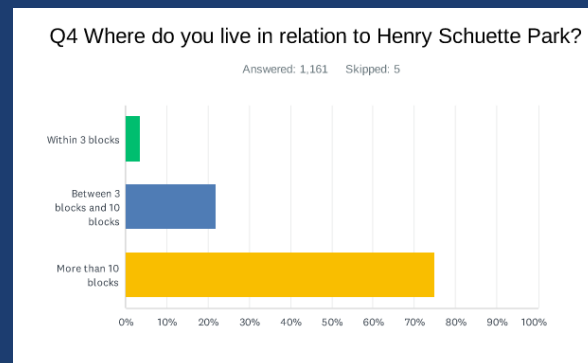
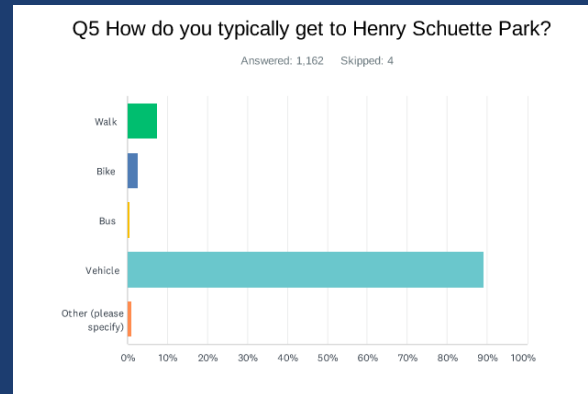
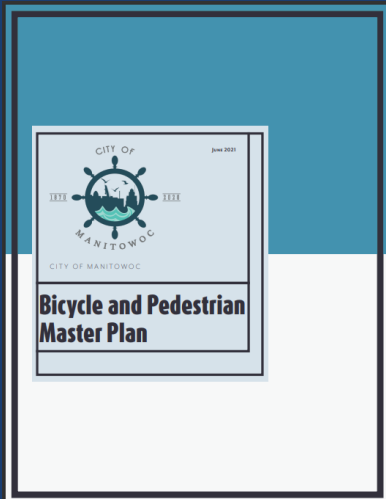

# Master Planning: Trails

Create a comprehensive network of trails between the Upper and Lower parks that include ecological restoration and educational interpretive signage

Park Amenities	<div></div>	34%	271
Playground Equipment	<div></div>	18%	139
Nature Trails	<div></div>	17%	133
Age-Appropriate Play Areas	<div></div>	11%	84
Park Maintenance	<div></div>	10%	81

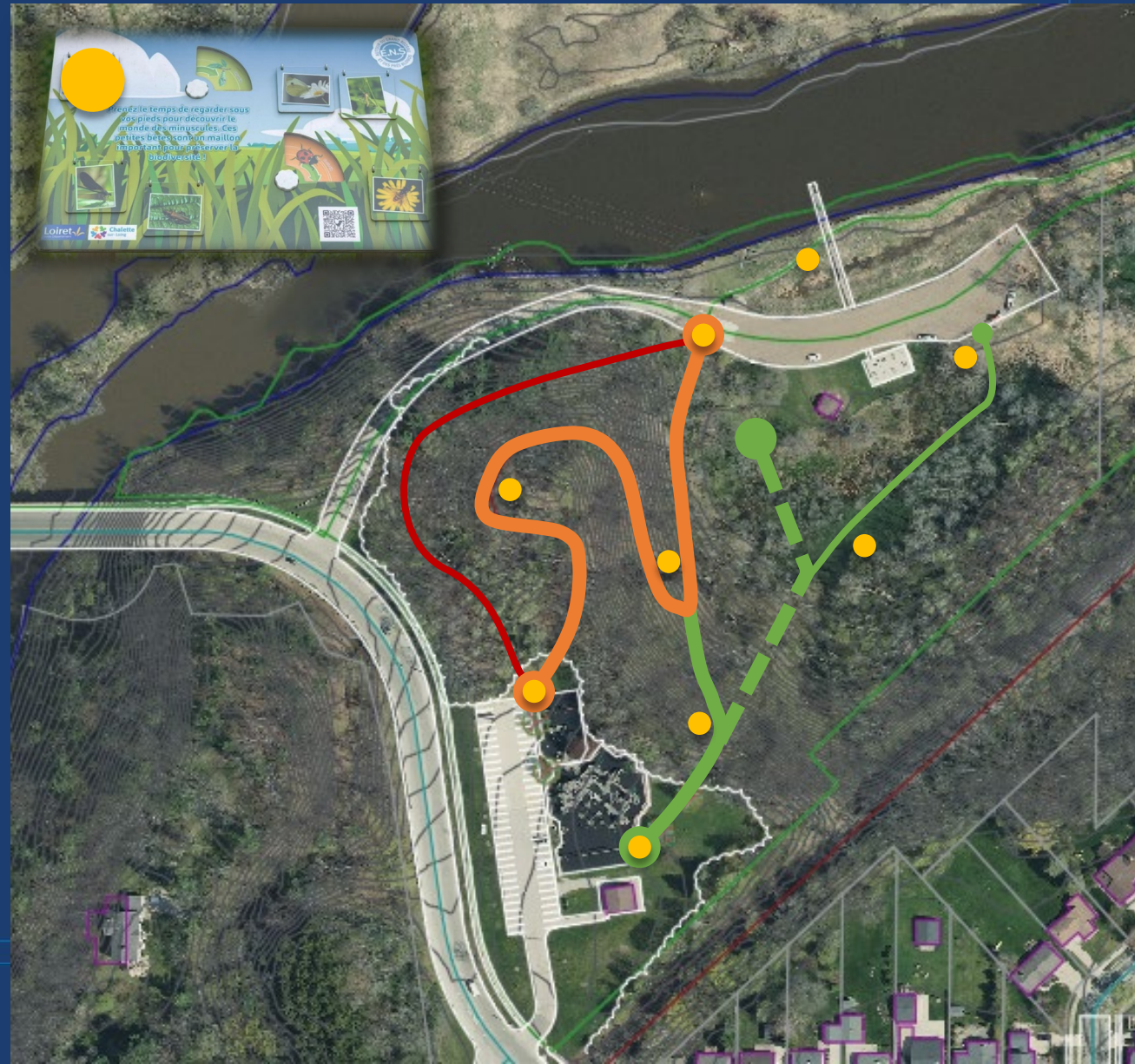



# Master Planning: Safety

Add physical traffic calming measures and narrow the main intersection. Add flashing DOT signage and speed limit signs to Broadway St.

Q7 How safe do you feel when you are at Henry Schuette Park?

Answered: 1,157   Skipped: 9

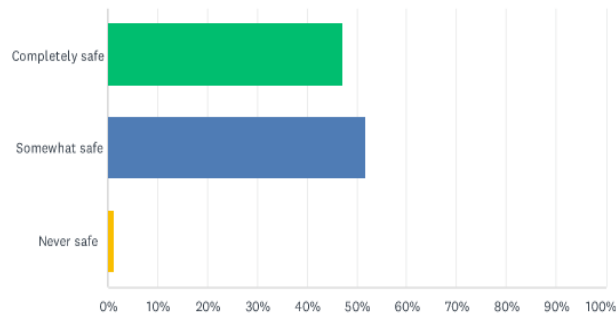



# Precedents

Precedent images are a way to narrow down and establish what types of materials and features resonate with the community. The preferred images influence the final design



# Precedents





# Precedents



# SITE PROGRAM

---



# Preliminary Program

## Natural:

- Nature-based 2-5 age playground
- Nature-based 5-12 age playground
- Flexible adult adventure playground
- Educational interpretive signs on nature walking paths

## Connected:

- Complete trail system
- Connect to Lower Schuette
- A community gathering place
- Flexible outdoor game space

## Invested:

- Year-round restroom
- Rentable spaces
- Drinking fountain
- Bike amenities
- Connections to neighborhoods and trails

## Ideals:

- Enclosure for playgrounds
- Traffic Safety
- ADA parking stalls + safe parking lot
- Safe routes to access the park



# CONCEPT





# CONCEPT

ADULT  
EXERCISE

TRAILHEAD TO  
LOWER SCHUETTE  
STAIR

P3

PLAYGROUND  
5-12

TRAILHEAD TO  
SCHUETTE TRAIL  
SYSTEM

LAWN

P1

GATHER

PLAYGROUND  
2-5

P2

NATURE ED.

BIKE  
STATION





# OVERALL





# ENTRY SEQUENCE







# ENVIRONMENTAL EDUCATION





# FLEXIBLE LAWN





# GATHERING AREA



# MAIN PAVILION







## (2) SECONDARY PAVILIONS



# PLAYGROUNDS

ADULT

5-12

2-5







# PLAYGROUND 2-5



# PLAYGROUND 2-5







# PLAYGROUND 5-12





# PLAYGROUND 5-12



# ADULT ZONE





# SQUARE FOOTAGES



## EXISTING

- 2-5: 4,350 SF
- 5-12: 13,850 SF
- **Total: 18,200 SF**



## PROPOSED

- 2-5: 3,500 SF
- 5-12: 6,150 SF
- Adult: 3,700 SF
- **Total: 13,350 SF**



# THANK YOU

---